



A WILO COMPANY

Marine Bronze Motorpump™

1 1/2 x 1 1/2 NPT 2 Pole 50-60 Hz 2900-3450 RPM
Self Priming Bilge and Fire Pump

Group - 68000
Model - 68716
AUGUST 28, 2017

Fire pump 40 GPM – 50 PSI

Bilge pump to 80 GPM

Used as a fire pump on commercial and military vessels. High pressure and high volume. Provides seawater for shipboard applications. Install with a suitable suction strainer – max. 3/8-inch openings

As a fire pump, up to 50 PSI from a 30 GPM nozzle.

As a bilge pump will self-prime up to 20 feet. Capacity is 80 gallons per minute at a 5-foot suction lift.

Pump

- Heavy-duty All-Bronze Seawater pump
- Shaft is bronze alloy 954
- Designed for Seawater use. Impeller key and impeller lock nut are type 316 stainless steel. Precision machined to close tolerances for consistent performance
- Hardware is stainless steel
- Enclosed impeller for high efficiency
- Designed for continuous 24 / 7 duty

Shaft Seal

- Buna rubber parts, ceramic stationary element, carbon rotating element, stainless steel spring and metal components

Motor – 2 Pole

- Totally enclosed fan cooled IP-44 motors meet marine, European, and Coast Guard ignition protected requirements.
- Sealed ball bearings
- Single-phase capacitor start
50 Hz – 110-220 Volt
60 Hz – 115-230-volt
- Three-phase –nine lead dual voltage
50- 190/380 Volt
60 - 230/460-volt
- Three-phase motors designed for dual frequency
50 Hz or 60 Hz are available.



68716

To Prime

- Remove prime plug
- Fill case with water, place suction line under water

Prime Period

- Close prime plug
- Install vent line in discharge to permit air to escape.
- Vent line must not be under water
- Start motor. Air should be escaping from vent line
- It can take up to 90 seconds to evacuate all the air from suction line.
- Do not remove suction line from water
- If the suction line is removed from water during the prime period, the process must be started over.

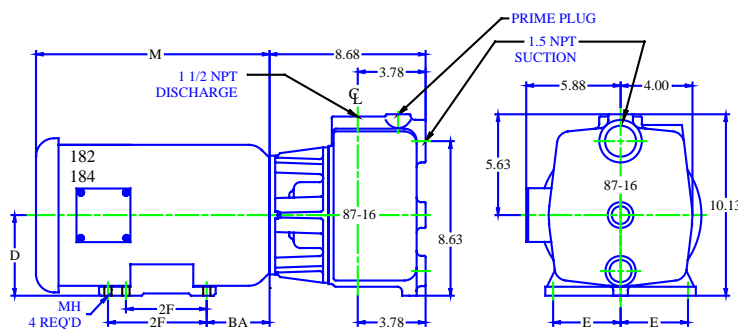

Motor Dimensions							
HP	Frame	D	E	2F	BA	M	MH
3	182	4.50	3.75	4.50	3.50	13.12	.41

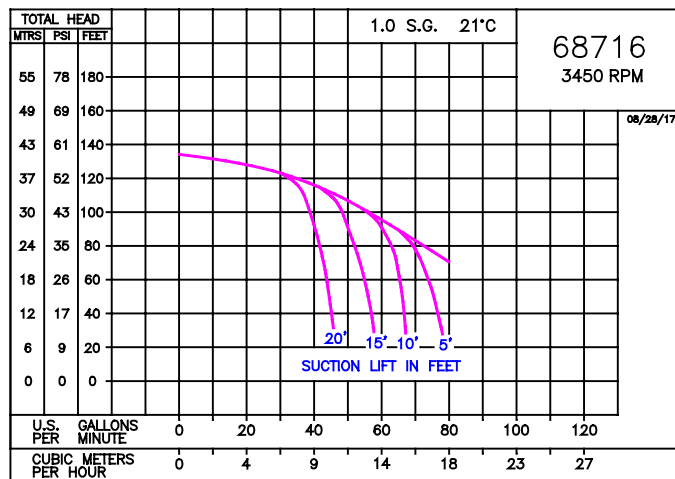
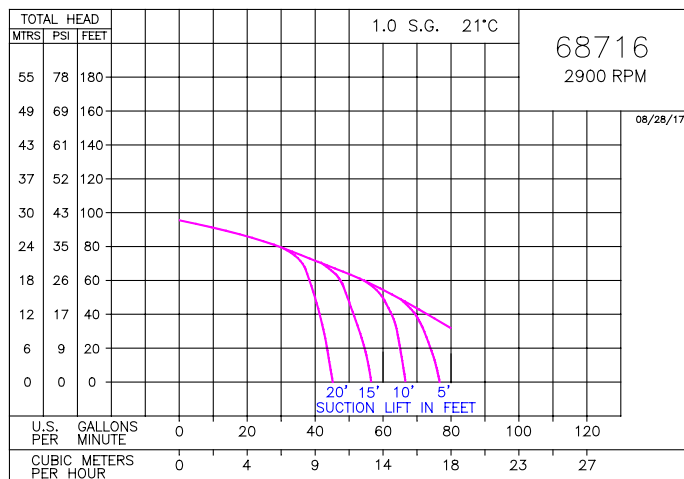

Pump 68716 • Style S • Bronze • JM Frame

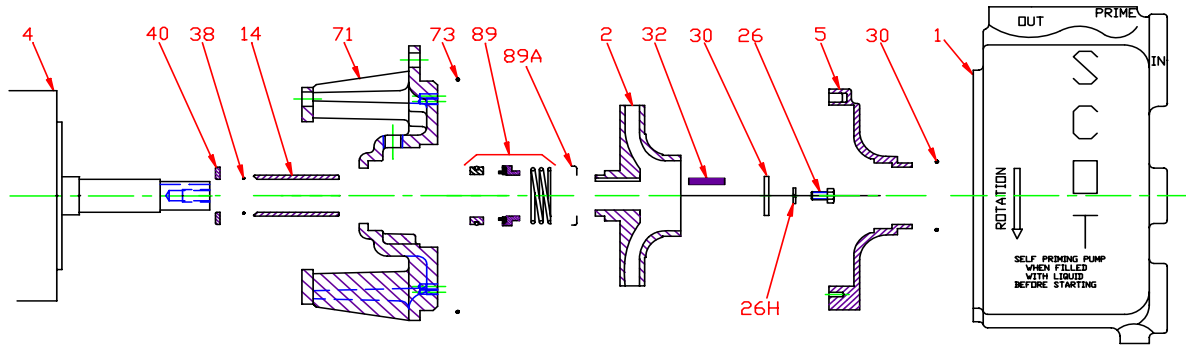

KEY NO.	PART NAME	PUMP NO. 68716
1	CASE, BRONZE, 1.5 x 1.5 NPT	130.000.323
2	IMPELLER, BRONZE, 7/8" KEYED, ENCLOSED: 5.50	131.000.745.550
4	MOTOR, JM140/180, CARBON STEEL SHAFT	See Chart
5	DIFFUSER, BRONZE	131.000.746
14	SHAFT SLEEVE, BRONZE	189.001.215
26	IMPELLER RETAINER, STN, SCREW	105.000.233
26H	IMPELLER RETAINER, STN, LOCKWASHER	104.000.130
30	IMPELLER RETAINER, STN, WASHER	104.000.114
32	KEY, STAINLESS	102.000.102
38	O-RING, SHAFT, BUNA	116.000.117
40	FLINGER, BRONZE	189.001.216
71	ADAPTER, BRONZE, JM140/180	132.000.382
73*	GASKET, CASE, BUNA	116.000.184
89*	1 1/2" SEAL:	
	BN-CARB/CM	101.000.168
89A	SEAL RETAINER	104.000.202
--	° REPAIR KITS:	
	BN-CARB/CM SEAL	189.001.142
* DENOTES COMPONENTS INCLUDED IN KIT.		

E68716-S

K17

P68716-S

Pump 68716 • Style X • Bronze • JM Frame

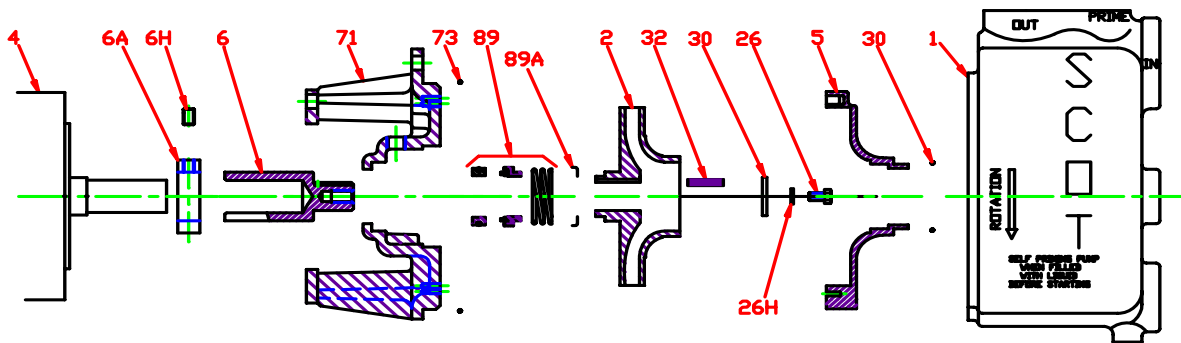

KEY NO.	PART NAME	PUMP NO. 68716
1	CASE, BRONZE, 1.5 x 1.5 NPT	130.000.323
2	IMPELLER, BRONZE, 7/8" KEYED, ENCLOSED: 5.50	131.000.745.550
4	MOTOR, JM140/180, CARBON STEEL SHAFT	See Chart
5	DIFFUSER, BRONZE	131.000.746
6	SHAFT, BRONZE	189.001.171
6A	COLLAR, BRONZE	189.001.170
6H	SET SCREW, STAINLESS	189.001.161
26	IMPELLER RETAINER, STN, SCREW	105.000.233
26H	IMPELLER RETAINER, STN, LOCKWASHER	104.000.130
30	IMPELLER RETAINER, STN, WASHER	104.000.114
32	KEY, STAINLESS	102.000.102
71	ADAPTER, BRONZE, JM140/180	132.000.382
73*	GASKET, CASE, BUNA	116.000.184
89*	1 1/2" SEAL:	
	BN-CARB/CM	101.000.168
89A	SEAL RETAINER	104.000.202
--	° REPAIR KITS:	
	BN-CARB/CM SEAL	189.001.142
* DENOTES COMPONENTS INCLUDED IN KIT.		

E68716-X

K17

P68716-X

Pump 68716 • Style S • Bronze • JM Frame

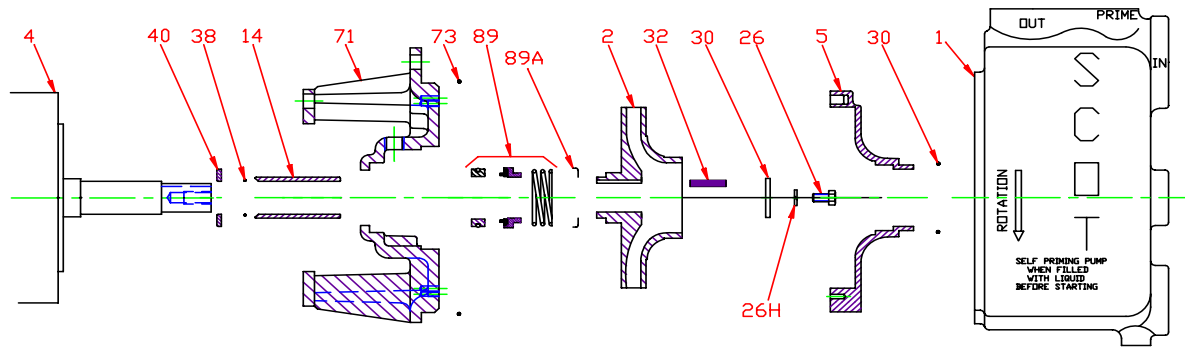

CONSTRUCTION OPTIONS		
KEY	PART NAME	ALL BRONZE
1	Case	Bronze
2	Impeller	Bronze
5	Diffuser	Bronze
6	Stub Shaft	Bronze
14	Shaft Sleeve	Bronze
26	Imp. Retainer Screw	Stainless
26H	Imp. Retainer Lockwasher	Stainless
30	Imp. Retainer Washer	Stainless
32	Key	Stainless
38	Shaft O-Ring	BUNA
40	Flinger	Bronze
71	Adapter	Bronze
73	Gasket, Case	BUNA
89	Mechanical Seal, Type 21 BN-CARB/CM	Standard
89A	Seal Retainer	Stainless

E68716JM

K17

C68716-S