

# HTO 300



## 3" x 2 1/2" Centrifugal Pump

The HTO 300 is a unique centrifugal pump (patented) designed for high temperature applications without requiring external flushes or jacket cooling. Capacities to 500 GPM ... heads to 190 FT TDH. Temperatures to 650°F.

**3, 5, 7 1/2, 10,  
15, & 20 HP**

FLOWS UP TO 500 GPM  
PRESSURES UP TO 190 FEET HEAD



## WARNING

Consult factory for applications approval and usage. Serious injury or death caused by burns from hot oil may occur.



**MP PUMPS, INC.**

TECUMSEH PRODUCTS COMPANY

34800 BENNETT DRIVE • FRASER, MI 48026-1686  
(810) 293-8240 • FAX (810) 293-8469  
800 563-8006

*Available in:*

**Ductile Iron  
Construction**

# HTO 300

For application in the plastics, chemical, food, and processing industries which require pumping of high temperature fluids.

The HTO 300 utilizes an isolated seal chamber, effectively cooled by a fan clamp which couples the unit to the shaft of a standard 213TC and 215TC motor.

- Standard carbon/ceramic mechanical seal with viton elastomers, stainless steel fitted.
- Carbon graphite isolator bushing separates mechanical seal from high temperature fluids.
- Stainless steel drive sleeve and ductile iron drive clamp couples pump unit to motor.
- Vertical or horizontal discharge.
- With or without electric motor.

## HTO 300 PUMP CROSS-SECTION AND DETAIL

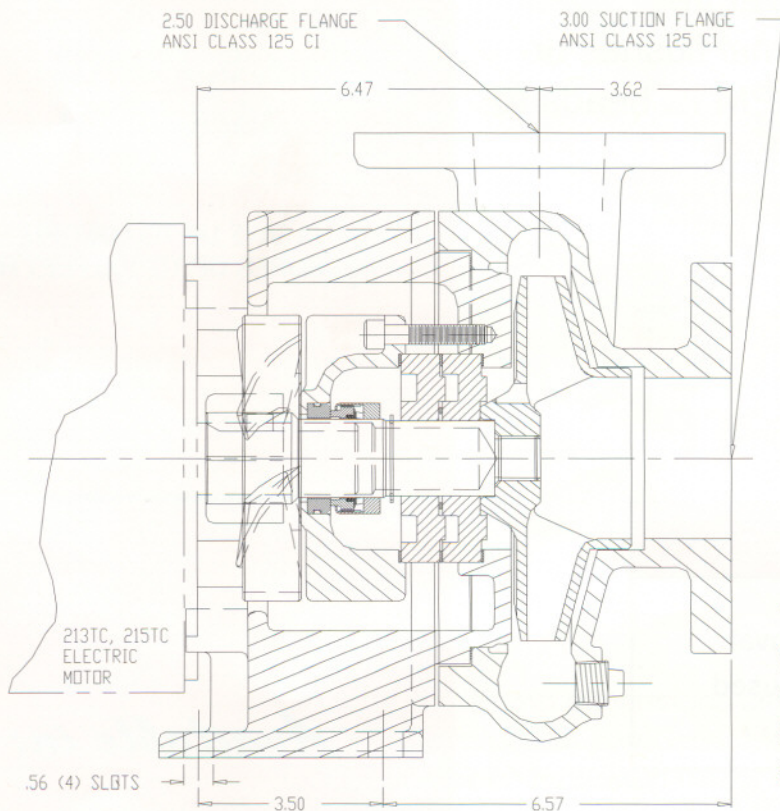

DET.	DESCRIPTION
1	IMPELLER - CAST IRON
2	SEAL ASSEMBLY
3	HEX JAM NUT - S.S.
4	COOLING FAN CLAMP
5	CAPSCREW
6	GASKET
7	CAPSCREW
8	O-RING
9	ADAPTER - DUCTILE IRON
10	ISOLATOR - CARBON GRAPHITE
11	DRIVE SLEEVE - STAINLESS STEEL
12	SEAL HOUSING - DUCTILE IRON
13	LIP SEAL
14	HOUSING - DUCTILE IRON
15	GASKET
16	PIPE PLUG S.S.
17	LOCKWASHER S.S.
18	CAPSCREW CPS

The HTO 300 provides a self-aligning compact installation with an integral air-cooled seal chamber. Precautions must be exercised in the installation to assure safe operation.

# HTO 300 PERFORMANCE CHARACTERISTICS

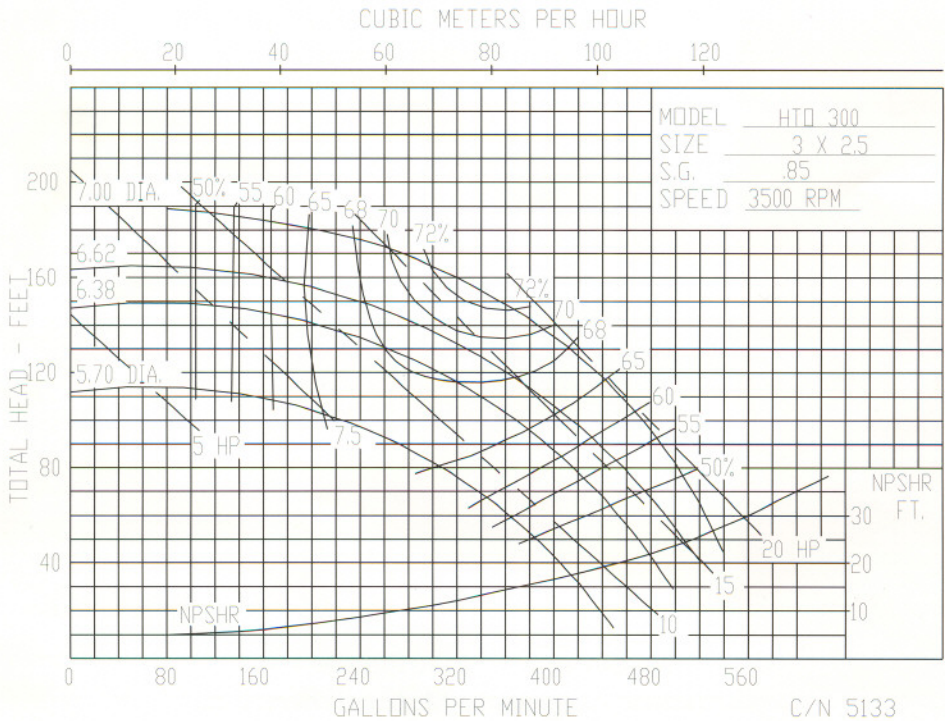
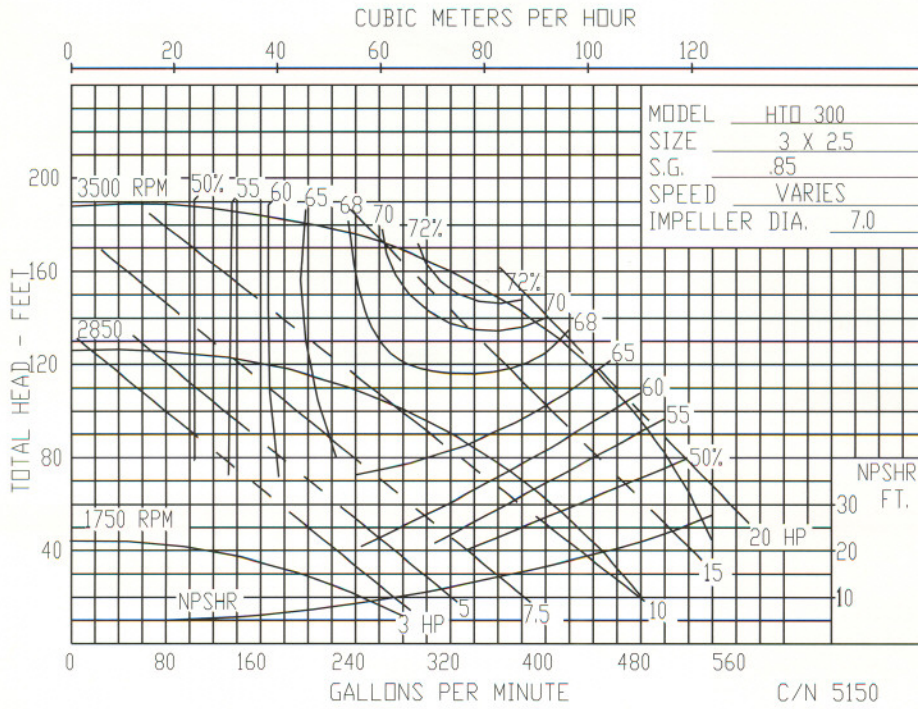

Horsepower requirements based upon 0.85 specific gravity.  
 Calculations can be applied for fluids of other specific gravities.

Maximum operating temperature is 650°F.  
 Maximum working pressure is 150 PSI.

# HTO 300

For application in the plastics, chemical, food, and processing industries which require pumping of high temperature fluids.

The HTO 300 utilizes an isolated seal chamber, effectively cooled by a fan clamp which couples the unit to the shaft of a standard 213TC and 215TC motor.

- Standard carbon/ceramic mechanical seal with viton elastomers, stainless steel fitted.
- Carbon graphite isolator bushing separates mechanical seal from high temperature fluids.
- Stainless steel drive sleeve and ductile iron drive clamp couples pump unit to motor.
- Vertical or horizontal discharge.
- With or without electric motor.

## HTO 300 PUMP CROSS-SECTION AND DETAIL

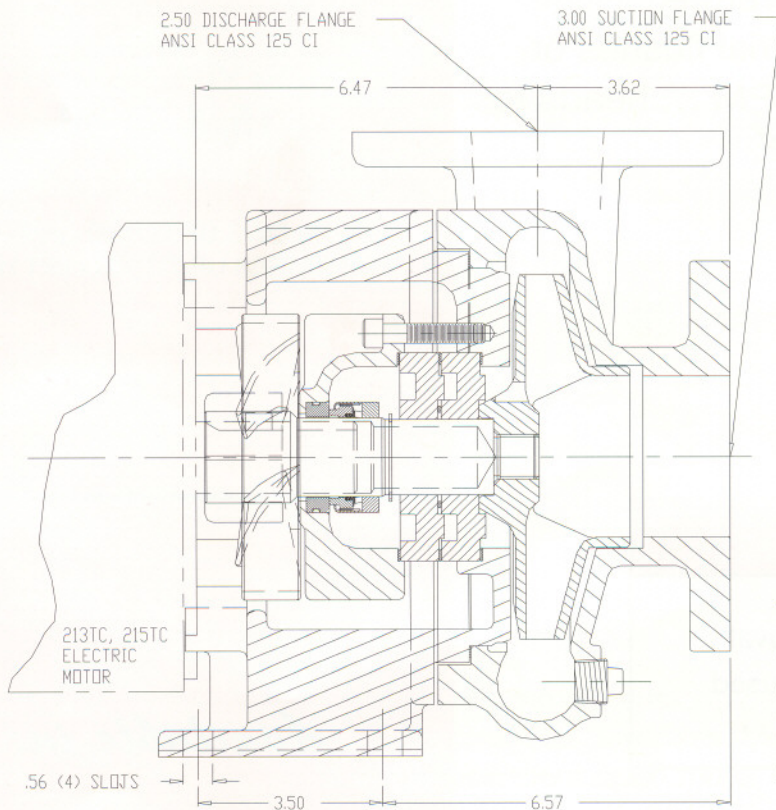

DET.	DESCRIPTION
1	IMPELLER – CAST IRON
2	SEAL ASSEMBLY
3	HEX JAM NUT – S.S.
4	COOLING FAN CLAMP
5	CAPSCREW
6	GASKET
7	CAPSCREW
8	O-RING
9	ADAPTER – DUCTILE IRON
10	ISOLATOR – CARBON GRAPHITE
11	DRIVE SLEEVE – STAINLESS STEEL
12	SEAL HOUSING – DUCTILE IRON
13	LIP SEAL
14	HOUSING – DUCTILE IRON
15	GASKET
16	PIPE PLUG S.S.
17	LOCKWASHER S.S.
18	CAPSCREW CPS

The HTO 300 provides a self-aligning compact installation with an integral air-cooled seal chamber. Precautions must be exercised in the installation to assure safe operation.