

### EXPLODED VIEW

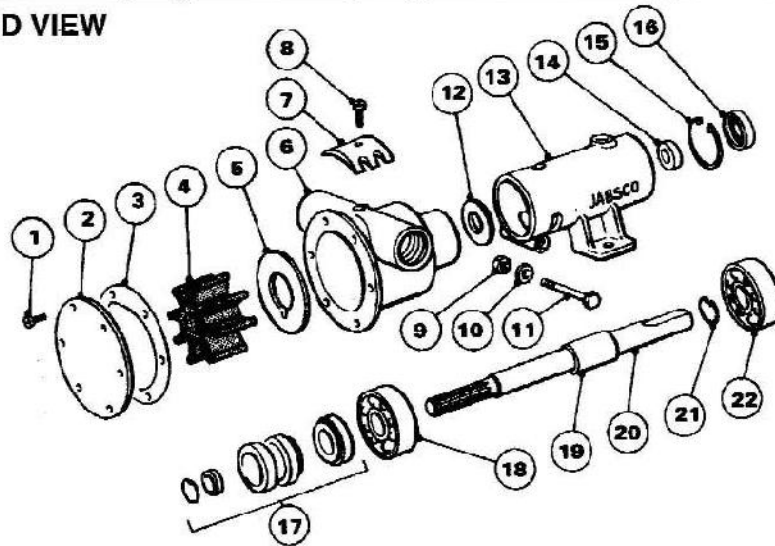

PARTS LIST			Model 10550	Model 9710
Key	Description	Qty	Part No	Part No
1	Endcover Screw*	6	SP1002-02	SP1003-09
2	Endcover	1	3992	3993
3	Gasket*	1	3298	890
4	Impeller*	1	1210-0001B	17937-0001B
5	Wearplate	1	7883	4156
6	Body	1	10554-200	10329-200
7	Cam	1	490	934
8	Cam Screw	1	SP1003-01	SP1004-09
9	Nut	1	SP1105-03	SP1105-03
10	Washer	1	SP1502-06	SP1602-06
11	Bolt	1	SP1095-09	SP1095-09
12	Slinger	1	3286	3180
13	Bearing Housing	1	10557	10330
14	Inner Bearing Seal	1	SP2701-21	SP2701-21
15	Retaining Ring	1	SP1700-248	SP1701-185
16	Outer Bearing Seal	1	SP2701-15	SP2700-47
17	Seal Assembly*	1	22617-0010	22617-0010
18	Ball Bearing	1	SP2601-39	SP2600-38
19	Bearing Spacer	1	9908	-
20	Shaft	1	10417	9717
21	Retaining Ring	1	SP1700-249	-
22	Ball Bearing	1	SP2601-39	SP2600-38
23	Spine Seal	1	4345	4345

**MODEL 10550-200**  
Service Kit No SK238  
Contains Parts marked\*

**Options**  
High Pressure  
Neoprene Impeller Part No 3085-0001B  
Nitrile Impeller Part No 121J-0003B  
1/2 Cam Part No 10336  
1/2 Cam Screw Part No SP1003-09

**MODEL 9710-200**  
Service Kit No SK 229  
Contains Parts marked\*

**Options:-**  
High Pressure  
Neoprene Impeller Part No 5915-0001B  
Nitrile Impeller Part No 17937-0003B  
1/2 Cam Part No 2431  
1/2 Cam Screw Part No SP1004-10  
2/3 Cam Part No 3255  
2/3 Cam Screw Part No SP1004-10

### SERVICE INSTRUCTIONS

**Dis-Assembly** Inspect all parts for wear or damage and replace if necessary

1. Remove endcover screws, endcover and gasket.
2. Remove impeller.
3. Loosen cam screw, remove cam, (clean off any old jointing compound).
4. Remove wearplate.
5. Remove seal retaining ring from shaft.
6. Remove pump body from bearing housing by removing holding bolt.
7. Remove spacer and seal assembly.
8. Slide slinger off shaft.
9. Insert screwdriver between OD of outer bearing seal and bearing housing bore and pry out seal.
10. Remove bearing to housing retaining ring.
11. Press shaft on impeller drive end to remove shaft and bearing assembly from pump. Heating outside of body will ease dis-assembly. Remove inner bearing seal. Remove shaft retaining ring model 10550.
12. Support bearing inner race and press shaft through bearing. Repeat procedure for other bearing.

### Assembly

1. Lubricate inner bearing seal with grease and press into body bearing seal bore with lip facing away from bearing bore.
2. Support inner race of bearing and press shaft through bearing until located against shoulder on shaft. Repeat operation for other bearing.
3. Locate slinger in drain area.
4. Press shaft and bearing assembly into bearing housing, guide slinger onto shaft until located in housing.
5. Fit bearing to body retaining ring.
6. Lubricate outer bearing seal with grease and press into bearing bore until it is flush with the body, (spring facing outwards).
7. Fit pump body, secure with bolt, washer and nut.
8. Fit seal seat and cup rubber, with seal seat facing towards impeller bore.
9. Fit seal with carbon face towards face of seal seat and replace spacer.
10. Fit shaft retaining ring onto shaft, (10550).
11. Install wearplate in body bore aligning slot in wearplate with dowel pin in body.
12. Coat cam screw threads, and top of cam with a non coating jointing compound. Install in body.
13. Lubricate impeller bore with a light coat of good quality water pump grease and start impeller into bore with a rotary motion until splines engage, then push into bore.
14. Replace gasket, endcover and secure with endcover screws.

### INSTALLATION DRAWING MODEL 10550-200

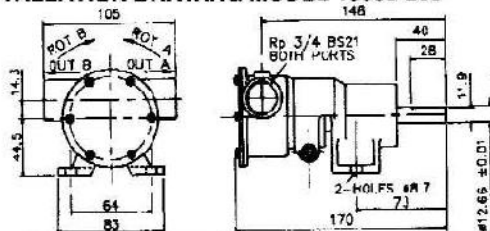

### INSTALLATION DRAWING MODEL 9710-200

