

MODEL 6990

Special Flange-Mounted Model (Dual)
for Chrysler Marine Engine
IMPERIAL "V" SPECIAL & "V-275" ENGINES

FEATURES

BODY
BRONZE CONSTRUCTION

IMPELLER
SPECIAL NEOPRENE COMPOUND

SHAFT
STAINLESS STEEL

SHAFT SEAL
MECHANICAL LIP TYPE

BEARINGS
SEALED BALL BEARINGS

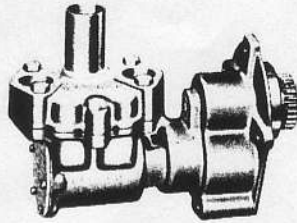

Approx. Wt. 12 lbs.

INSTALLATION

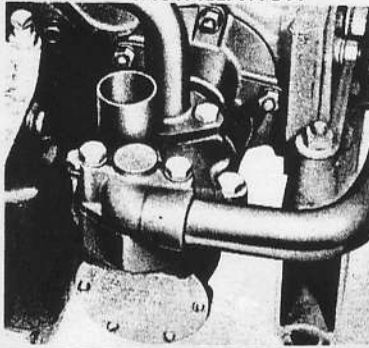

EXPLODED VIEW

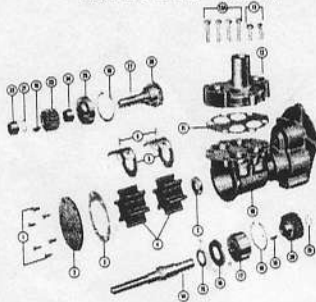

PARTS LIST

STANDARD MODEL 6990 -

KEY	DESCRIPTION	QTY.	PART NUMBER
1	Screw—End Cover	6	SP-1002-02
2	End Cover	1	6995
3	Gasket	1	3298
4	Impeller	2	8566-08
5	Cam & Wearplate Assm.	2	7607
6	Screw—Cam	2	SP-1003-01
7	Seal—Shaft—	1	SP-2700-06
7a	"O" Ring (Not Shown)	1	SP-2000-21
10	Body	1	6994
11	Manifold Gasket	1	6748
12	Manifold Assm.	1	7835
13	Hex Hd. Bolt	2	SP-1095-26
13a	Hex Hd. Bolt	4	SP-1095-43
14	Shaft	1	6997
15	Slinger	1	3286
16	Bearing Seal	1	913
17	Ball Bearing	1	SP-2600-06
18	Retaining Ring	2	SP-1701-185
19	Key	2	SP-1402-06
20	Driven Gear	1	6973
21	Retaining Ring	2	SP-1700-62
22	Bearing	1	SP-2004-04
23	Drive Gear	1	6972
24	Bearing	1	SP-2004-03
25	Body Plug	1	6996
26	Drive Gear	1	3296
27	Drive Shaft	1	6998

Imperial "V" Special
Chrysler Series M45S-3

ENGINE NAME AND MODEL

M-45SP-3
Imperial V-275

SPECIAL MODIFICATIONS

Model	DESCRIPTION
6990-01	Without Manifold

HEAD CAPACITY TABLE

MODEL 6990

TOTAL HEAD		1160 RPM	1750 RPM	2450 RPM	3600 RPM
Lbs. per Sq. In.	Ft. of Water	GPM	GPM	GPM	GPM
4.3	10	11.5	17.0	24.0	35.0
8.7	20	11.0	16.5	23.5	34.5
17.3	40	9.5	15.0	21.0	31.5
26	60	—	11.5	17.5	26.5

OPERATING INSTRUCTIONS

- INSTALLATION**—Care should be taken that the intake and discharge piping of the engine corresponds with the proper port markings on the pump. This will require a slight modification of the discharge ports. See mounting installation on reverse side.
- DRIVE**—Direct.
- SPEEDS**—Pump is designed to operate through the entire engine range.
- SELF-PRIMING**—Unit will operate satisfactorily at low as well as high speeds. For vertical suction lift requirements at maximum of 15 ft., a minimum of 800 RPM is required. Pump will produce suction lift up to 24 ft. when primed. Be sure suction lines are air tight.
- RUNNING DRY**—Unit depends on liquid pumped for lubrication. **DO NOT RUN DRY** for more than 30 seconds. Lack of liquid may burn the impeller.
- PRESSURES**—For continuous operation, pressure should not exceed 30 pounds for the standard Model 6990.
- TEMPERATURES**—Impeller specially compounded to operate through the range of 45°-180° F.
- FREEZING WEATHER**—Drain unit by loosening end cover plate. For closed systems, use only Atlas "Permaguard" or Du Pont "Zerex" anti-freeze compounds. Do not use petroleum based anti-freeze compounds.
- IMPELLER REPLACEMENT**—Remove end cover. Withdraw impeller by grasping impeller hub with pliers. Remove rear impeller in same manner after first removing front cam and wear plate assembly.
- GASKET REPLACEMENT**—Always use standard pump part. A thicker gasket will reduce priming ability. A thinner gasket will cause impeller binding.
- CAM REPLACEMENT**—Coat top surface of new cams and cam screw threads with Permatex #1 or equivalent sealing compound before installing.
- SPARE PARTS**—Avoid costly shut downs by always having a JABSCO Service Kit on hand #8858

WARRANTY: All products of the company are sold and all services of the company are offered subject to the company's warranty and terms and conditions of sale, copies of which will be furnished upon request.

JABSCO PRODUCTS ITT

Marine and Recreation Components Division
International Telephone and Telegraph Corporation
1485 Dale Way, Costa Mesa, California 92626

Telephone: (714) 545-8251