

PARTM

TWO POSITION
SEWAGE VALVE

MODEL 45510-0000

PRODUCT DATA

FEATURES

- Corrosion — Resistant ABS and Stainless Steel Construction
- Ideal for Marine Sewage and Bilge Pumpout Systems
- Full Port Openings
- Easy Throw Handle can be Fitted with Remote Control Cable

SPECIFICATIONS

Ports:	1½ I.D. Hose
Body Material:	ABS
Shipping Weight:	1.1 LB, .50 KG
Mounting:	No. 10 Screw (4)

MAINTENANCE

If the "Y" valve becomes damaged or clogged with debris during service, it will be necessary to disassemble the unit. Empty all hoses and the Y valve of waste liquids and thoroughly flush the system with clean water. Re-flush the system with a water and bacteriacide mixture and flush again with clean water.

Remove all hoses from the "Y" valve and remove the Y valve to an area where it can be conveniently disassembled. Remove the 4 screws located on the face plate. Remove face plate and shaft/handle assembly from body. Remove all debris from the valve and inspect for damaged components.

If any parts of the shaft/handle, or port seal assembly need to be replaced, the shaft/handle assembly must be disassembled. **DO NOT REMOVE THE RETAINER RING AT THE SPRING END OF THE SHAFT.** Remove the retaining ring at the handle end of the shaft. SLIDE the handle and washers off the shaft and slide shaft and swivel block out of the bore in the face plate. Replace all damaged parts and reassemble items on the shaft. The spring must be compressed to allow the retainer ring to snap into the slot on the shaft. Reassemble the Y valve and re-install in the waste system. **CHECK SYSTEM FOR LEAKS.**

INSTALLATIONS

Lay out the system that the "Y" valve will be installed in so that all hoses can be installed without sharp bends, kinks or loops that trap fluids. After choosing a convenient, accessible location for the "Y" valve, (be sure that there is adequate room to swing the selector lever). Mark locations for mounting screw holes. Be sure to choose a mounting location which is as flat as possible to prevent damage to the "Y" valve from mounting on uneven surfaces. Fasten the "Y" valve using #10 stainless steel fasteners. Attach inlet and outlet hoses to the appropriate spigots and secure with stainless steel band clamps.

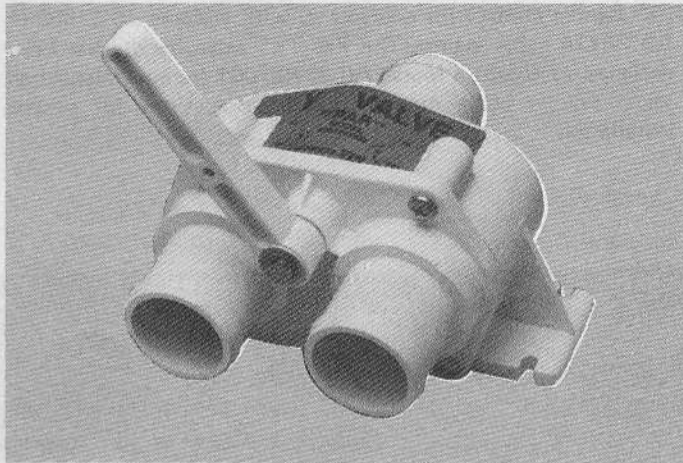

APPLICATION

The PAR "Y" valve was designed for installation in on-board sewage handling systems and bilge evacuation systems.

SEWERAGE SYSTEMS: Recent U.S. Coast Guard Marine Sanitation Regulations allow the boat operator to discharge untreated human waste when outside the 3 mile coastal limit. When the PAR "Y" valve is installed in the holding tank discharge line (diagram 1) it allows the operator to choose between pump out through a deck fitting or directly through the seacock.

IT IS IMPORTANT TO NOTE THAT IT IS ILLEGAL TO DISCHARGE SEWAGE EFFLUENT THAT IS NOT TREATED TO U. S. COAST GUARD STANDARDS WITHIN THE 3 MILE COASTAL LIMIT. IT IS NOT ILLEGAL TO HAVE A SYSTEM THAT ALLOWS OVERBOARD DISCHARGE OF UNTREATED SEWAGE INSTALLED ON BOARD A BOAT, AS LONG AS OVERBOARD SYSTEM IS NOT USED WITHIN THE 3 MILE COASTAL LIMIT.

When the "Y" valve is installed in the marine toilet discharge line (diagram 2) it allows the operator to choose between storing the toilet discharge effluent in the holding tank, or discharging directly overboard (when legal).

BILGE SYSTEMS: For boats with 2 separate bilge areas, the "Y" valve allows the operator to pump out either bilge section with only one pump. By simply selecting the appropriate valve selector lever either of the 2 bilges can be evacuated. (Diagram 3.)

OPERATION

The "Y" valve is designed with a simple and positive mechanism. When choosing the discharge hose system to use, simply orient the selector lever on the "Y" valve over that specific hose. If the selector lever is straight up and down both hoses will be open for flow. When selecting the particular hose for flow, be sure that the lever is securely positioned against the positive stop. This will prevent bypass into the hose that the operator has chosen to shut off.

MODEL 45510-0000
TWO POSITION SEWAGE VALVE

JABSCO PRODUCTS **ITT**

43000-0339 Rev. 8/80

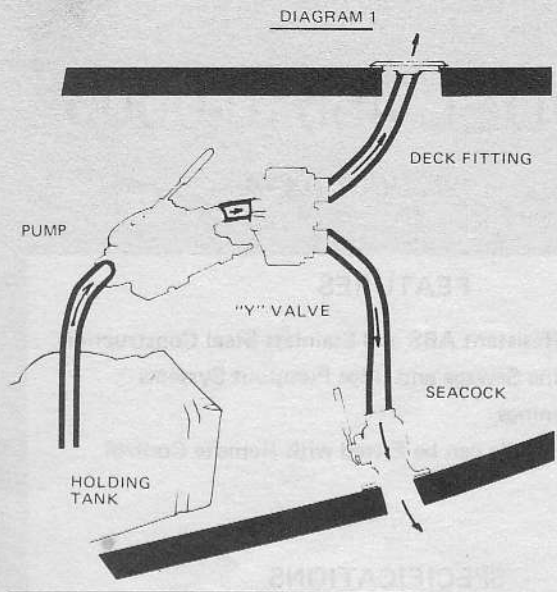

It is recommended that all hoses used below the water line of the boat should be the heavy, fabric reinforced, hose. Vacuum cleaner type hose and vinyl hoses will collapse under the vacuum of a dockside pump out system, or will allow sewer gas to permeate into the boat. All hoses should be double clamped with stainless steel band type clamps.

The Par "Y" valve has been designed to accept a standard remote cable installation. A Morse Type 33-C cable or equivalent is acceptable. The installer should use a Morse B-33372 "T" handle control for equivalent) with a Morse A0 31509 or A0 36174 cable clamp. The Par "Y" valve handle has been designed to accept a Morse A0 31799-001 (or equivalent) ball joint. Follow cable manufacturer's instructions for proper installation.

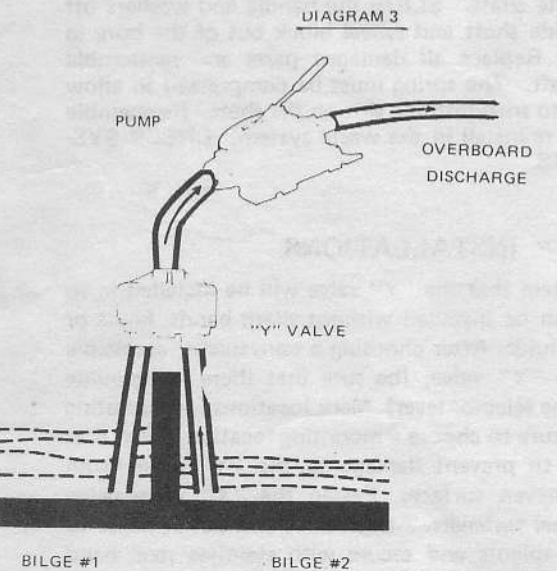
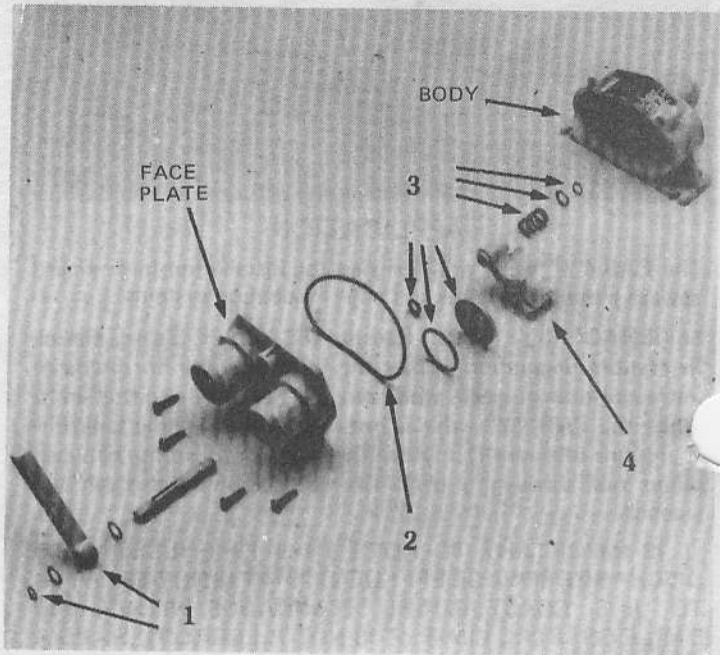
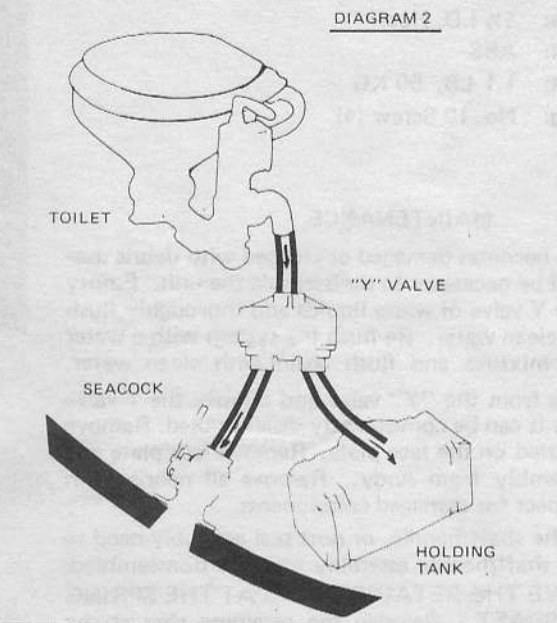

PARTS LIST

Key	Description	Part Number	Qty.
1	Selector Lever ¹	45559-0000	1
2	O'Ring Gasket	45559-0001	1
3	Valve Seal Mechanism ²	45559-0002	1
4	Swivel Block	45559-0003	1

¹Includes Shaft Spring Retainer
²Includes Seal disk and O'Ring, Shaft O'Ring, Shaft Spring Shaft Snap Ring

JABSCO PRODUCTS **ITT**
 Marine and Recreation Components Division
 International Telephone and Telegraph Corporation
 1485 Dale Way, Costa Mesa, California 92626
 Telephone: (714) 545-8251