

# JABSCO® PUMPS

Self Priming Pumps

# MODEL 3590-9001

Product Data

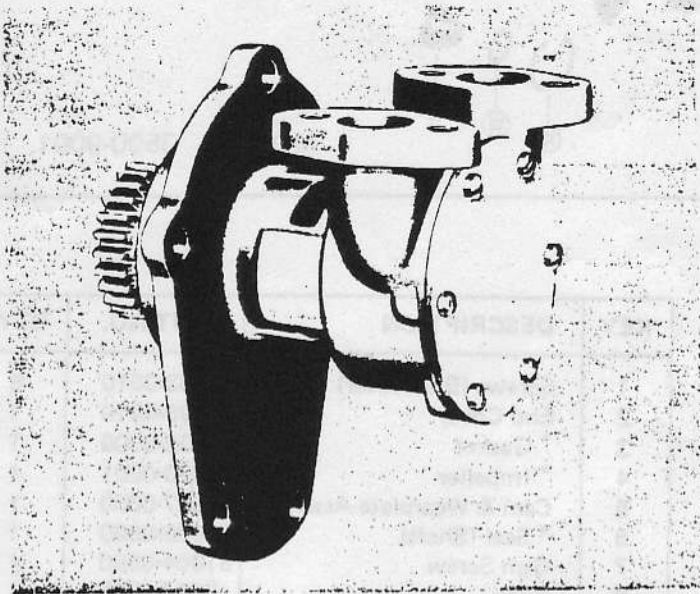

MODEL 3590-9001

## DESIGN FEATURES

Body:	Bronze
Impeller:	Jabco Neoprene Compound
Shaft:	Bronze
Shaft Seal:	Carbon-Ceramic Face Type
Ports:	1"
Weight:	Approx. shipping weight 7 lbs.

APPLICATION:  
Marine Engine Cooling

FOR ENGINE MODELS:  
Chrysler Ace, Crown, and Royal  
M-46, M-47, and M-48.  
Ace & Crown M-46-3 & M-47-3.

MODEL: 3590-9001

## DIMENSION DRAWING

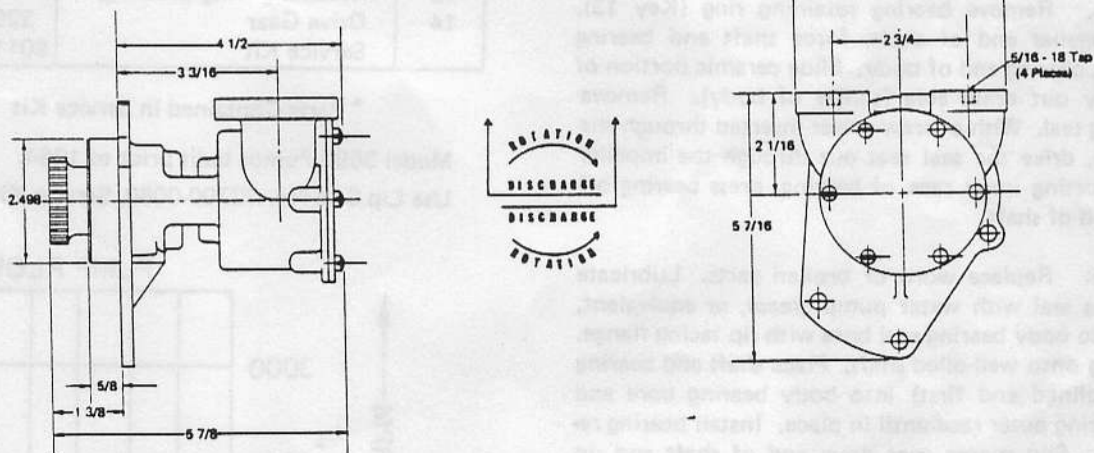

### Installation Instructions

Make sure flange seats squarely on mounting surface and bolt to engine. Connect inlet and outlet fittings. Intake and discharge piping of the engine must correspond with the proper port markings on the pump.

### Operating Instructions

Pump will self prime at low or high speeds. Make sure scoop and inlet line are clear and all connections air tight. Do not run pump dry for more than 30 seconds. Lack of water flow may damage impeller. To drain pump, loosen end cover screws.

JABSCO PRODUCTS

76  
12/11/91

EXPLODED VIEW

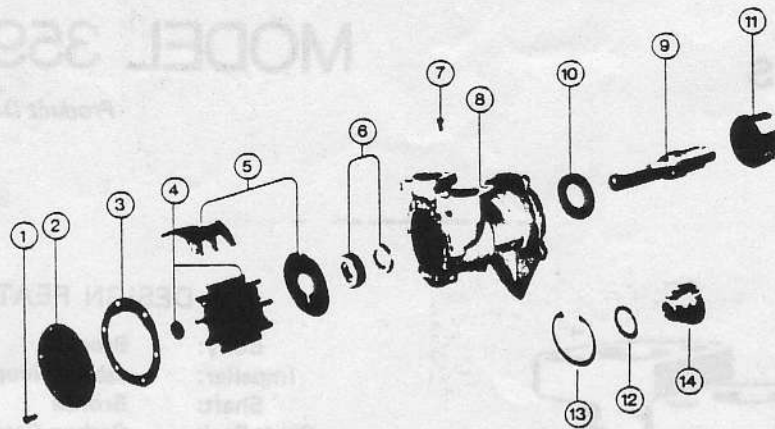

MODEL: 3590-9001

Service Instructions

**Impeller Replacement:** Remove end cover and gasket. Pull impeller out by grasping hub or blades with pliers. Replace impeller, gasket, and end cover. A light coating of grease in impeller bore will aid priming on dry start up. (Use correct Jabsco gasket; a thicker or thinner gasket may cause impeller damage.) Standard gasket is .010" thick.

**Major Repair:** Remove pump from engine to replace seal assembly, bearings, or shaft.

**Disassembly:** Remove end cover and gasket. Remove impeller. Loosen cam screw and tap down to loosen cam. Remove cam screw, cam, and wearplate (wipe off permatex). Using a gear puller, remove drive gear from shaft without damaging gear (if teeth on gear are damaged, the gear must be replaced). Remove bearing retaining ring (Key 13). Press on impeller end of shaft, force shaft and bearing assembly out bearing end of body. Slide ceramic portion of seal assembly out drain area (center of body). Remove inner bearing seal. With a screw driver inserted through the bearing bore, drive the seal seat out through the impeller bore. Supporting inner race of bearing, press bearing off over drive end of shaft.

**To Assemble:** Replace worn or broken parts. Lubricate inner bearing seal with water pump grease, or equivalent, and press into body bearing seal bore with lip facing flange. Press bearing onto well-oiled shaft. Place shaft and bearing assembly (splined end first) into body bearing bore and press on bearing outer race until in place. Install bearing retaining ring. Slip spacer over drive end of shaft and up against bearing. Supporting splined end of shaft, press drive gear onto drive end of shaft. Place ceramic portion of seal assembly over splined end of shaft and back against shaft shoulder (flat side of ceramic seat must face impeller bore). Lubricate with water (do not use oil) to ease assembly. Lightly Permatex O.D. surface of seal case and with carbon facing ceramic, press on outer edge of seal seat until flush with rear of body impeller bore. Install wearplate with small notch facing up. Permatex threads of cam screw and top of cam and install loosely. Lubricate impeller bore with a light coat of water pump grease and install impeller. Install gasket and end cover. Tighten cam screw.

KEY	DESCRIPTION	PART NO.	QTY.
1	Screws (End Cover)	91003-0010	6
2	End Cover	3595-0010	1
3	* Gasket	2432-0000	1
4	* Impeller	920-0001	1
5	Cam & Wearplate Assembly	7957-0000	1
6	* Seal (Shaft)	96080-0080	1
7	Cam Screw	91004-0090	1
8	Body	3594-9000	1
9	Shaft	3597-0410	1
10	Seal (Bearing)	92700-0200	1
11	Ball Bearing	92600-0060	1
12	Spacer	3912-0000	1
13	Retaining Ring (Bearing)	91701-1850	1
14	Drive Gear	3296-0000	1
	Service Kit	90118-0001	

\* Parts Contained in Service Kit

Model 3590 Pumps built prior to 1964.

Use Lip Seal No. 92700-0060, Service Kit No. 90010-0001

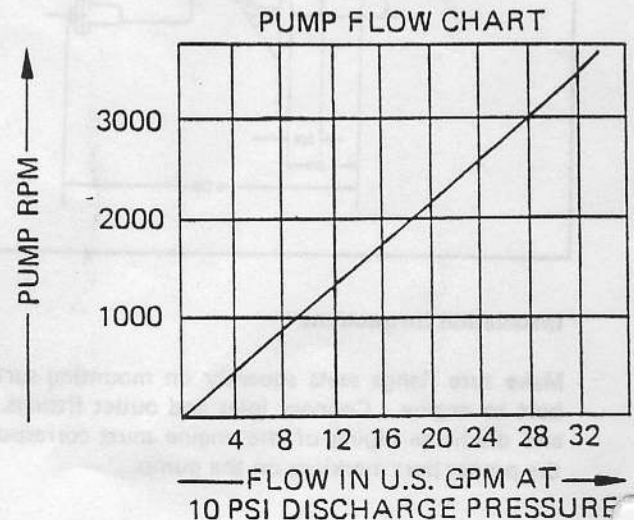

**JABSCO PRODUCTS** **ITT**

Marine and Recreation Components Division  
International Telephone and Telegraph Corporation  
1485 Dale Way, Costa Mesa, California 92626

Telephone: (714) 545-8251