

JABSCO

Model 3270-0001

SELF-PRIMING PUMPS

FEATURES

Body:	Bronze
Impeller:	Jabco Neoprene Compound
Shaft:	Stainless Steel
Shaft Seal:	Lip Type
Ports:	3/4" NPT
Weight:	4 Lbs. (1.8 Kg) Approx.

APPLICATION

Marine Engine Cooling

Perkins Model 4-107: use 3270-0001

Model 3270-0001

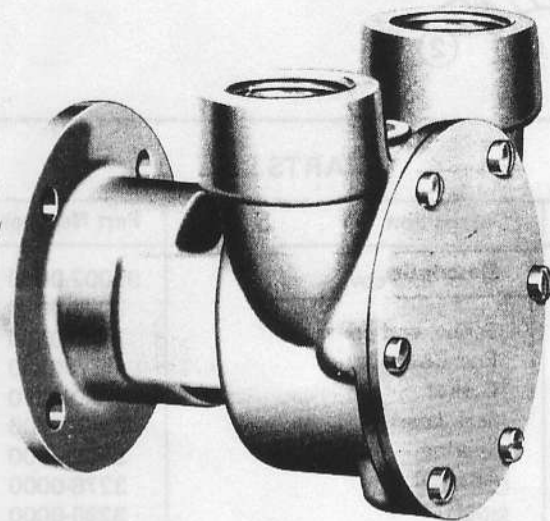

DIMENSIONAL DRAWING

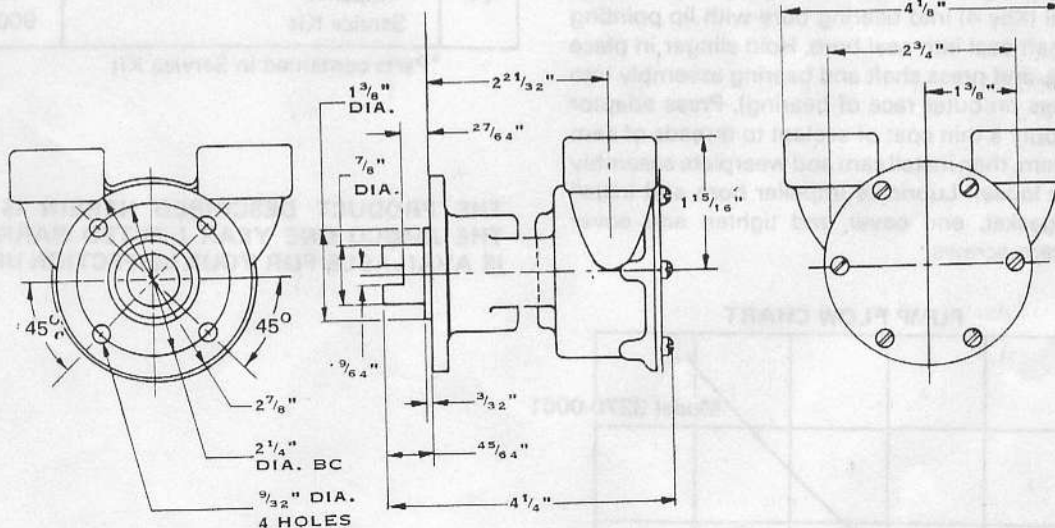

INSTALLATION INSTRUCTIONS

Engage shaft with drive tang, making sure flange seats squarely on mounting surface, and bolt to engine. Connect inlet and outlet fittings using pipe compound to seal threads.

OPERATING INSTRUCTIONS

Pump will self prime at low or high speeds. Make sure scoop and inlet are clear and all connections airtight. Do not run pump dry for more than 30 seconds. Lack of water flow may damage impeller. To drain pump, loosen end cover screws.

CROSS SECTION VIEW

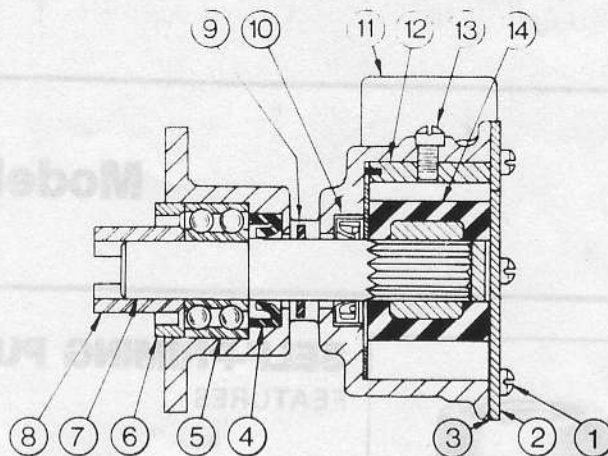

MODEL 3270-0001

SERVICE INSTRUCTIONS

Impeller Replacement: Remove end cover and gasket. Pull impeller out by grasping hub with pliers. A light coating of grease in impeller bore will aid priming on dry startup. Replace impeller, gasket and end cover.

Major Repair: Remove pump from engine to replace seal, bearings or shaft.

Disassembly: Remove end cover, gasket and impeller as outlined above. Press on impeller end of shaft to remove adaptor ring (Key 6) and shaft and bearing assembly. Remove cam and wearplate assembly (clean off sealant). Use screwdriver to pry bearing seal out of bearing bore. Press shaft seal (Key 10) out toward impeller bore. Supporting inner race of bearing, press bearing and coupling off shaft. Inspect and replace all worn parts.

Assembly: Press bearing onto shaft, supporting inner race of bearing. Press coupling on until it bottoms against bearing. Press bearing seal (Key 4) into bearing bore with lip pointing outward. Press shaft seal into seal bore. Hold slinger in place in body drain area, and press shaft and bearing assembly into bearing bore (press on outer race of bearing). Press adaptor ring into place. Apply a thin coat of sealant to threads of cam screw and top of cam, then install cam and wearplate assembly (leave cam screw loose). Lubricate impeller bore and install impeller. Install gasket, end cover and tighten end cover screws. Tighten cam screws.

PARTS LIST

Key	Description	Part Number	Qty.
1	Screw, end cover	91002-0020	6
2	End Cover	3275-0000	1
3	*Gasket	3298-0000	1
4	Seal, bearing	92700-0180	1
5	Bearing	92600-0070	1
6	Adaptor Ring	3276-0000	1
7	Shaft	3277-0000	1
8	Coupling	3278-0000	1
9	Slinger	3286-0000	1
10	*Seal, shaft	92700-0060	1
11	Body	3274-0000	1
12	Cam and Wearplate Assembly	7884-0000	1
13	Cam Screw	91003-0010	1
14	*Impeller	1210-0001	1
	Service Kit	90033-0001	

*Parts contained in Service Kit

THE PRODUCT DESCRIBED HEREIN IS SUBJECT TO THE JABSCO ONE YEAR LIMITED WARRANTY, WHICH IS AVAILABLE FOR YOUR INSPECTION UPON REQUEST.

PUMP FLOW CHART

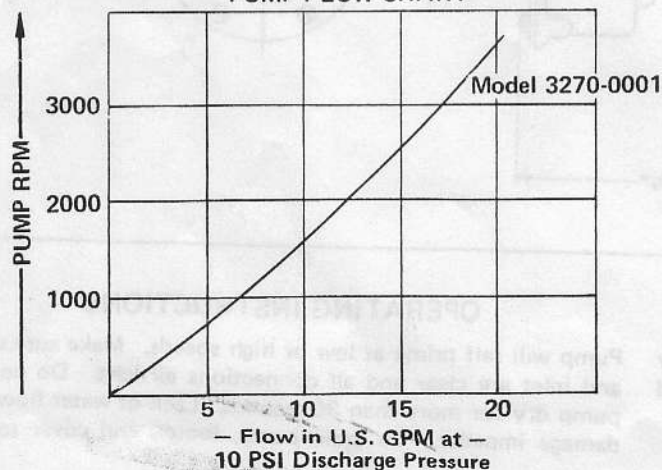

ITT JABSCO

A Unit of ITT Corporation

1485 Dale Way, P.O. Box 2158
Costa Mesa, California 92628-2158
Telephone: (714) 545-8251