

MODEL 2240

Special Flange-Mounted Model
for Caterpillar Marine Engines

(Series D-11000—D-13000—D-17000)

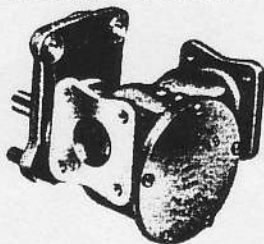

1 1/4" Port Size

Approx. Wt. 14 lbs.

INSTALLATION DRAWING

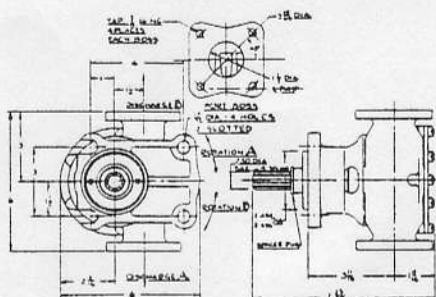

EXPLODED VIEW

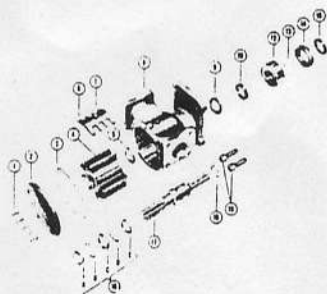

PARTS LIST

STANDARD MODEL 2240—1 1/4"

| KEY | DESCRIPTION | QTY. | PART NO. |
|-----|---------------------------|------|-------------|
| 1 | SCREW (End Cover to Body) | 5 | SP-1005-04 |
| 2 | END COVER | 1 | 2270 |
| 3 | GASKET | 1 | 816 |
| 4 | IMPELLER (Assembly) | 1 | 836 |
| 5 | SEAL SEAT | 1 | 2247 |
| 6 | CAM | 1 | 834 |
| 7 | SCREW (Cam to Body) | 1 | SP-1005-04 |
| 8 | BODY | 1 | 2245 |
| 9 | SLINGER | 1 | 3181 |
| 10 | BEARING SEAL | 1 | 817 |
| 12 | BALL BEARING | 1 | SP-2600-04 |
| 13 | RETAINING RING | 1 | SP-1700-245 |
| 14 | LOCATING RING | 1 | 2586 |
| 15 | OIL SEAL | 1 | SP-2700-10 |
| 16 | COMPLETE SEAL ASSEMBLY | 1 | 1814 |
| | A-Marcel Washer | 1 | 707 |
| | B-Neoprene Washer | 1 | 686 |
| | C-Ferrule | 1 | 833 |
| | D-"O" Ring | 1 | SP-2000-40 |
| | E-Carbon Seal | 1 | 410 |
| | SHAFT | 1 | 2246 |
| | SPACER RING | 1 | 2861 |
| 19 | SOCKET HEAD CAP SCREW | 2 | SP-3005-01 |

ENGINE NAME AND MODEL

Caterpillar Series—D-11000—D-13000—D-17000

HEAD CAPACITY TABLE

MODEL 2240

| TOTAL HEAD | | 500 RPM | 870 RPM | 1450 RPM | 1750 RPM | 2200 RPM |
|------------------|--------------|------------|------------|-------------|-------------|-------------|
| Lbs. per Sq. In. | Ft. of Water | GPM | GPM | GPM | GPM | GPM |
| 4.3 | 10 | 15.2 | 27.0 | 45.6 | 54.9 | 61.3 |
| 8.7 | 20 | 14.6 | 26.1 | 43.7 | 52.5 | 60.3 |
| 13.0 | 30 | 13.9 | 24.8 | 41.1 | 49.2 | 58.6 |
| 17.3 | 40 | 13.2 | 23.4 | 38.1 | 45.7 | 56.4 |
| 21.6 | 50 | 12.5 | 20.5 | 35.1 | 41.8 | 53.2 |

OPERATING INSTRUCTIONS

- INSTALLATION**—Pump may be mounted at any angle without loss of efficiency. The rotation of the motor shaft determines the location of the pump's intake and discharge ports. Before installing, turn pump shaft in direction of operating rotation.
- DRIVE**—Direct
- SPEEDS**—100 RPM to the maximum shown in the performance table. For longer pump life, operate at lowest speeds permissible.
- SELF-PRIMING**—Unit will operate satisfactorily at low as well as high speeds. For vertical suction lift requirements at maximum of 15 ft., a minimum of 800 RPM is required. Pump will produce suction lift up to 24 ft. when primed. Be sure suction lines are air tight.
- RUNNING DRY**—Unit depends on liquid pumped for lubrication. **DO NOT RUN DRY** for more than 30 seconds. Lack of liquid may burn the impeller.
- PRESSURES**—For continuous operation, pressure should not exceed 30 pounds for the standard Model 2240.
- TEMPERATURES**—45-120°F. Use standard impeller. 45-180°F. Use special .08 impeller.
- FREEZING WEATHER**—Drain unit by loosening end cover plate. For closed systems, use only Atlas "Permaguard" or Du Pont "Zerex" anti-freeze compounds. Do not use petroleum based anti-freeze compounds.
- IMPELLER REPLACEMENT**—Remove end cover. Withdraw impeller by grasping impeller hub with pliers.
- GASKET REPLACEMENT**—Always use standard pump part. A thicker gasket will reduce priming ability. A thinner gasket will cause impeller binding.
- CAM REPLACEMENT**—Coat top surface of new cam and cam screw threads with Permatex #1 or equivalent sealing compound before installing.
- SPARE PARTS**—Avoid costly shut downs by always having a JABSCO Repair Kit on hand #6120.

WARRANTY: All products of the company are sold and all services of the company are offered subject to the company's warranty and terms and conditions of sale, copies of which will be furnished upon request.

JABSCO® PUMP COMPANY

1485 DALE WAY • COSTA MESA, CALIF.