

# JABSCO

## TECHNICAL DATA MODEL 12050 3/4"

SELF-PRIMING FLANGE-MOUNTED MODEL  
FOR CHRIS CRAFT 283 SERIES  
V-8 MARINE ENGINE

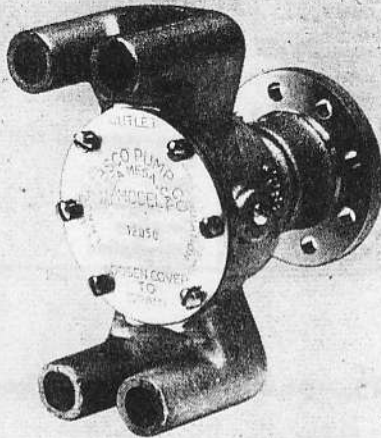

### DESIGN FEATURES

BODY	Bronze Construction
IMPELLER	Jabco Neoprene Compound
SHAFT	Naval Brass
WEARPLATE	Replaceable
SHAFT SEAL	Mechanical Face Type
PORTS	3/4" Dual Discharge (Hose Connection)
	3/4" Dual Inlet (Hose Connection)
WEIGHT	4 lbs. (approximately)

### OPERATING INSTRUCTIONS

- INSTALLATION**—When pump rotation is clockwise (facing endcover), install with cam screw away from engine. When pump rotation is counter clockwise (facing endcover), install with cam screw toward engine. Lower ports will be inlet. Pump may be positioned (using extra holes in mounting flange) to clear engine beds or equipment around pump.
- SELF-PRIMING**—Primes at low or high speeds. Be sure suction line is air-tight or pump will not self prime.
- RUNNING DRY**—Unit depends on liquid pumped for lubrication. **DO NOT RUN DRY** for more than 30 seconds. Lack of liquid will burn the impeller.
- TEMPERATURES**—Standard impeller is designed to handle liquid temperatures between 45° - 180° F.
- FREEZING WEATHER**—Drain unit by loosening the end cover. The following anti-freeze compounds can be used without any adverse effects to the impeller: Atlas "Permaguard," DuPont "Zerex" and "Telar," Dow Chemical "Downguard" and Olin Mathison "Pyro." Most methyl alcohol (methanol) based anti-freeze can be used. **DO NOT USE PETROLEUM BASED ANTI-FREEZE COMPOUNDS OR RUST INHIBITORS.**
- GASKET**—Use standard pump part. Thicker gasket will reduce priming ability. A thinner gasket will cause impeller to bind.
- SPARE PARTS**—A JABSCO Service Kit SK-117 should be kept on hand to service all but the most badly worn 12050 pump.

### SERVICE KITS

PUMP MODEL NUMBER	SERVICE KIT NUMBER	Minor Service Kit contains: Impeller, seal, gasket and end cover screws.
12050	SK-117	

JABSCO

**BRONZE SELF-PRIMING  
BALL BEARING PUMP**

**TECHNICAL DATA  
MODEL 12050 3/4"**

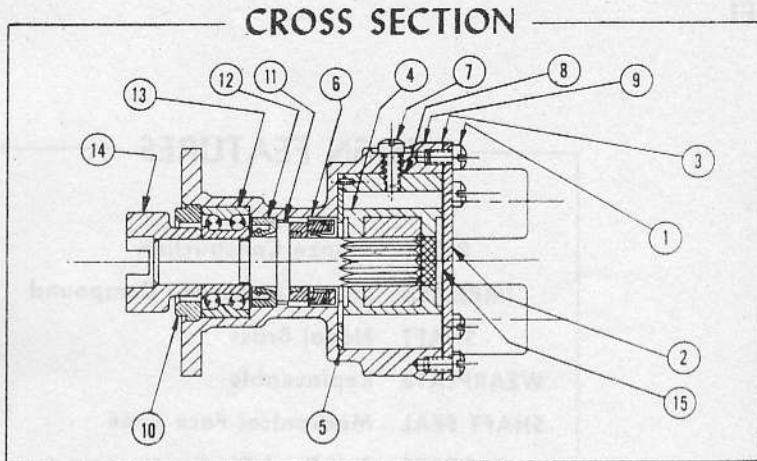

**PARTS LIST**

KEY	PART NUMBER	DESCRIPTION	QTY. REQ.
1	SP 1003-09	Screw—Fil-Hd	6
2	12055	Cover—End	1
3	8641	Gasket	1
4	3085	Assy—Impeller	1
5	8493	Wearplate	1
6	SP 6080-08	Seal—Rotary	1
7	SP 1003-11	Screw—Fil-Hd	1
8	8528	Assy—Sub-Cam	1
9	12054	Body	1
10	3376	Ring—Adaptor	1
11	12057	Shaft	1
12	SP 2700-18	Seal	1
13	SP 2600-07	Bearing—Ball	1
14	8483	Coupling	1
15	4345	Seal—Spline	1

Note part Key #9 used only for pumps with single inlet.

Insist on genuine Jabsco parts—made only by the Jabsco Products ITT—the original and world's leading manufacturer of self-priming flexible neoprene impeller pumps.

**SERVICE INSTRUCTIONS**

**DISASSEMBLY**

1. Remove end cover screws, end cover and gasket.
2. Remove impeller by grasping hub with water pump pliers.
3. Remove cam screw and cam. Clean off Permatex.
4. Remove wearplate.
5. Pressing on impeller end of shaft, press out bearing, shaft, bearing seal, shaft seal seat and coupling assembly.
6. Disassemble shaft assembly. Support bearing on inner race and press on drive end of shaft to remove coupling, bearing and bearing seal.
7. Remove shaft seal from body, pressing from bearing bore end of body.

**NOTE:** Inspect all parts for wear or damage and replace if necessary.

**ASSEMBLY**

1. Install bearing seal on oiled shaft with lip facing away from shaft shoulder.
2. Press bearing on the shaft, support inner race.
3. Install shaft assembly into body by pressing on outer race of bearing.
4. Install adaptor ring into body.
5. Press coupling on shaft. Support spline end of shaft.
6. Install seal assembly into body seal bore with carbon face against the ceramic seal seat. Press on outermost edge of seal case to prevent damage to seal.
7. Install wearplate in body bore, aligning slot in wearplate with dowel pin in body.
8. Permatex cam screw threads, topside and back end of cam and install into body with cam screw.
9. Lubricate impeller bore with a light coat of Marfax 2HD grease and install impeller into body bore. Start impeller with a rotary motion, until splines engage, then push into bore.
10. Install gasket and end cover and secure with end cover screws.

**JABSCO PRODUCTS ITT**

Fluid Handling Division, International Telephone and Telegraph Corporation, 1485 Dale Way, Costa Mesa, California 92626