

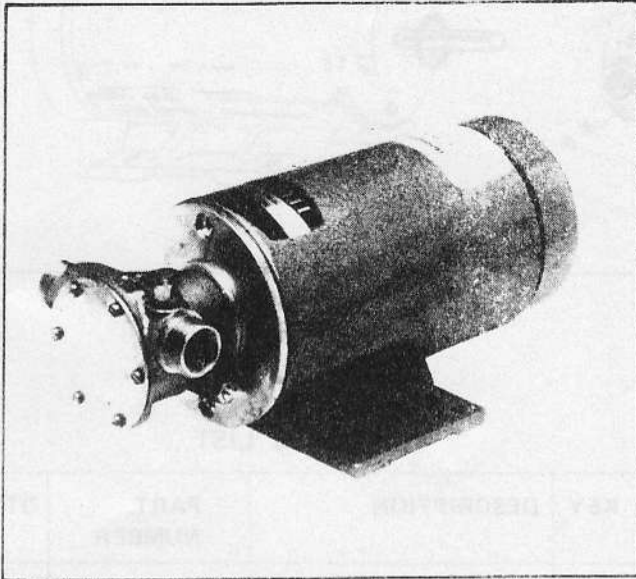

Model 11810-0121 12 volts dc
11810-0241 24 volts dc
11810-0321 32 volts dc
11810-1101 110 volts dc



SELF-PRIMING PUMPS
FEATURES

- Body:** Bronze Construction
- Impeller:** Jabsco Neoprene Compound
- Shaft:** Steel Motor Shaft Protected by Stainless Steel Impeller Sleeve
- Wearplate:** Replaceable
- Shaft Seal:** Lip Type
- Ports:** Both 3/4" Garden Hose External Thread and 1/2" Internal Pipe Thread
- Motor:** 1/3 hp/1800 RPM, Continuous Duty
- Weight:** 22 lbs (Approximately 10 kg)

Motor meets USCG Electrical Standards (Title 33, Chapter 1, Part 183; Subpart 1) for **IGNITION PROTECTION** on gasoline powered vessels.

APPLICATIONS

Ideal for Bilge Pumping, Bait Tank, Wash Downs, and General Marine Service.

HEAD CAPACITY TABLE

TOTAL HEAD				1800 RPM	
p.s.i.	kg per sq. cm.	ft. of water	metres of water	GPM	litres per min
4.3	0,3	10	3	11,2	42,4
8.7	0,6	20	6,1	10,5	39,7
13.0	0,9	30	9,1	9,4	35,6
17.3	1,2	40	12,2	8,1	30,7

MOTOR VOLTAGE	AMP DRAW	FUSE SIZE	WIRE SIZE		
			0'-10'	11'-20'	21'-35'
12 Vdc	28.0	30	10	8	6
24 Vdc	14.0	15	16	14	14
32 Vdc	9.5	10	16	16	16
110 Vdc	2.6	3	16	16	16

OPERATING INSTRUCTIONS

- INSTALLATION** — Pump may be mounted in any position without loss of efficiency; however, it is suggested that the pump head be down if vertical mounting is desired. The rotation of the motor shaft determines the location of the pump's intake and discharge ports. Refer to Dimensional Drawing.
- DRIVE** — Direct.
- SELF-PRIMING** — Pump will produce a suction lift approaching 10 feet when dry and a lift up to 22 feet when primed. **BE SURE SUCTION LINES ARE AIRTIGHT** or pump will not self-prime.
- RUNNING DRY** — Unit depends on liquid pumped for lubrication. **DO NOT RUN DRY** for more than 30 seconds. Lack of liquid will burn the impeller.
- NOTICE** — Do not pump solvents, thinners, highly concentrated or organic acids. Pump damage may result. If corrosive fluids must be handled, pump life will be prolonged if pump is flushed with water after each use or after each work day.
- PRESSURES** — For continuous operation, do not exceed 40 feet total developed head.
- TEMPERATURE** — Impeller supplied in pump is recommended for liquid temperatures of 45° - 180°F (7.2° - 82.2°C). Optional Nitrile Impeller 50° - 180°F (10° - 82.2°C).
- SPARE PARTS** — To avoid costly shut downs, keep a Jabsco Service Kit on hand.

DIMENSIONAL DRAWING
 INCHES (MILLIMETRES)

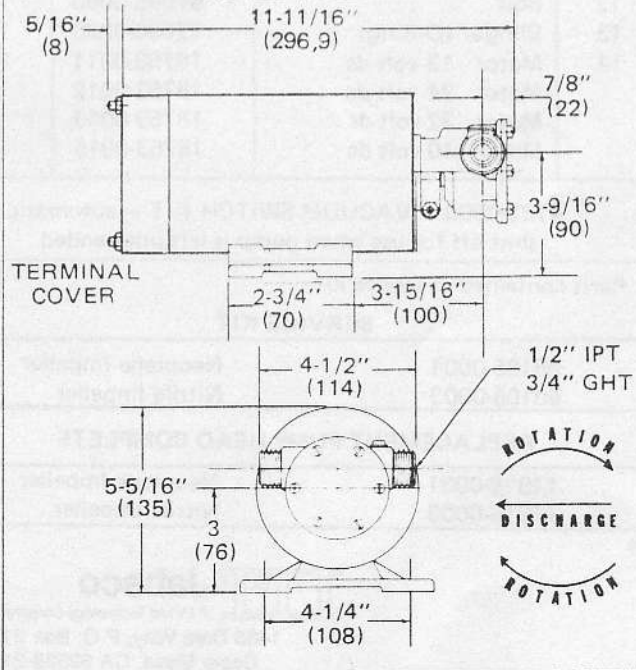

Models 11810-0121, 11810-0241, 11810-0321, 11810-1101

EXPLODED VIEW

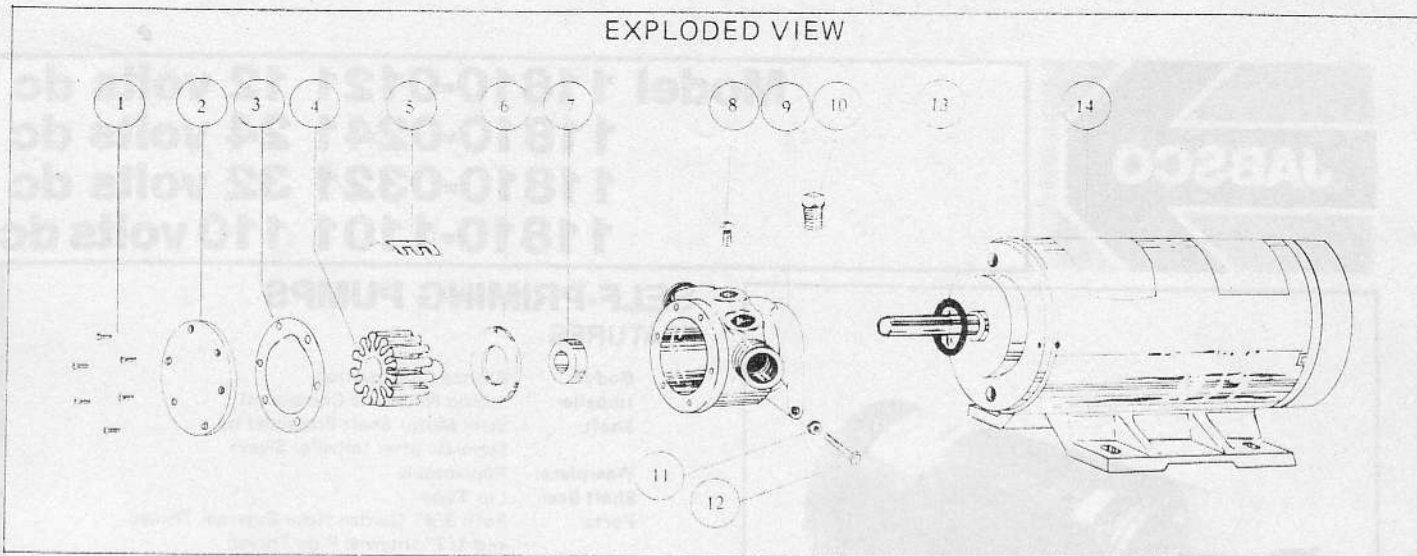

SERVICE INSTRUCTIONS

DISASSEMBLY

1. Remove end cover screws, gasket and end cover.
2. Grasp impeller hub with water pump pliers and withdraw from body.
3. Loosen cam screw and remove cam. Clean off sealant. Remove wearplate with screwdriver or hooked wire.
4. Loosen nut at body clamp. Remove body from motor shaft.
5. Press out seal from motor mounting end of body towards impeller bore.
6. Remove slinger from shaft.

NOTE: Inspect all parts for wear or damage and replace if necessary. When returning to factory for repair, return the pump head only, unless motor replacement is required.

ASSEMBLY

1. Install slinger and position 1/4" from motor boss.
2. Press seal into seal bore with lip facing toward the impeller bore. Apply grease to back of seal lip.
3. Install wearplate, aligning slot with dowel pin.
4. Apply sealant to top of cam and cam screw threads. Install cam with cam screw.
5. Install body on motor. Tighten nut at clamp. Do not over-tighten or binding of shaft will result.
6. Lubricate impeller bore with water pump grease or equivalent.
7. Lubricate shaft O D with grease, align drive ding in extended impeller insert with flat on shaft and install impeller.
8. Install gasket, end cover and end cover screws.

PARTS LIST

KEY	DESCRIPTION	PART NUMBER	QTY.
1	Screw (End Cover)	91002-0020	6
2	End Cover	11830-0000	1
3*	Gasket	11816-0000	1
4*	Neoprene Impeller	5929-0001	
	Nitrile Impeller	5929-0003	1
5	Cam	490-0000	1
6	Wearplate	2235-0000	1
7*	Seal (Shaft)	92700-0420	1
8	Screw (Cam)	91003-0010	1
9	Body	11814-0000	1
10	Plug (for vacuum switch hole)	92650-0070	1
11	Nut	91105-0030	1
12	Bolt	91095-0090	1
13	Slinger (O-Ring)	92000-0230	1
14	Motor 12 volt dc	18753-0011	1
	Motor 24 volt dc	18753-0012	
	Motor 32 volt dc	18753-0013	
	Motor 110 volt dc	18753-0015	

4732-0000 – VACUUM SWITCH KIT – automatic shut off for use when pump is left unattended.

* Parts contained in service kit.

SERVICE KIT

90105-0001	Neoprene Impeller
90105-0003	Nitrile Impeller

REPLACEMENT PUMP HEAD COMPLETE

11818-0001	Neoprene Impeller
11818-0003	Nitrile Impeller

THE PRODUCTS DESCRIBED HEREIN ARE SUBJECT TO THE JABSCO ONE YEAR LIMITED WARRANTY, WHICH IS AVAILABLE FOR YOUR INSPECTION UPON REQUEST.

Jabsco
 ITT Fluid Technology Corporation
 1485 Dale Way, P.O. Box 2158
 Costa Mesa, CA 92628-2158
 Telephone: (714) 545-8251