

Jabsco Pumps

Technical Data

Model 10550-200

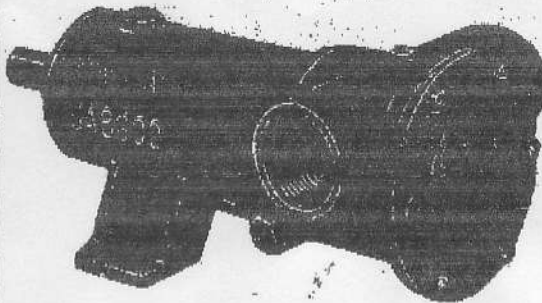

DESIGN FEATURES

- Body Bronze construction
- Pedestal Cast iron
- Impeller Jabsco neoprene compound
- Shaft Stainless steel
- Shaft Seal Mechanical Seal—renewable ceramic seal seat
- Wearplate Replaceable
- Bearings Ball bearings
- Ports 1/2" BSP Internal
- Weight Approximately 4 1/2 (2kg)

Variations incorporated from unit described above

Model 10550-205 Fitted 1/2 cam reduced flow.

Note: Models are available with Nitrile impellers for a wide range of oils—soluble, lubricating, and machine cutting. Not recommended for Toluene, Petrol, Benzene or other high fraction petroleum products.

Typical Applications

Marine

- engine cooling
- pumping bilges
- washing down decks and docks

Industrial

- circulating and transferring liquids
- velocity-mixing
- transferring soap, liquors, pastes, glues, glycerine, lotions and brine

Farm

- pumping water for stock and poultry houses and booster pumping

Plumbing and home

- pumping out flooded basements, cesspools, sumps and many other uses.

	PERFORMANCE CHART															
	TOTAL HEAD WATER				500 RPM		750 RPM		1,000 RPM		1,500 RPM					
	Feet of Water	Meters of Water	ft. per sq. in.	kg. per cm ²	HP	Imperial Gallons per min	Litres per min	HP	Imperial Gallons per min	Litres per min	HP	Imperial Gallons per min	Litres per min			
Standard Full Cam	10	3.05	4.8	0.3	1/8	2.7	12.3	1/8	4.25	19.3	1/4	5.5	25.0	1/2	6.25	37.6
	20	6.1	9.7	0.6	1/8	2.5	11.4	1/5	4.0	18.2	1/4	5.25	24.0	1/2	6.0	35.0
	30	9.15	13.0	0.9	1/8	2.0	9.0	1/8	3.75	17.0	1/3	4.75	21.6	1/2	7.5	35.0
	50	15.25	21.6	1.5									1/2	6.2	28.0	
Half Thickness Cam	10	3.05	4.3	0.3	1/8	1.5	6.8	1/8	2.6	12.0	1/4	3.5	16.0	1/2	5.5	25.0
	20	6.1	8.7	0.6	1/8	1.25	5.7	1/8	2.2	10.0	1/4	3.0	13.5	1/3	6.0	23.0
	30	9.15	13.0	0.9						1/4	2.5	11.5	1/3	4.25	19.0	
	40												1/2	3.5	16.0	

Performance stated is typical for new pump with Standard Impeller pumping water at ambient temperature. Alternative impeller materials can affect performance. Consult factory or distributor for advice.

Exploded View and Parts List

Technical Data

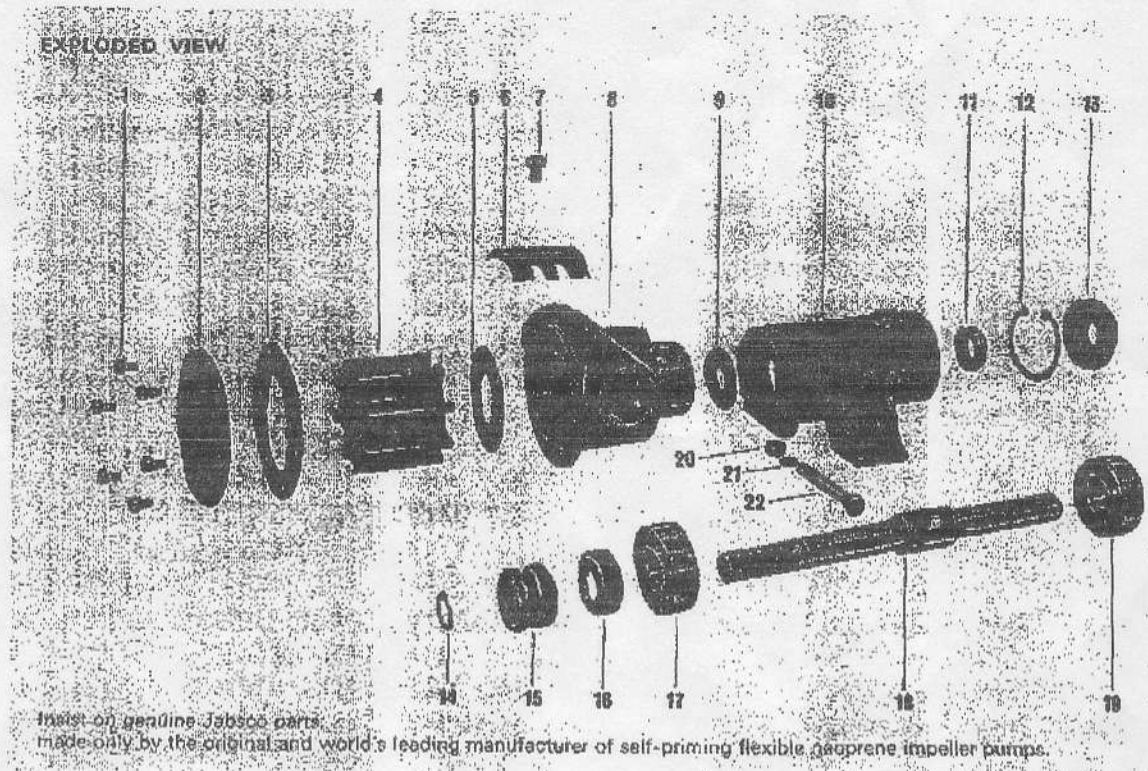

PARTS LIST			
Key	Description	Qty	Part No.
1	End Cover Screw	6	SP1002-02
2	End Cover		
	Model 10550-200	1	10555-200
	Model 10550-205	1	10555-205
3	Gasket	1	3298
4	Impeller	1	1210
5	Wearplate	1	9996
6	Cam		
	Model 10550-200	1	490
	Model 10550-205	1	10336
7	Cam Screw		
	Model 10550-200	1	SP1003-01
	Model 10550-205	1	SP1003-09
8	Body	1	10554-200
9	Slinger	1	3286
10	Bearing Housing	1	10557
11	Seal (Bearing)	1	SP2703-02
12	Retaining Ring	1	SP1700-248
13	Seal (Bearing)	1	SP2701-15
14	Shaft Retaining Ring	1	SP1700-62
15	Primary Seal	1	SP6080-07
16	Ceramic Seal Seat	1	SP6022-07
	Seal Seat Cup Rubber	1	9722
17	Ball Bearing	1	SP2601-39
18	Shaft	1	10417
19	Ball Bearing	1	SP2601-39
20	Nut	1	SP1105-03
21	Washer	1	SP1602-06
22	Bolt	1	SP1095-09
23	Bearing Spacer	1	9998
24	Shaft Retaining Ring (not shown)	1	SP1700-249

SERVICE KIT	
Pump model number	Service kit number
10550-200	SK239
10550-205	SK239
Service kit includes: Impeller Gasket End Cover Screws Seal, Seal Seat and Cup Rubber Retaining Ring	