

Three-Way Valve

- 3-way valve operates logically - The handle points to the direction of flow. Center position is "off".
- Handle rotates a full 180°.
- Mount foot included.
- Full flow.
- Stainless steel handle and hardware.
- PTFE seats and seals.
- TWV-1500 size is ideal for waste systems.
- UL listed for fuel or water.

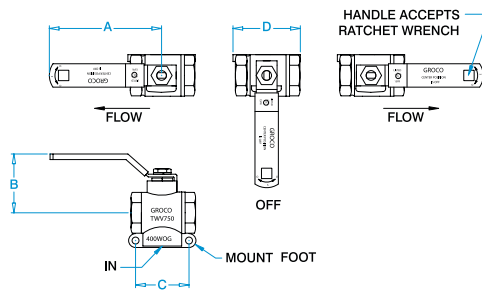

MODEL	NPT	A	B	C	D	WEIGHT	PKG
TWV-500	1/2"	4.10"	2.12"	1.90"	2.40"	1.08	2
TWV-750	3/4"	4.10"	2.20"	1.93"	2.44"	1.24	2
TWV-1500	1-1/2"	6.00"	3.30"	3.15"	3.95"	5.60	1

TWV SERIES

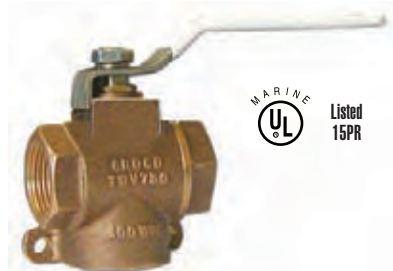

Fuel Valve

ABYC H33.9.2 states that fuel system valves must have an independent means of support. That's why regular in-line valves are not appropriate for fuel systems applications.

- Patented selectable handle rotation.
- Full flow.
- Mount foot included.
- Stainless steel handle and hardware.
- 400 WOG.
- PTFE seats and seals.
- UL Listed for fuel or water.

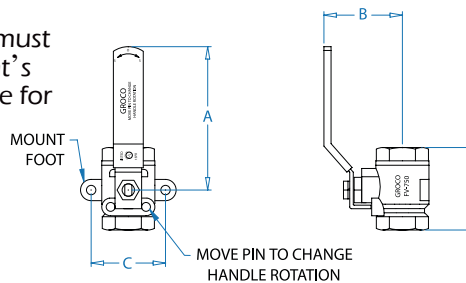

MODEL	NPT	A	B	C	D	WEIGHT	PKG
FV-250	1/4"	4.10"	2.22"	1.54"	1.77"	.52	16
FV-375	3/8"	4.10"	2.22"	1.54"	1.77"	.50	16
FV-500	1/2"	4.10"	2.20"	1.85"	2.05"	.82	16
FV-750	3/4"	4.10"	2.22"	2.10"	2.33"	1.06	10

FV SERIES

U.S. PATENT NO. 7,000,896

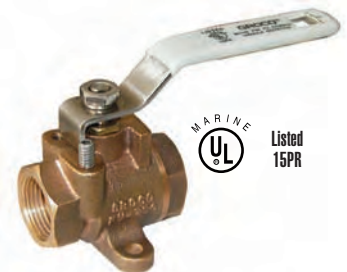

90-Degree Fuel Valve

- Compact design.
- 90° flow path.
- 1/2" NPT male and female ports.
- Use FV-590 for fiberglass tanks.
- Use FV-590-S with aluminum or stainless steel tanks.

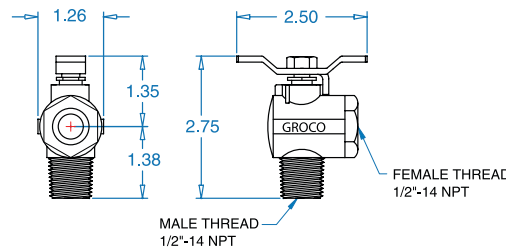

FV-590 SERIES



Six-port fuel valves are used where 2 tanks supply a single engine, and a return to each supply tank is required.

ABYC H33.9.2 states that fuel system valves must have an independent means of support, so in-line valves are not suitable for fuel system applications.

FV-65038 and FV-61075 have an "L" shaped flow pattern and 180° handle swing; FV-65038-A and FV-61075-A have a "T" shaped flow pattern and 360° handle actuation.

FLOW PATTERN FV-65038 AND FV-61075

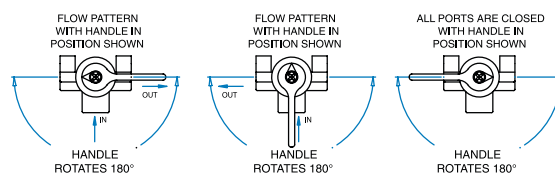

FLOW PATTERN FV-65038-A AND FV-61075-A

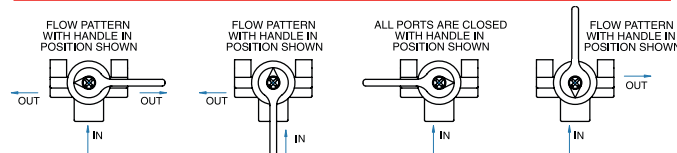

MODELS	MAIN NPT	RETURN NPT	A	B	C	D	E	F
FV-65038	1/2"	3/8"	5.62	2.31	2.23	2.78	2.06	1.25
FV-65038-A	1/2"	3/8"	5.62	2.31	2.23	2.78	2.06	1.25
FV-61075	1"	3/4"	8.42	3.47	3.34	4.17	3.09	1.88
FV-61075-A	1"	3/4"	8.42	3.47	3.34	4.17	3.09	1.88

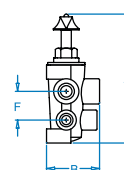

6-PORT FUEL VALVES



PORTS 1, 2, 3 = MAIN
PORTS 4, 5, 6 = RETURN

MOUNT WITH (4) 1/4" BOLTS