

REPAIR PARTS

ReSHSMGR R2

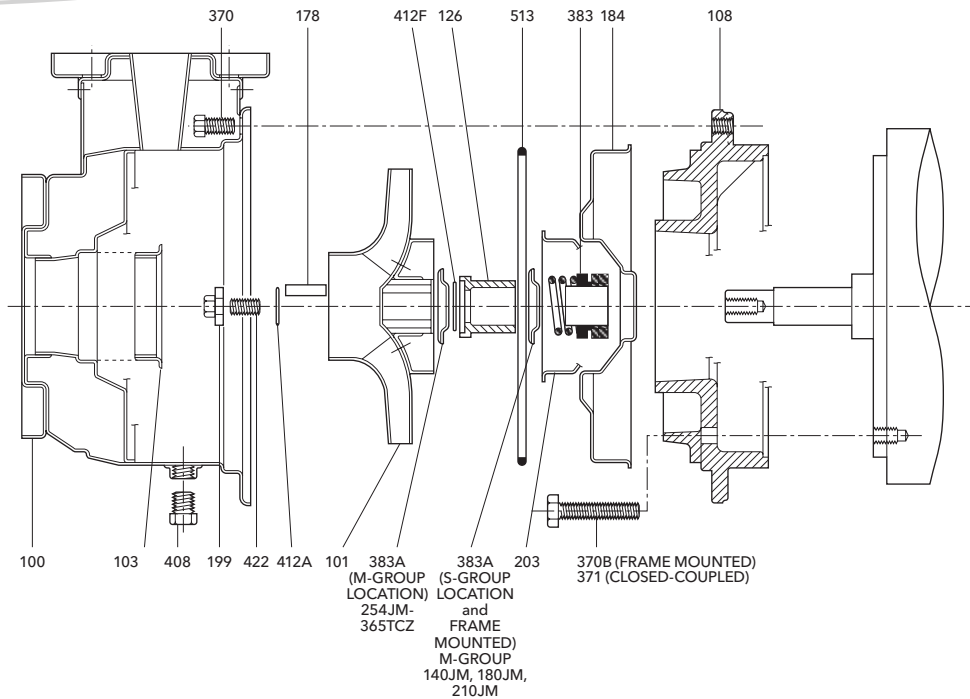

e-SH Repair Parts

316SS END SUCTION CENTRIFUGAL PUMP (60 Hz)

e-SH S-GROUP

Item No.	Part Description	Material	1x2-6	1½x2½-6	2x2½-6	2½x3-6	1x2-8	1½x2½-8	2x2½-8	1x2-10	Max. Wt. (lb)							
			01SH06	15SH06	02SH06	25SH06	01SH08	15SH08	02SH08	01SH10								
100	Casing with wear ring	AISI Type 316SS	1L450	1L453	1L924	1L459	1L451	1L454	1L457	1L452	17							
101	Impeller		6 ¹ / ₁₆	2L978	6 ³ / ₈	2L876	6 ⁹ / ₁₆	2L945	7 ⁵ / ₃₂	2L961	8 ³ / ₁₆	2L972	8 ¹ / ₄	2L879	8 ¹ / ₄	2L985	9 ⁴¹ / ₆₄	2L965
			5 ²⁹ / ₃₂	2L979	6 ³ / ₈	2L874	6 ³ / ₁₆	2L946	6 ²⁷ / ₃₂	2L962	7 ⁴³ / ₆₄	2L973	7 ¹³ / ₁₆	2L878	7 ³ / ₄	2L986	8 ³ / ₁₆	2L966
			5 ³⁵ / ₆₄	2L980	6 ¹ / ₁₆	2L872	5 ¹³ / ₁₆	2L947	6 ¹ / ₂	2L983	7 ²¹ / ₆₄	2L974	7	2L877	7 ¹ / ₂	2L987	8 ²¹ / ₃₂	2L967
			5 ²³ / ₆₄	2L981	5 ⁵ / ₈	2L871	5 ¹ / ₂	2L948	6 ¹⁹ / ₆₄	2L963	7	2L975	6 ³ / ₄	2L876	7 ³ / ₁₆	2L988	8 ³ / ₁₆	2L968
			4 ⁴¹ / ₆₄	2L982	5 ⁵ / ₁₆	2L870	5 ¹ / ₈	2L949	5 ³ / ₄	2L984	6 ¹¹ / ₁₆	2L976	6 ⁷ / ₁₆	2L875	6 ⁷ / ₈	2L989	8	2L969
					4 ¹¹ / ₁₆	2L869	4 ¹³ / ₁₆	2L950	5 ¹ / ₂	2L964	6 ¹ / ₄	2L977	6 ¹ / ₈	2L873	6 ³ / ₁₆	2L990	7 ³ / ₄	2L970
					4 ³ / ₈	2L868	4 ⁷ / ₁₆	2L951									7 ¹³ / ₆₄	2L971
			4 ³ / ₁₆	2L867														
103	Wear ring, casing			4L465	4L466	4L467	4L468	4L465	4L466	4L467	4L465	1						
184	Seal housing with ring		1L465		1L925	1L472	1L466		1L470	1L467	3							
203	Wear ring, seal housing		See Item 100			4L464	See Item 100											
126	Shaft sleeve	316SS	4L473	4L456			4L473	4L456		4L473								
178	Key, impeller	Steel		4K11			4K555	4K11		4K555	1							
422	Stud, impeller		13K217															
199	Washer, impeller	316SS	4L458															
108	Motor adapter, 143-184JM and S-group brg. frame	CI ASTM A48 CL 20	1L554	1L50		1L99	1L560	1L52	1L99	1L562	25							
	Motor adapter, 213-256JM		1L555	1L51		1L98	1L561	1L53	1L98	1L563	29							
370	Bolt, casing	300SS	13L38			13L89	13L38		13L89		-							
371 or 370B	Bolt, adapter, 143-184JM and S-Group brg. frame	Steel SAE 1200	13K360	13L43			13K360	13L43		13K360	25							
	Bolt, adapter, 213-256JM		13K379	13L41		13K245	13K361	13L40	13K245	13K361	29							
383	Mech. seal - standard	Type 21	10K27 - Carbon/Silicon-Carbide/Viton									1						
	Mech. seal - high temp.		10K19 - Carbon/Silicon-Carbide/EPR															
	Mech. seal - severe duty		10K64 - Silicon-Carbide/Silicon-Carbide/Viton															
383A	Retainer, seal spring	316SS	4K517															
408	Plug, vent and drain		6L60									2						
412A	O-ring, impeller washer	Viton	5K320 standard (5K195 EPR option)									1						
412F	O-ring, shaft sleeve		5K307 standard (5K306 EPR option)															
513	O-ring, casing - standard			5K407			5L70	5K408		5L70	5L71							
	O-ring, casing - optional	EPR	5K393			5K317	5K394		5K317	5L110								

e-SH M-GROUP (254JM-365TCZ)

Item No.	Part Description	Material	1½x2½-10		2x2½-10		2½x3-8		2½x3-10		3x4-8		3x4-10		Max. Wt. (lb)
			15SH10		02SH10		25SH08		25SH10		03SH08		03SH10		
100	Casing with wear ring		1L455		1L458		1L460		1L461		1L463		1L464		17
101	Impeller	AISI Type 316SS	9 ⁷ / ₁₆	2L778	9 ⁷ / ₁₆	2L790	9 ¹ / ₁₆	2L952	10 ³ / ₈	2L804	9 ¹ / ₁₆	2L825	10 ⁵ / ₈	2L836	8
			9 ¹ / ₂	2L779	9 ¹ / ₂	2L791	8 ³ / ₄	2L953	9 ¹⁵ / ₁₆	2L805	8 ¹¹ / ₁₆	2L826	10 ¹ / ₄	2L837	
			9 ³ / ₁₆	2L780	9 ¹ / ₈	2L792	8 ¹ / ₂	2L954	9 ⁹ / ₁₆	2L806	8 ⁷ / ₁₆	2L827	9 ¹³ / ₁₆	2L838	
			8 ⁷ / ₈	2L781	8 ¹³ / ₁₆	2L793	8 ¹ / ₄	2L955	9 ¹ / ₄	2L807	8 ¹ / ₁₆	2L828	9 ⁷ / ₁₆	2L839	
			8 ⁹ / ₁₆	2L782	8 ³ / ₁₆	2L794	7 ⁷ / ₈	2L956	8 ³ / ₄	2L809	7 ¹¹ / ₁₆	2L829	9 ¹ / ₁₆	2L825	
			8 ¹ / ₄	2L783	7 ¹⁵ / ₁₆	2L795	7 ¹ / ₂	2L957			7 ¹ / ₂	2L830	8 ¹¹ / ₁₆	2L826	
					7 ¹¹ / ₁₆	2L796	7 ¹ / ₈	2L958			7 ¹ / ₈	2L831			
							6 ¹¹ / ₁₆	2L959			6 ⁷ / ₈	2L832			
							6 ¹ / ₂	2L960			6 ¹ / ₂	2L833			
											6	2L834			
								5 ¹ / ₂	2L835						
103	Wear ring, casing		4L467			4L468			4L469					1	
184	Seal housing with ring		1L468			1L473		1L475			1L478		3		
203	Wear ring, seal housing		4L201			4L464									
126	Shaft sleeve	316SS	4L457												1
178	Key, impeller	Steel	4K261												
422	Stud, impeller		13K301												
199	Washer, impeller	316SS	4L463												
108	Motor adapter, 254-256JM and M-group bearing frame	CI ASTM A48 CL 20	1L91			1L89		1L93			1L94			31	
	Motor adapter, 280JM-365TCZ		1L90			1L88		1L92			1L95			44	
370	Bolt, casing	300SS	13L86 (6 req'd)			13L89 (8 req'd)		13L86 (8 req'd)			13K45 (8 req'd)			-	
371 or 370B	Bolt, adapter, 254-256JM and S-Group bearing frame	Steel SAE 1200	13L88				13L116							-	
	Bolt, adapter, 280JM-365TCZ		13L87				13L115							-	
383	Mech. seal - standard	Type 21	10K45 - carbon/silicon-carbide/viton												1
	Mech. seal - high temp.		10K20 - Carbon/silicon-carbide/EPR												
	Mech. seal - severe duty		10K65 - Silicon-carbide/silicon-carbide/viton												
383A	Retainer, seal spring	316SS	4K500												2
408	Plug, vent and drain		6L60												
412A	O-ring, impeller washer	Viton	5K309 standard (5K308 EPR option)												1
412F	O-ring, shaft sleeve		5K309 standard (5K308 EPR option)												
513	O-ring, casing - standard			5L71			5L70		5L71			5L72			
	O-ring, casing - optional	EPR	5L110			5K317		5L110			5L116				

e-SH M-GROUP (140JM, 180JM & 210JM)

Item No.	Part Description	Material	1½x2½-10		2x2½-10		2½x3-8		2½x3-10		3x4-8		Max. Wt. (lb)	
			15SH10		02SH10		25SH08		25SH10		03SH08			
100	Casing with wear ring	AlSI Type 316SS	1L455		1L458		1L460		1L461		1L463		17	
101	Impeller		9 ⁷ / ₈	2L784	9 ⁷ / ₈	2L797	9 ¹ / ₁₆	2L991	9 ¹⁵ / ₁₆	2L817	9 ¹ / ₁₆	2L840	8	
			9 ¹ / ₂	2L785	9 ¹ / ₂	2L798	8 ¹ / ₂	2L992	9 ⁹ / ₁₆	2L818	8 ⁷ / ₁₆	2L841		
			9 ³ / ₁₆	2L786	9 ¹ / ₈	2L799	8 ¹ / ₄	2L993	9 ¹ / ₄	2L819	8 ¹ / ₁₆	2L842		
			8 ⁷ / ₈	2L787	8 ¹³ / ₁₆	2L800	7 ⁷ / ₈	2L994	8 ³ / ₄	2L821	7 ¹¹ / ₁₆	2L843		
			8 ⁹ / ₁₆	2L788	8 ³ / ₁₆	2L801	7 ¹ / ₈	2L995			7 ¹ / ₈	2L844		
			8 ¹ / ₄	2L789	7 ¹⁵ / ₁₆	2L802	6 ¹¹ / ₁₆	2L996			6 ¹ / ₂	2L845		
					7 ¹¹ / ₁₆	2L803					6	2L846		
									5 ¹ / ₂	2L847				
103	Wear ring, casing			4L467			4L468			4L469			1	
184	Seal housing with ring		1L468			1L473		1L474				3		
203	Wear ring, seal housing		4L201			4L464						1		
126	Shaft sleeve	316SS	4K501			4L456								
178	Key, impeller	Steel	4K11											
422	Stud, impeller		13K217											
199	Washer, impeller	316SS	4L458											
108	Motor adapter, 143-184JM and S-group bearing frame	CI ASTM A48 CL 20	1L97			1L99		1L123					25	
	Motor adapter, 213		1L96			1L98		1L100					29	
370	Bolt, casing	300SS	13L86 (6 req'd)			13L89 (8 req'd)		13L86 (8 req'd)					-	
371 or 370B	Bolt, adapter, 143-184JM and S-Group bearing frame	Steel SAE 1200	13L43					N/A		13L117				-
	Bolt, adapter, 213-256JM		13K245						13K44				-	
383	Mech. seal - standard	Type 21	10K27										1	
	Mech. seal - high temp.		10K19											
	Mech. seal - severe duty		10K64											
383A	Retainer, seal spring	316SS	4K517											
408	Plug, vent and drain		6L60										2	
412A	O-ring, impeller washer	Viton	5K320 standard (5K195 EPR option)										1	
412F	O-ring, shaft sleeve		5K320 standard (5K195 EPR)					5K307 (5K306 EPR option)						
513	O-ring, casing - standard		5L71			5L70		5L71						
	O-ring, casing - optional	EPR	5L110			5K317		5L110						



Xylem Inc.
 Phone: (866) 673-0428
 Fax: (888) 322-5877
www.xylem.com/goulds