

Pos. 3\* und 18 nur bei Ausführung in PP  
 Pos. 4 und 17 nur bei Ausführung in PTFE

Item No. 3\* and 18 only for model in PP  
 Item No. 4 and 17 only for model in PTFE

Rep. 3\* et 18 seulement pour modèle en PP  
 Rep. 4 et 17 seulement pour modèle en PTFE

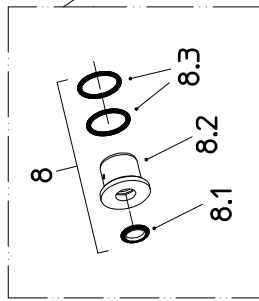



Item No.	Qty. per unit	Description	Part No. RFM 10 PP	Part No. RFM 10 PTFE
<b>Version according to exploded view</b>				
<b>No. D10 80 003 – 04/2008</b>				
<b>valid as from Serial No. RFM00968</b>				
1	8	Hexagonal nut	906 81 005	906 81 005
2	16	Spring washer	909 85 004	909 85 004
3	12	Washer	908 06 020	-
	4	Washer	-	908 06 020
4	2	Support plate for pump housing	-	D10 70 063
5	8	Insert for pump housing	D10 70 016	D10 70 016
6	2	Pump housing	D10 74 009	D10 74 043
7	2	Diaphragm (NBR) <i>optional</i>	D10 70 035	D10 70 035
		Diaphragm (PTFE/EPDM) <i>optional</i>	D10 70 036	D10 70 036
		Diaphragm (EPDM) <i>optional</i>	D10 70 037	D10 70 037
		Diaphragm (FKM)	D10 70 038	D10 70 038
8	1	Bearing kit with o-rings (item 8.1 – 8.3)	D10 70 200	D10 70 200
8.1	2	Rod seal (PTFE/NBR)	925 39 018	925 39 018
8.2	2	Bearing	D10 70 021	D10 70 021
8.3	4	O-ring Ø30 x 3 (NBR)	925 65 048	925 65 048
9	4	Tension rod	D10 70 031	D10 70 032
10	1	Selector shaft	D10 70 019	D10 70 019
11	2	Silencer	947 15 007	947 15 007
12	1	Coupling	959 13 222	959 13 222
13	4	Ball (NBR) <i>optional</i>	D10 70 001	D10 70 001
		Ball (PTFE) <i>optional</i>	D10 70 003	D10 70 003
		Ball (EPDM) <i>optional</i>	D10 70 004	D10 70 004
		Ball (FKM)	D10 70 002	D10 70 002
14	4	O-ring Ø24 x 2,5 (NBR) <i>optional</i>	925 45 015	925 45 015
		O-ring Ø24 x 2,5 (FFKM) <i>optional</i>	925 45 026	925 45 026
		O-ring Ø24 x 2,5 (EPDM) <i>optional</i>	925 45 017	925 45 017
		O-ring Ø24 x 2,5 (FKM)	925 45 016	925 45 016

Attention: Please always give full description, part no. and quantity of parts required.

This list  
consists of  
3 pages

**FLUX-GERÄTE GMBH D-75433 Maulbronn**

Rights reserved to  
make alterations  
and/or modifications



Spare Parts List Air-operated Diaphragm Pump  
RFM 10 PP / RFM 10 PTFE

Page : 3  
Edition : 04/2008

Item No.	Qty. per unit	Description	Part No. RFM 10 PP	Part No. RFM 10 PTFE
<b>Version according to exploded view</b> <b>No. D10 80 003 – 04/2008</b> <b>valid as from Serial No. RFM00968</b>				
15	4	Ball cage	D10 74 052	D10 74 052
16	1	Manifold, discharge side	D10 74 041	D10 74 042
17	2	Support plate for manifold, discharge side	-	D10 74 064
18	4	Washer	908 06 013	-
20	4	Hexagonal screw	900 81 016	900 81 016
21	1	Air valve part	D10 70 034	D10 70 034
22	1	5/2-way control valve c/w item 22.1. 22.2 and 22.3	D10 70 000	D10 70 000
22.1	1	Profile seal (NBR)	925 89 012	925 89 012
22.2	4	Spring washer	909 75 002	909 75 002
22.3	4	Cylindric screw	900 75 029	900 75 029
25	1	Manifold, suction side	D10 74 006	D10 74 040
26	2	Pedestal	D10 74 017	D10 74 066
27	4	Hexagonal screw	900 81 014	900 81 014
28	4	Ball seat	D10 74 076	D10 74 076
29	4	O-ring Ø19 x 2 (NBR)	925 33 000	925 33 000
		<i>optional</i> O-ring Ø19 x 2 (FEP)	925 33 012	925 33 012
		<i>optional</i> O-ring Ø19 x 2 (EPDM)	925 33 011	925 33 011
		<i>optional</i> O-ring Ø19 x 2 (FKM)	925 33 010	925 33 010
31	8	Hexagonal cap	947 05 055	947 05 055
32	2	Stop ring	D10 74 092	D10 74 092

Attention: Please always give full description, part no. and quantity of parts required.

This list  
consists of  
3 pages

**FLUX-GERÄTE GMBH D-75433 Maulbronn**

Rights reserved to  
make alterations  
and/or modifications