

Corrosion Resistant Models

FP4301-01L

FP4312-08

FP4322-08

FP4332-08

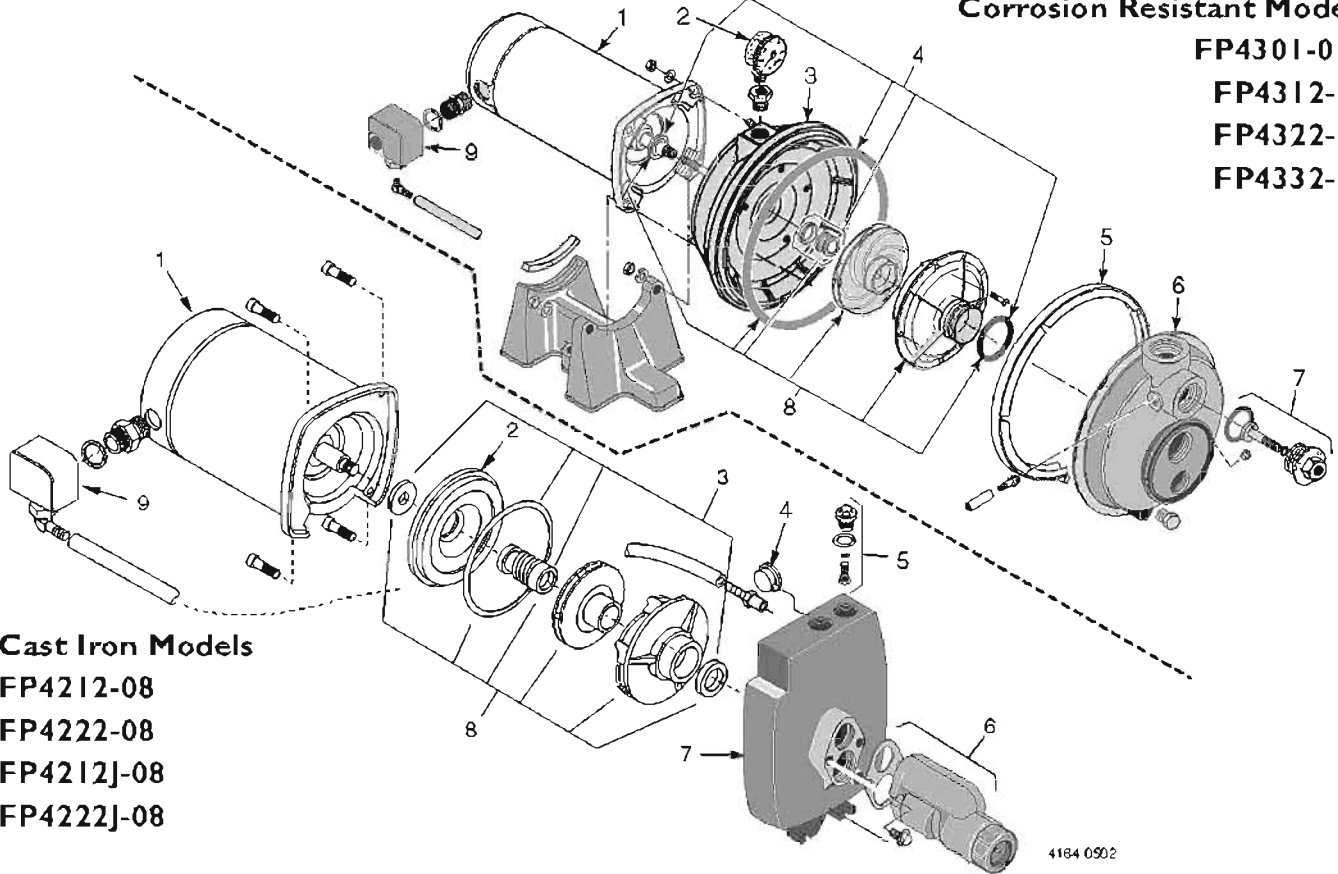

Cast Iron Models

FP4212-08

FP4222-08

FP4212J-08

FP4222J-08

4184 0502

Key No.	Part Description	Model and HP		
		FP4312-08 1/2HP	FP4322-08 3/4HP	FP4332-08 1 HP
1	Motor	AS100CL	A100DL	A100EL
2	Pressure Gauge	TC2104	TC2104	TC2104
3	Pump Body (Back Half)	L176-47P	L176-47P	L176-47P
4	Seal & Gasket Kit *	FPP1500	FPP1500	FPP1500
5	V-Clamp Assembly	C19-54SS	C19-54SS	C19-54SS
6	Pump Body (Front Half)	L76-37P	L76-37P	L76-37P
7	Control Valve Assembly	L162-10PS	L162-10PS	L162-10PS
8	Overhaul Kit **	FPP1511	FPP1512	FPP1513
9	Pressure Switch Assembly	TC2151	TC2151	TC2151

Key No.	Part Description	Model and HP	
		FP4212-08 FP4212J-08# 1/2HP	FP4222-08 FP4222J-08 3/4HP
1	Motor - 60 Cycle	AS100CL	A100DL
2	Seal Plate	N3-1043P	N3-1043P
3	Seal & Gasket Kit *	FPP1550	FPP1550
4	Pressure Gauge	TC2104	TC2104
5	Control Valve Assembly	01322	01322
6	Jet Package***	J198-22	J198-22
7	Pump Body	L76-44	L76-44
8	Overhaul Kit **	FPP1560	FPP1561
9	Pressure Switch	TC2151	TC2151

* Includes: water slinger, seal plate O-ring or gasket, shaft seal, diffuser pad, and diffuser O-ring or gasket.

** Includes: Seal and Gasket Kit plus seal plate insert, impeller and diffuser.

*** FP4212J and FP4222J only. For component part numbers, see the following page.

Included in Models FP4212J15H-04 and FP4212J42-04.

Repair instructions are included with all repair kits.