

**MODEL
2944RP**

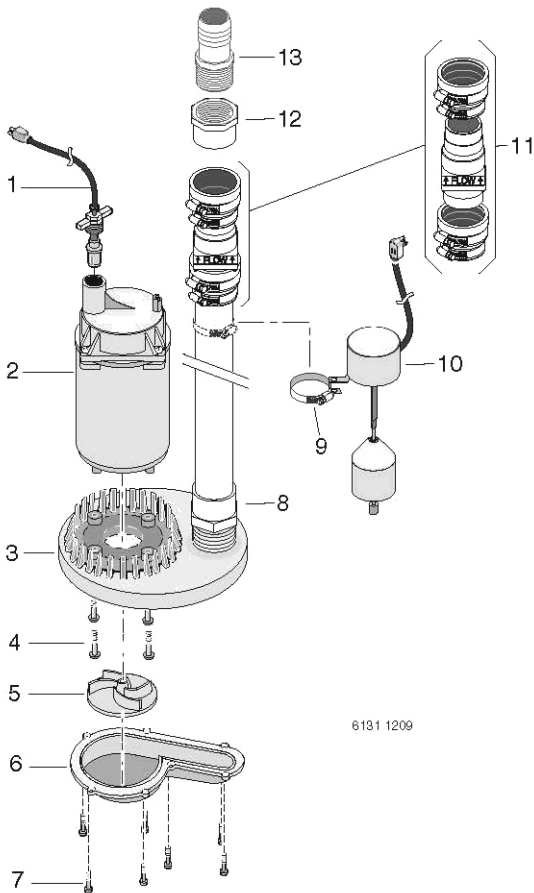

6131 1209

Key No.	Part Description	Qty.	2944RP
1	Power Cord Assembly	1	PS117-54-TSU
2	Motor	1	**
3	Volute (Upper)	1	PS1-31P
4	Screw, #8-32x5/8" Phillips Pan Head	4	†
5	Impeller	1	RP0000911A
6	Volute (Lower)	1	PS1-30P
7	Screw, #8-16x1/2" Lg. Pan Head	7	†
8	1-1/4" NPT x 1-1/4" Slip Adapter	1	†
9	Switch Clamp	1	†
10	Vertical Float Switch Assembly (includes Key No. 9)	1	FPS17-66
11	Check Valve	1	FP0026-10
12	1-1/2" Slip x 1-1/4" NPT Adapter	1	†
13	1-1/4" NPT x 1-1/4" Hose Barb	1	†
•	1-1/4" x 24' Hose Kit (includes Key No. 12)	1	FP0012-6U-P2

** If motor fails, replace entire pump.

† Standard hardware item; purchase locally.

• Not illustrated