

WARNING:
 CANCER AND REPRODUCTIVE HARM -
 WWW.P65WARNINGS.CA.GOV

Item No.	Name of Part	Item No.	Name of Part	Item No.	Name of Part
1A	Lower Half Casing	35	Bearing Cover (Inboard)	212	Stud
1B	Upper Half Casing	37	Bearing Cover (Outboard)	213	Nut
2	Impeller	38	Shaft Sleeve Gasket	215	Cap Screw
6	Pump Shaft	40	Deflector	216	Pipe Plug
* 7	Casing Ring	41	Bearing Cap (Inboard)	231	Pipe Plug
* 8	Impeller Ring	43	Bearing Cap (Outboard)	239	Cap Screws
* 13	Packing	46	Coupling Key	245	Cap Screws
* 14	Shaft Sleeve	47	Lip Seal	246	Dowel Pin
* 16	Ball Bearing (Inboard)	* 65	Mechanical Seal	247	Dowel Pin
17	Split Gland	69	Lock Washer	248	Pet Cock
* 18	Ball Bearing (Outboard)	* 73	Parting Gasket	251	Seal Gland
22	Lock Nut	123	Bearing End Cover	* 259	Seal Gasket
* 29	Lantern Ring	207	Grease Fitting	263	Pipe Plug (Socket Head) when specified
31	Bearing Housing (Inboard)	208	Pipe Plug	296	Set Screw
32	Impeller Key	209	Swing Bolt	304	Pipe Plug
33	Bearing Housing (Outboard)	210	Nut	305	Forsheda Ring
		210B	Washer		

* Recommended spare parts

Repair Parts

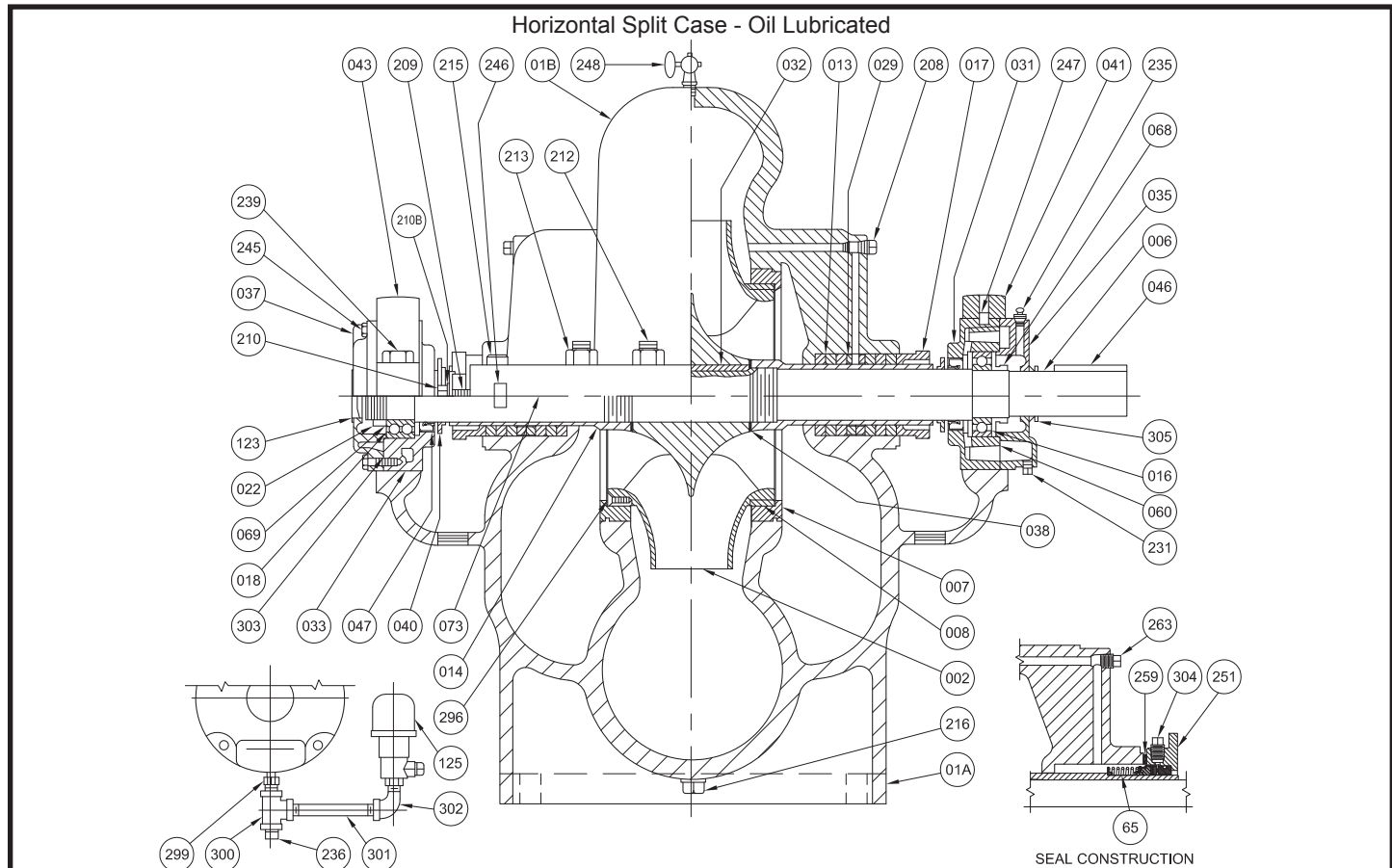

WARNING:
CANCER AND REPRODUCTIVE HARM -
WWW.P65WARNINGS.CA.GOV

Item No.	Name of Part	Item No.	Name of Part	Item No.	Name of Part
1A	Lower Half Casing	40	Deflector	216	Pipe Plug
1B	Upper Half Casing	41	Bearing Cap (Inboard)	231	Pipe Plug
2	Impeller	43	Bearing Cap (Outboard)	235	Vent
6	Pump Shaft	46	Coupling Key	239	Cap Screw
* 7	Casing Ring	47	Lip Seal	245	Cap Screw
* 8	Impeller Ring	60	Oil Ring	246	Dowel Pin
* 13	Packing	* 65	Mechanical Seal	247	Dowel Pin
* 14	Shaft Sleeve	68	Shaft Collar	248	Pet Cock
* 16	Ball Bearing (Inboard)	69	Lockwasher	251	Seal Gland
17	Split Gland	* 73	Parting Gasket	* 259	Seal Gasket
* 18	Ball Bearing (Outboard)	123	Bearing End Cover	263	Pipe Plug (Socket Head) when specified
22	Lock Nut	125	Oiler	296	Set Screw
* 29	Lantern Ring	208	Pipe Plug	299	Nipple Reducing
31	Bearing Housing (Inboard)	209	Swing Bolt	300	Tee
32	Impeller Key	210	Nut	301	Nipple
33	Bearing Housing (Outboard)	210B	Washer	302	Street Elbow
35	Bearing Cover (Inboard)	212	Stud	303	Bearing Cover Gasket
37	Bearing Cover (Outboard)	213	Nut	304	Pipe Plug
38	Shaft Sleeve Gasket	215	Cap Screw	305	Forsheda Ring

* Recommended spare parts

Repair Parts

Item No.	Name and Description	2 x 1½ x 8 Part No.	3 x 2 x 8 Part No.	3 x 2 x 11 Part No.	3 x 2 x 14 Part No.	4 x 3 x 9 Part No.
1	Casing Assembly Bronze Fitted and All Iron	0061150	0057760	0053001	0053003	0053005
	NOTE: Casing Assembly includes upper and lower half casing, bearing caps, parting gasket, air cock, dowel pins, cap screws, studs, and nuts plus all other hardware to make up complete casing assembly. New name plate with duplicate serial number of original pump will also be furnish if requested.					
2	Impeller - Code	1615	2215	2235	2255	3125
	Cast Iron	0058627	0055972	0053734	0053738	0046093
	#8 Bronze	0058629	0055974	0053736	0053740	0046095
	Impeller - Code		2212	2232	2256	
	Cast Iron		0058627	0058693	0066304	
	#8 Bronze		0058629	0058695	0066306	
6	Pump Shaft - Current Design					
	Right Hand - 4140 Steel	0104574	0104574	0104574	0104574	0104574
	Right Hand - 316 SS	0104575	0104575	0104575	0104575	0104575
	Right Hand - 416 SS	0104576	0104576	0104576	0104576	0104576
	Left Hand - 4140 Steel	0104577	0104577	0104577	0104577	0104577
	Left Hand - 316 SS	0104578	0104578	0104578	0104578	0104578
	Left Hand - 416 SS	0104579	0104579	0104579	0104579	0104579
	Double Ended - 4140 Steel	0104580	0104580	0104580	0104580	0104580
	Double Ended - 316 SS	0104581	0104581	0104581	0104581	0104581
Double Ended - 416 SS	0104582	0104582	0104582	0104582	0104582	
(4) 6	Pump Shaft - Previous Design					
	Right Hand - 4140 Steel	0058393	0058393	0058393	0058393	0058393
	Right Hand - 316 SS	0093470	0093470	0093470	0093470	0093470
	Right Hand - 416 SS	0059691	0059691	0059691	0059691	0059691
	Left Hand - 4140 Steel	0058391	0058391	0058391	0058391	0058391
	Left Hand - 316 SS	0093472	0093472	0093472	0093472	0093472
	Left Hand - 416 SS	0059692	0059692	0059692	0059692	0059692
	Double Ended - 4140 Steel	0058395	0058395	0058395	0058395	0058395
	Double Ended - 316 SS	0093474	0093474	0093474	0093474	0093474
Double Ended - 416 SS	0059693	0059693	0059693	0059693	0059693	
* 7	Casing Wear Ring (2 Req'd) Pump without Imp. Wear Rings					
	Cast Iron	0054253	0054253	0054253	0054253	0046166
	#5 Bronze	0054255	0054255	0054255	0054255	0046168
	Casing Wear Ring (2 Req'd) Pump with Imp. Wear Rings					
	Cast Iron	0046166	0046166	0046166	0046166	0048429
	#5 Bronze	0046168	0046168	0046168	0046168	0048430
* 8	Impeller Wear Ring (2 Req'd)					
	Cast Iron	0054247	0054247	0054247	0054247	0048427
	#8 Bronze	0054249	0054249	0054249	0054249	0048428
* 13	Regular Packing Rings	0046662	0046662	0046662	0046662	0046662
	Graphite (10 Req'd)					
* 13A	Special Packing Rings with Lantern Ring: Center Ring	0065691	0065691	0065691	0065691	0065691
	0058292 (10 Req'd) Special Packing Rings without Lantern Ring: Center Ring	0065692	0065692	0065692	0065692	0065692
	0058292 (10 Req'd)					

* Recommended spare parts



PUMPS & SYSTEMS

SECTION 95
PAGE 197
DATE 7/15

Repair Parts

Item No.	Name and Description	2 x 1½ x 8 Part No.	3 x 2 x 8 Part No.	3 x 2 x 11 Part No.	3 x 2 x 14 Part No.	4 x 3 x 9 Part No.
* 14 R	Shaft Sleeve - R.H. - Packed Box #660 Bronze 440 C SS 416 SS 316 SS	0060893 0049994 0063471 0060895	0060893 0049994 0063471 0060895	0060893 0049994 0063471 0060895	0060893 0049994 0063471 0060895	0060893 0049994 0063471 0060895
* 14 L	Shaft Sleeve - L.H. - Packed Box #660 Bronze 440 C SS 416 SS 316 SS	0060889 0049995 0063473 0060891	0060889 0049995 0063473 0060891	0060889 0049995 0063473 0060891	0060889 0049995 0063473 0060891	0060889 0049995 0063473 0060891
* 14 R	Shaft Sleeve - R.H. - Type 21 Seal #660 Bronze 416 SS 316 SS	0061026 0061028 0061027	0061026 0061028 0061027	0061026 0061028 0061027	0061026 0061028 0061027	0061026 0061028 0061027
* 14 L	Shaft Sleeve - L.H. - Type 21 Seal #660 Bronze 416 SS 316 SS	0061022 0061024 0061023	0061022 0061024 0061023	0061022 0061024 0061023	0061022 0061024 0061023	0061022 0061024 0061023
* 16 17	Ball Bearing - Inboard Packing Gland Assy. (2 Req'd) Steel 316 SS	0058468 0046132 0046135	0058468 0046132 0046135	0058468 0046132 0046135	0058468 0046132 0046135	0058468 0046132 0046135
* 18	Ball Bearing - Outboard	0039990	0039990	0039990	0039990	0039990
22	Bearing Lock Nut Grease Lubricated	0006031	0006031	0006031	0006031	0006031
22	Bearing Lock Nut (2 Req'd) Oil Lubricated	0055350	0055350	0055350	0055350	0055350
29	Lantern Ring Half (4 Req'd)	0101624	0101624	0101624	0101624	0101624
31 33	Bearing Housing - Current Design Inboard - C.I. Outboard - C.I.	0104570 0104572	0104570 0104572	0104570 0104572	0104570 0104572	0104570 0104572
31 33	Bearing Housing - Previous Design Inboard - C.I. Outboard - C.I.	0058389 0046120	0058389 0046120	0058389 0046120	0058389 0046120	0058389 0046120
32	Impeller Key - 3/16" Sq. x 1½" Steel	0002195	0002195	0002195	0002195	0002195
35 37	Bearing Cover - Grease Lube Inboard - C.I. Outboard - C.I.	0058406 0046112	0058406 0046112	0058406 0046112	0058406 0046112	0058406 0046112
35 37	Bearing Cover - Oil Lube Inboard - C.I. Outboard - C.I.	0058410 0055357	0058410 0055357	0058410 0055357	0058410 0055357	0058410 0055357
38	Shaft Sleeve Gasket (2 Req'd)	0077236	0077236	0077236	0077236	0077236
40	Deflector - Current Design Neoprene (2 Req'd)	0000705	0000705	0000705	0000705	0000705
40	Deflector - Previous Design Inboard - C.I. Inboard - #8 Bronze	0058387 0058388	0058387 0058388	0058387 0058388	0058387 0058388	0058387 0058388
41 & 43	Bearing Cap - C.I. (2 Req'd) #8 Bronze (2 Req'd) NOTE: 14 Shimms are required to fit bearing caps.	0066185 0066186 0071914	0066185 0066186 0071914	0066185 0066186 0071914	0066185 0066186 0071914	0066185 0066186 0071914
46	Coupling Key - 3/16" Sq. x 2" Steel	0002197	0002197	0002197	0002197	0002197
47	Lip Seal - Current Design (2 Req'd)	0104860	0104860	0104860	0104860	0104860

* Recommended spare parts

Repair Parts

Item No.	Name and Description	2 x 1½ x 8 Part No.	3 x 2 x 8 Part No.	3 x 2 x 11 Part No.	3 x 2 x 14 Part No.	4 x 3 x 9 Part No.
47	Deflector - Previous Design Outboard - C.I.	0046109	0046109	0046109	0046109	0046109
60	Outboard - #8 Bronze Oil Ring - Steel (2 Req'd)	0046110 0055346	0046110 0055346	0046110 0055346	0046110 0055346	0046110 0055346
* 65 & 80	Seal - Single Type 21 (2 Req'd) Brz. Fitted & All Brz. - BF1C1 All Iron - BF171	0065187 0065188	0065187 0065188	0065187 0065188	0065187 0065188	0065187 0065188
68	Shaft Collar - Steel	0058412	0058412	0058412	0058412	0058412
69	Bearing Lock Washer - Steel	0039992	0039992	0039992	0039992	0039992
* 73	Parting Gasket - B10 Velcar	0054008	0054008	0052025	0052566	0046512
123	Bearing End Cover - Tin Plate	0045796	0045796	0045796	0045796	0045796
125	Oiler - ¼" Trico E52	0075699	0075699	0075699	0075699	0075699
207	Grease Fitting - ½" (2 Req'd)	0003131	0003131	0003131	0003131	0003131
208	Pipe Plug - ¼" For item 1 Cad Plated (6 Req'd) Brass (6 Req'd)	0002009 0000019	0002009 0000019	0002009 0000019	0002009 0000019	0002009 0000019
208A	Grease Fitting - ¼" (2 Req'd) For Item 13A when needed	0002640	0002640	0002640	0002640	0002640
209	Swing Bolts - SS (4 Req'd)	0105351	0105351	0105351	0105351	0105351
210	Hex Nuts ¾" For Item 209 Steel (4 Req'd) Brass (4 Req'd)	15-23-6 05536	15-23-6 05536	15-23-6 05536	15-23-6 05536	15-23-6 05536
210B	Washer - For item 209 Steel (4 Req'd)	131831	131831	131831	131831	131831
212	Stud ½" x 1¼" Steel (8 Req'd) 316 SS (8 Req'd)	0000582 0006751	0000582 0006751	0000582 0006751	0000582 0006751	0000582 0006751
213	Hex Nuts ½" For Item 212 Steel (8 Req'd) Brass (8 Req'd)	0001179 0005967	0001179 0005967	0001179 0005967	0001179 0005967	0001179 0005967
215	Cap Screws - For Item 209 Steel - (4 Req'd) 316 SS (4 Req'd)	Q15-122-E11 0046427	Q15-122-E11 0046427	Q15-122-E11 0046427	Q15-122-E11 0046427	Q15-122-E11 0046427
216	Pipe Plugs - For Item 1 Drain Galv. (2 Req'd) Brass (2 Req'd)	0002009 0000019	0002009 0000019	0002009 0000019	0002009 0000019	0002009 0000019
231	Pipe Plugs - ½" Cad. Plated For Items 35 & 37 (2 Req'd)	0002553	0002553	0002553	0002553	0002553
235	Vent - ½" Alemite (2 Req'd)	0039022	0039022	0039022	0039022	0039022
236	Pipe Plug - ¼" (2 Req'd) For Item 300	0002009	0002009	0002009	0002009	0002009
239	Cap Screws ½" x 1¼" Steel For Items 41 & 43 (4 Req'd)	0000437	0000437	0000437	0000437	0000437
245	Cap Screws #10 - 32 x ¾" Steel For Items 35 & 37 (8 Req'd)	0039987	0039987	0039987	0039987	0039987
246	Dowel Pin - ½" x 1" Steel For Item 41 & 43 (2 Req'd)	0006206	0006206	0006206	0006206	0006206
247	Dowel Pin - ¼" x ¾" Steel For Item 1 (2 Req'd)	0003230	0003230	0003230	0003230	0003230
248	Air Cock - ¼" Brass	0005650	0005650	0005650	0005650	0005650
251	Seal Gland (2 Req'd) Cast Iron #8 Bronze	0049955 0049957	0049955 0049957	0049955 0049957	0049955 0049957	0049955 0049957
* 259	Seal Gasket - Vellutex (2 Req'd)	0049962	0049962	0049962	0049962	0049962
263	Pipe Plug - ½" Socket Head SS (2 Req'd)	0049464	0049464	0049464	0049464	0049464
296	Set Screws - SS (12 Req'd) For Impeller Wear Rings	0033444	0033444	0033444	0033444	0033444

* Recommended spare parts

Repair Parts

Item No.	Name and Description	2 x 1½ x 8 Part No.	3 x 2 x 8 Part No.	3 x 2 x 11 Part No.	3 x 2 x 14 Part No.	4 x 3 x 9 Part No.
299	Nipple Red. Brass (2 req'd)	0104431	0104431	0104431	0104431	0104431
300	Tee - ¼" Galv. (2 Req'd)	0007029	0007029	0007029	0007029	0007029
301	Nipple - ¼" x 4 Galv. (2 Req'd)	0000925	0000925	0000925	0000925	0000925
302	St. Elbow - ¼" Galv. (2 Req'd)	0001807	0001807	0001807	0001807	0001807
* 303	Bearing Cover Gasket (2 Req'd)	0055354	0055354	0055354	0055354	0055354
304	Pipe Plug (2 Req'd)					
	Cad. Plated	0002009	0002009	0002009	0002009	0002009
	Brass	0000019	0000019	0000019	0000019	0000019
305	Forsheda Ring	0105291	0105291	0105291	0105291	0105291
(1)	Complete Rotating Assembly Consists of a complete pump less the casing assembly					
	Bronze Fitted	0061202	0061204	0061206	0061208	0061210
	All Iron	0061203	0061205	0061207	0061209	0061211
<p>NOTE: (1) The assembly numbers include standard casing and impeller wearing ring where applicable, right hand carbon steel shaft, grease lubricated bearings, standard sleeves and packing. (2) When ordering Rotating Assemblies, always add parting gasket, item 73. (3) Pump Serial Number must be furnished when ordering repair parts. (4) When ordering Previous Part item 6, the following kits will be supplied consisting of Current Design Items 6, 31, 33, 40 and 47.</p>						
6	Pump Shaft - Previous Design	Shaft P/N	Kit P/N			
	Right Hand - 4140 Steel	0058393	0104944			
	Right Hand - 316 SS	0093470	0104945			
	Right Hand - 416 SS	0059691	0104946			
	Left Hand - 4140 Steel	0058391	0104947			
	Left Hand - 316 SS	0093472	0104948			
	Left Hand - 416 SS	0059692	0104949			
	Double Ended - 4140 Steel	0059395	0104950			
	Double Ended - 316 SS	0093474	0104951			
	Double Ended - 416 SS	0059693	0104952			
Parts Intrinsic to Vertical Mount Construction						
	Previous Design:					
	Bearing Housing - C.I.					
31	Inboard	0074660	0074660	0074660	0074660	0074660
33	Outboard	0074754	0074754	0074754	0074754	0074754
35	Bearing Cover - Inboard - C.I.	0076769	0076769	0076769	0076769	0076769
127	Recirculation Line Assembly	0086856	0086856	0086856	0086856	0086856
169	Lip Seal - For Item 31 & 33 (2 req'd)	0074671	0074671	0074671	0074671	0074671
169a	Lip Seal - For Item 35	0074670	0074670	0074670	0074670	0074670
	Current Design:					
	Same as Horizontal with Item No. 127					

* Recommended spare parts

Repair Parts

Item No.	Name and Description	4 x 3 x 11 Part No.	4 x 3 x 14 Part No.	4 x 3 x 17 Part No.	6 x 4 x 9 Part No.	6 x 4 x 12 Part No.	6 x 4 x 14½ Part No.	8 x 6 x 9 Part No.
1	Casing Assembly Bronze Fitted and All Iron	0061158	0053007	0070142	0053009	0053011	0053013	0053015
	NOTE: Casing Assembly includes upper and lower half casing, bearing caps, parting gasket, air cock, dowel pins, cap screws, studs, and nuts plus all other hardware to make up complete casing assembly. New name plate with duplicate serial number of original pump will also be furnish if requested.							
2	Impeller - Code Cast Iron #8 Bronze Impeller - Code Cast Iron #8 Bronze	3135 0060853 0060855	3155 0045372 0110562	3175 0069548 0070066	4225 0046035 0045037 4223 0075580 0075582	4245 0045376 0115599	4265 0046049 0046051	6125 0054464 0054466
6	Pump Shaft - Current Design Right Hand - 4140 Steel Right Hand - 316 SS Right Hand - 416 SS Left Hand - 4140 Steel Left Hand - 316 SS Left Hand - 416 SS Double Ended - 4140 Steel Double Ended - 316 SS Double Ended - 416 SS	0104701 0104702 0104703 0104704 0104705 0104706 0104687 0104688 0104689	0104701 0104702 0104703 0104704 0104705 0104706 0104687 0104688 0104689	0104701 0104702 0104703 0104704 0104705 0104706 0104687 0104688 0104689	0104701 0104702 0104703 0104704 0104705 0104706 0104687 0104688 0104689	0104701 0104702 0104703 0104704 0104705 0104706 0104687 0104688 0104689	0104701 0104702 0104703 0104704 0104705 0104706 0104687 0104688 0104689	0104701 0104702 0104703 0104704 0104705 0104706 0104687 0104688 0104689
(4) 6	Pump Shaft - Previous Design Right Hand - 4140 Steel Right Hand - 316 SS Right Hand - 416 SS Left Hand - 4140 Steel Left Hand - 316 SS Left Hand - 416 SS Double Ended - 4140 Steel Double Ended - 316 SS Double Ended - 416 SS	0093537 0087364 0088467 0093538 0055518 0093539 0093540 0093541 0093542	0093537 0087364 0088467 0093538 0055518 0093539 0093540 0093541 0093542	0093537 0087364 0088467 0093538 0055518 0093539 0093540 0093541 0093542	0093537 0087364 0088467 0093538 0055518 0093539 0093540 0093541 0093542	0093537 0087364 0088467 0093538 0055518 0093539 0093540 0093541 0093542	0093537 0087364 0088467 0093538 0055518 0093539 0093540 0093541 0093542	0093537 0087364 0088467 0093538 0055518 0093539 0093540 0093541 0093542
* 7	Casing Wear Ring (2 Req'd) Pump without Imp. Wear Rings Cast Iron #5 Bronze Casing Wear Ring (2 Req'd) Pump with Imp. Wear Rings Cast Iron #5 Bronze	0044333 0044335 0047429 0047431	0044333 0044335 0047429 0047431	0044333 0044335 0047429 0047431	0047429 0047431 0048560 0048561	0044058 0044060 0044239 0044241	0044058 0044060 0044239 0044241	0044239 0044241 0044380 0044381
* 8	Impeller Wear Ring (2 Req'd) Cast Iron #8 Bronze	0060851 0060852	0060851 0060852	0060851 0060852	0048558 0048559	0045892 0045894	0045892 0045894	0044378 0044379
* 13	Regular Packing Rings Graphite (10 Req'd)	0041822	0041822	0041822	0041822	0041822	0041822	0041822
* 13A	Special Packing Rings with Lantern Ring: Center Ring 0058294 (10 Req'd) Special Packing Rings without Lantern Ring: Center Ring 0058294 (10 Req'd)	0065694 0065695	0065694 0065695	0065694 0065695	0065694 0065695	0065694 0065695	0065694 0065695	0065694 0065695

* Recommended spare parts



A Crane Co. Company

PUMPS & SYSTEMS

USA: (937) 778-8947 • Canada: (905) 457-6223 • International: (937) 615-3598

SECTION	95
PAGE	201
DATE	7/15

Repair Parts

Item No.	Name and Description	4 x 3 x 11 Part No.	4 x 3 x 14 Part No.	4 x 3 x 17 Part No.	6 x 4 x 9 Part No.	6 x 4 x 12 Part No.	6 x 4 x 14½ Part No.	8 x 6 x 9 Part No.
* 14 R	Shaft Sleeve - R.H. - Packed Box #660 Bronze 440 C SS 416 SS 316 SS	0060906 0049996 0060908 0060910	0060906 0049996 0060908 0060910	0060906 0049996 0060908 0060910	0060906 0049996 0060908 0060910	0060906 0049996 0060908 0060910	0060906 0049996 0060908 0060910	0060906 0049996 0060908 0060910
* 14 L	Shaft Sleeve - L.H. - Packed Box #660 Bronze 440 C SS 416 SS 316 SS	0060911 0049997 0060913 0060915	0060911 0049997 0060913 0060915	0060911 0049997 0060913 0060915	0060911 0049997 0060913 0060915	0060911 0049997 0060913 0060915	0060911 0049997 0060913 0060915	0060911 0049997 0060913 0060915
* 14 R	Shaft Sleeve - R.H. - Type 21 Seal #660 Bronze 416 SS 316 SS	0061034 0061036 0061035	0061034 0061036 0061035	0061034 0061036 0061035	0061034 0061036 0061035	0061034 0061036 0061035	0061034 0061036 0061035	0061034 0061036 0061035
* 14 L	Shaft Sleeve - L.H. - Type 21 Seal #660 Bronze 416 SS 316 SS	0061030 0061032 0061031	0061030 0061032 0061031	0061030 0061032 0061031	0061030 0061032 0061031	0061030 0061032 0061031	0061030 0061032 0061031	0061030 0061032 0061031
* 16 17	Ball Bearing - Inboard Packing Gland Assy. (2 Req'd) Steel 316 SS	0005124 0044028 0044032	0005124 0044028 0044032	0005124 0044028 0044032	0005124 0044028 0044032	0005124 0044028 0044032	0005124 0044028 0044032	0005124 0044028 0044032
* 18	Ball Bearing - Outboard	0003306	0003306	0003306	0003306	0003306	0003306	0003306
22	Bearing Lock Nut Grease Lubricated	0003304	0003304	0003304	0003304	0003304	0003304	0003304
22	Bearing Lock Nut (2 Req'd) Oil Lubricated	0055351	0055351	0055351	0055351	0055351	0055351	0055351
29	Lantern Ring Half (4 Req'd)	0101625	0101625	0101625	0101625	0101625	0101625	0101625
31 33	Bearing Housing - Current Design Inboard - C.I. Outboard - C.I.	0104708 0104708	0104708 0104708	0104708 0104708	0104708 0104708	0104708 0104708	0104708 0104708	0104708 0104708
31 33	Bearing Housing - Previous Design Inboard - C.I. Outboard - C.I.	0044689 0044689	0044689 0044689	0044689 0044689	0044689 0044689	0044689 0044689	0044689 0044689	0044689 0044689
32	Impeller Key - ¼" Sq. x 2½" Steel	0002207	0002207	0002207	0002207	0002207	0002207	0002207
35 37	Bearing Cover - Grease Lube Inboard - C.I. Outboard - C.I.	0044687 0044687	0044687 0044687	0044687 0044687	0044687 0044687	0044687 0044687	0044687 0044687	0044687 0044687
35 37	Bearing Cover - Oil Lube Inboard - C.I. Outboard - C.I.	0055359 0055359	0055359 0055359	0055359 0055359	0055359 0055359	0055359 0055359	0055359 0055359	0055359 0055359
38	Shaft Sleeve Gasket (2 Req'd)	0077410	0077410	0077410	0077410	0077410	0077410	0077410
40	Deflector - Current Design Neoprene (2 Req'd)	0000708	0000708	0000708	0000708	0000708	0000708	0000708
40	Deflector - Current Design Inboard - C.I. Inboard - #8 Bronze	0044023 0044025	0044023 0044025	0044023 0044025	0044023 0044025	0044023 0044025	0044023 0044025	0044023 0044025
41 & 43	Bearing Cap - C.I. (2 Req'd) #8 Bronze (2 Req'd) NOTE: 14 Shims are required to fit bearing caps.	0066187 0066188 0071914	0066187 0066188 0071914	0066187 0066188 0071914	0066187 0066188 0071914	0066187 0066188 0071914	0066187 0066188 0071914	0066187 0066188 0071914
46	Coupling Key - ¼" Sq. x 2¼" Steel	0002206	0002206	0002206	0002206	0002206	0002206	0002206
47	Lip Seal - Current Design (2 Req'd)	0104861	0104861	0104861	0104861	0104861	0104861	0104861

* Recommended spare parts

Repair Parts

Item No.	Name and Description	4 x 3 x 11 Part No.	4 x 3 x 14 Part No.	4 x 3 x 17 Part No.	6 x 4 x 9 Part No.	6 x 4 x 12 Part No.	6 x 4 x 14½ Part No.	8 x 6 x 9 Part No.
47	Deflector - Previous Design Outboard - C.I.	0044027	0044027	0044027	0044027	0044027	0044027	0044027
60	Outboard - #8 Bronze Oil Ring - Steel (2 Req'd)	0044323 0055347	0044323 0055347	0044323 0055347	0044323 0055347	0044323 0055347	0044323 0055347	0044323 0055347
* 65 & 80	Seal - Single Type 21 (2 Req'd) Brz. Fitted & All Brz. - BF1C1 All Iron - BF171	0030884 0030885	0030884 0030885	0030884 0030885	0030884 0030885	0030884 0030885	0030884 0030885	0030884 0030885
68	Shaft Collar - Steel	0055343	0055343	0055343	0055343	0055343	0055343	0055343
69	Bearing Lock Washer - Steel	0003300	0003300	0003300	0003300	0003300	0003300	0003300
* 73	Parting Gasket - B10 Velcar	0060857	0044693	0065619	0045859	0044795	0045825	0052024
123	Bearing End Cover - Tin Plate	0045797	0045797	0045797	0045797	0045797	0045797	0045797
125	Oiler - ¼" Trico E52	0075699	0075699	0075699	0075699	0075699	0075699	0075699
207	Grease Fitting - ¼" (2 Req'd)	0003131	0003131	0003131	0003131	0003131	0003131	0003131
208	Pipe Plug - ¼" For item 1 Cad Plated (6 Req'd) Brass (6 Req'd)	0002009 0000019	0002009 0000019	0002009 0000019	0002009 0000019	0002009 0000019	0002009 0000019	0002009 0000019
208A	Grease Fitting - ¼" (2 Req'd) For Item 13A when needed	0002640	0002640	0002640	0002640	0002640	0002640	0002640
209	Swing Bolts - SS (4 Req'd)	0105351	0105351	0105351	0105351	0105351	0105351	0105351
210	Hex Nuts ¾" For Item 209 Steel Brass	15-23-6 05536	15-23-6 05536	15-23-6 05536	15-23-6 05536	15-23-6 05536	15-23-6 05536	15-23-6 05536
210B	Washer - For item 209 Steel (4 Req'd)	131831	131831	131831	131831	131831	131831	131831
212	Stud ½" x 2" Steel 316 SS	0000584 0041804	0000584 0041804	0000584 0041804	0000584 0041804	0000584 0041804	0000584 0041804	0000584 0041804
213	Hex Nuts ½" For Item 212 Steel Brass	0001179 0005967	0001179 0005967	0001179 0005967	0001179 0005967	0001179 0005967	0001179 0005967	0001179 0005967
215	Cap Screws - For Item 209 Steel - (4 Req'd) 316 SS (4 Req'd)	Q15-387-E11 0046429	Q15-387-E11 0046429	Q15-155-E11 0046429	Q15-386-E11 0046429	Q15-387-E11 0046429	Q15-386-E11 0046429	Q15-387-E11 0046429
216	Pipe Plugs - For Item 1 Drain Galv. (2 Req'd) Brass (2 Req'd)	0006223 0006238	0006223 0006238	0006223 0006238	0006224 0006238	0006224 0006238	0006224 0006238	0006224 0006238
231	Pipe Plugs - ½" Cad. Plated For Items 35 & 37 (2 Req'd)	0002553	0002553	0002553	0002553	0002553	0002553	0002553
235	Vent - ½" Alemite (2 Req'd)	0039022	0039022	0039022	0039022	0039022	0039022	0039022
236	Pipe Plug - ¼" (2 Req'd) For Item 300	0002009	0002009	0002009	0002009	0002009	0002009	0002009
239	Cap Screws ½" x 1¼" Steel For Items 41 & 43 (4 Req'd)	0000437	0000437	0000437	0000437	0000437	0000437	0000437
245	Cap Screws #10 - 32 x ⅝" Steel For Items 35 & 37 (8 Req'd)	0068361	0068361	0068361	0068361	0068361	0068361	0068361
246	Dowel Pin - ½" x 1" Steel For Item 41 & 43 (2 Req'd)	0006206	0006206	0006206	0006206	0006206	0006206	0006206
247	Dowel Pin - ⅜" x ¾" Steel For Item 1 (2 Req'd)	0006204	0006204	0006204	0006204	0006204	0006204	0006204
248	Air Cock - ¼" Brass	0005650	0005650	0005650	0005650	0005650	0005650	0005650
251	Seal Gland (2 Req'd) Cast Iron #8 Bronze	0045762 0045764	0045762 0045764	0045762 0045764	0045762 0045764	0045762 0045764	0045762 0045764	0045762 0045764
* 259	Seal Gasket - Vellutec (2 Req'd)	0046386	0046386	0046386	0046386	0046386	0046386	0046386
263	Pipe Plug - ⅜" Socket Head SS (2 Req'd)	0049464	0049464	0049464	0049464	0049464	0049464	0049464
296	Set Screws - SS (12 Req'd) For Impeller Wear Rings	0065282	0065282	0065282	0065282	0065282	0065282	0065282

* Recommended spare parts



Parts for Fig. 5062

Industrial Section 29
Bulletin 95

DEMING®

www.cranepumps.com

Repair Parts

Item No.	Name and Description	4 x 3 x 11 Part No.	4 x 3 x 14 Part No.	4 x 3 x 17 Part No.	6 x 4 x 9 Part No.	6 x 4 x 12 Part No.	6 x 4 x 14½ Part No.	8 x 6 x 9 Part No.
299	Nipple Red. Brass (2 req'd)	0104431	0104431	0104431	0104431	0104431	0104431	0104431
300	Tee - ¼" Galv. (2 Req'd)	0007029	0007029	0007029	0007029	0007029	0007029	0007029
301	Nipple - ¼" x 4 Galv. (2 Req'd)	0000927	0000927	0000927	0000927	0000927	0000927	0000927
302	St. Elbow - ¼" Galv. (2 Req'd)	0001807	0001807	0001807	0001807	0001807	0001807	0001807
* 303	Bearing Cover Gasket (2 Req'd)	0055355	0055355	0055355	0055355	0055355	0055355	0055355
304	Pipe Plug (2 Req'd)							
	Cad. Plated	0002009	0002009	0002009	0002009	0002009	0002009	0002009
	Brass	0000019	0000019	0000019	0000019	0000019	0000019	0000019
305	Forsheda Ring	0105292	0105292	0105292	0105292	0105292	0105292	0105292
(1)	Complete Rotating Assembly Consists of a complete pump less the casing assembly							
	Bronze Fitted	0061212	0061214	0070150	0061216	0061218	0061220	0061222
	All Iron	0061213	0061215	0070151	0061217	0061219	0061221	0061223
<p>NOTE: (1) The assembly numbers include standard casing and impeller wearing ring where applicable, right hand carbon steel shaft, grease lubricated bearings, standard sleeves and packing. (2) When ordering Rotating Assemblies, always add parting gasket, item 73. (3) Pump Serial Number must be furnished when ordering repair parts. (4) When ordering Previous Part item 6, the following kits will be supplied consisting of Current Design Items 6, 31, 33, 40 and 47.</p>								
6	Pump Shaft - Previous Design	Shaft P/N	Kit P/N					
	Right Hand - 4140 Steel	0093537	0104953					
	Right Hand - 316 SS	0087364	0104954					
	Right Hand - 416 SS	0088467	0104955					
	Left Hand - 4140 Steel	0093538	0104956					
	Left Hand - 316 SS	0055518	0104957					
	Left Hand - 416 SS	0093539	0104958					
	Double Ended - 4140 Steel	0093540	0104959					
	Double Ended - 316 SS	0093541	0104960					
	Double Ended - 416 SS	0093542	0104961					
Parts Intrinsic to Vertical Mount Construction								
	Previous Design:							
	Bearing Housing - C.I.							
31	Inboard	0074733	0074733	0074733	0074733	0074733	0074733	0074733
33	Outboard	0074733	0074733	0074733	0074733	0074733	0074733	0074733
35	Bearing Cover - Inboard - C.I.	0074734	0074734	0074734	0074734	0074734	0074734	0074734
127	Recirculation Line Assembly	0086856	0086856	0086856	0086856	0086856	0086856	0086856
169	Lip Seal - For Item 31 & 33 (2 req'd)	0074638	0074638	0074638	0074638	0074638	0074638	0074638
169a	Lip Seal - For Item 35	0074639	0074639	0074639	0074639	0074639	0074639	0074639
	Current Design:							
	Same as Horizontal with Item No. 127							

* Recommended spare parts

SECTION 95
PAGE 204
DATE 7/08

CRANE®

A Crane Co. Company

PUMPS & SYSTEMS

USA: (937) 778-8947 • Canada: (905) 457-6223 • International: (937) 615-3598

Repair Parts

Item No.	Name and Description	6 x 4 x 17 Part No.	8 x 6 x 12 Part No.	8 x 6 x 14½ Part No.	8 x 6 x 17 Part No.	10 x 8 x 12 Part No.	10 x 8 x 14½ Part No.
1	Casing Assembly Bronze Fitted and All Iron	0053017	0053019	0061166	0053021	0053023	0060308
	NOTE: Casing Assembly includes upper and lower half casing, bearing caps, parting gasket, air cock, dowel pins, cap screws, studs, and nuts plus all other hardware to make up complete casing assembly. New name plate with duplicate serial number of original pump will also be furnish if requested.						
2	Impeller - Code Cast Iron Silicone Bronze Impeller - Code Cast Iron #8 Bronze	4275 0045252 0045254	6145 0045337 0045339 6142 0045380 0045382	6165 0061086 0061088	6178 0061091 0061092	8145 0045388 0045390	8165 0068744 0115603
6	Pump Shaft - Current Design Right Hand - 4140 Steel Right Hand - 316 SS Right Hand - 416 SS Left Hand - 4140 Steel Left Hand - 316 SS Left Hand - 416 SS Double Ended - 4140 Steel Double Ended - 316 SS Double Ended - 416 SS	0104721 0104722 0104723 0104741 0104742 0104743 0104719 0104717 0104718	0104721 0104722 0104723 0104741 0104742 0104743 0104719 0104717 0104718	0104721 0104722 0104723 0104741 0104742 0104743 0104719 0104717 0104718	0104721 0104722 0104723 0104741 0104742 0104743 0104719 0104717 0104718	0104721 0104722 0104723 0104741 0104742 0104743 0104719 0104717 0104718	0104721 0104722 0104723 0104741 0104742 0104743 0104719 0104717 0104718
(4) 6	Pump Shaft - Previous Design Right Hand - 4140 Steel Right Hand - 316 SS Right Hand - 416 SS Left Hand - 4140 Steel Left Hand - 316 SS Left Hand - 416 SS Double Ended - 4140 Steel Double Ended - 316 SS Double Ended - 416 SS	0093546 0091793 0093547 0089864 0093548 0093549 0093550 0093551 0093552	0093546 0091793 0093547 0089864 0093548 0093549 0093550 0093551 0093552	0093546 0091793 0093547 0089864 0093548 0093549 0093550 0093551 0093552	0093546 0091793 0093547 0089864 0093548 0093549 0093550 0093551 0093552	0093546 0091793 0093547 0089864 0093548 0093549 0093550 0093551 0093552	0093546 0091793 0093547 0089864 0093548 0093549 0093550 0093551 0093552
* 7	Casing Wear Ring (2 Req'd) Pump without Imp. Wear Rings Cast Iron #5 Bronze Casing Wear Ring (2 Req'd) Pump with Imp. Wear Rings Cast Iron #5 Bronze	0044058 0044060 0044239 0044241	0044239 0044241 0044380 0044381	0044329 0044331 0044390 0044392	0044329 0044331 0044390 0044392	0044390 0044392	0059695 0059696
* 8	Impeller Wear Ring (2 Req'd) Cast Iron #8 Bronze	0045892 0045894	0044378 0044379	0044388 0044389	0044388 0044389	0044388 0044389	0087948 0087949
* 13	Regular Packing Rings Graphite (12 Req'd)	0041823	0041823	0041823	0041823	0041823	0041823
* 13A	Special Packing Rings with Lantern Ring: Center Ring 0058296 (12 Req'd) Special Packing Rings without Lantern Ring: Center Ring 0058296 (12 Req'd)	0065697 0065698	0065697 0065698	0065697 0065698	0065697 0065698	0065697 0065698	0065697 0065698

* Recommended spare parts



A Crane Co. Company

PUMPS & SYSTEMS

USA: (937) 778-8947 • Canada: (905) 457-6223 • International: (937) 615-3598

SECTION	95
PAGE	205
DATE	7/15

Repair Parts

Item No.	Name and Description	6 x 4 x 17 Part No.	8 x 6 x 12 Part No.	8 x 6 x 14½ Part No.	8 x 6 x 17 Part No.	10 x 8 x 12 Part No.	10 x 8 x 14½ Part No.
* 14 R	Shaft Sleeve - R.H. - Packed Box #660 Bronze 440 C SS 416 SS 316 SS	0060917 0049098 0060918 0060920	0060917 0049098 0060918 0060920	0060917 0049098 0060918 0060920	0060917 0049098 0060918 0060920	0060917 0049098 0060918 0060920	0060917 0049098 0060918 0060920
* 14 L	Shaft Sleeve - L.H. - Packed Box #660 Bronze 440 C SS 416 SS 316 SS	0060922 0049099 0060923 0060925	0060922 0049099 0060923 0060925	0060922 0049099 0060923 0060925	0060922 0049099 0060923 0060925	0060922 0049099 0060923 0060925	0060922 0049099 0060923 0060925
* 14 R	Shaft Sleeve - R.H. - Type 21 Seal #660 Bronze 416 SS 316 SS	0061042 0061044 0061043	0061042 0061044 0061043	0061042 0061044 0061043	0061042 0061044 0061043	0061042 0061044 0061043	0061042 0061044 0061043
* 14 L	Shaft Sleeve - L.H. - Type 21 Seal #660 Bronze 416 SS 316 SS	0061038 0061040 0061039	0061038 0061040 0061039	0061038 0061040 0061039	0061038 0061040 0061039	0061038 0061040 0061039	0061038 0061040 0061039
* 16 17	Ball Bearing - Inboard Packing Gland Assy. (2 Req'd) Steel 316 SS	0005260 0044053 0044055 0005259	0005260 0044053 0044055 0005259	0005260 0044053 0044055 0005259	0005260 0044053 0044055 0005259	0005260 0044053 0044055 0005259	0005260 0044053 0044055 0005259
* 18	Ball Bearing - Outboard	0005259	0005259	0005259	0005259	0005259	0005259
22	Bearing Lock Nut Grease Lubricated	0003222	0003222	0003222	0003222	0003222	0003222
22	Bearing Lock Nut (2 Req'd) Oil Lubricated	0055352	0055352	0055352	0055352	0055352	0055352
29	Lantern Ring Half (4 Req'd)	0101626	0101626	0101626	0101626	0101626	0101626
31 33	Bearing Housing - Current Design Inboard - C.I. Outboard - C.I.	0104744 0104744	0104744 0104744	0104744 0104744	0104744 0104744	0104744 0104744	0104744 0104744
31 33	Bearing Housing - Previous Design Inboard - C.I. Outboard - C.I.	0044716 0044716	0044716 0044716	0044716 0044716	0044716 0044716	0044716 0044716	0044716 0044716
32	Impeller Key - 5/16" Sq. x 3 1/2" Steel	0039975	0039975	0039975	0039975	0039975	0039975
35 37	Bearing Cover - Grease Lube Inboard - C.I. Outboard - C.I.	0044710 0044710	0044710 0044710	0044710 0044710	0044710 0044710	0044710 0044710	0044710 0044710
35 37	Bearing Cover - Oil Lube Inboard - C.I. Outboard - C.I.	0055362 0055362	0055362 0055362	0055362 0055362	0055362 0055362	0055362 0055362	0055362 0055362
38	Shaft Sleeve Gasket (2 Req'd)	0077411	0077411	0077411	0077411	0077411	0077411
40	Deflector - Current Design Neoprene (2 Req'd)	0000712	0000712	0000712	0000712	0000712	0000712
40	Deflector - Previous Design Inboard - C.I. Inboard - #8 Bronze	0044047 0044049	0044047 0044049	0044047 0044049	0044047 0044049	0044047 0044049	0044047 0044049
41 & 43	Bearing Cap - C.I. (2 Req'd) #8 Bronze (2 Req'd) NOTE: 14 Shims are required to fit bearing caps.	0066189 0066190 0071917	0066189 0066190 0071917	0066189 0066190 0071917	0066189 0066190 0071917	0066189 0066190 0071917	0066189 0066190 0071917
46	Coupling Key - 3/8" Sq. x 3" Steel	0002220	0002220	0002220	0002220	0002220	0002220
47	Lip Seal - Current Design (2 Req'd)	0104862	0104862	0104862	0104862	0104862	0104862

* Recommended spare parts

Repair Parts

Item No.	Name and Description	6 x 4 x 17 Part No.	8 x 6 x 12 Part No.	8 x 6 x 14½ Part No.	8 x 6 x 17 Part No.	10 x 8 x 12 Part No.	10 x 8 x 14½ Part No.
47	Deflector - Previous Design Outboard - C.I.	0044051	0044051	0044051	0044051	0044051	0044051
60	Outboard - #8 Bronze Oil Ring - Steel (2 Req'd)	0044052 0055348	0044052 0055348	0044052 0055348	0044052 0055348	0044052 0055348	0044052 0055348
* 65 & 80	Seal - Single Type 21 (2 Req'd) Brz. Fitted & All Brz. - BF1C1 All Iron - BF171	0046389 0046390	0046389 0046390	0046389 0046390	0046389 0046390	0046389 0046390	0046389 0046390
68	Shaft Collar - Steel	0055344	0055344	0055344	0055344	0055344	0055344
69	Bearing Lock Washer - Steel	0002862	0002862	0002862	0002862	0002862	0002862
* 73	Parting Gasket - B10 Velcar	0044732	0044775	0060880	0044798	0044950	0060237
123	Bearing End Cover - Tin Plate	0045798	0045798	0045798	0045798	0045798	0045798
125	Oiler - ¼" Trico E52	0075699	0075699	0075699	0075699	0075699	0075699
207	Grease Fitting - ¼" (2 Req'd)	0003131	0003131	0003131	0003131	0003131	0003131
208	Pipe Plug - ¼" For item 1 Cad Plated (6 Req'd) Brass (6 Req'd)	0002009 0000019	0002009 0000019	0002009 0000019	0002009 0000019	0002009 0000019	0002009 0000019
208A	Grease Fitting - ¼" (2 Req'd) For Item 13A when needed	0002640	0002640	0002640	0002640	0002640	0002640
209	Swing Bolts - SS (4 Req'd)	0044037	0044037	0044037	0044037	0044037	0044037
210	Hex Nuts ⅝" For Item 209 Steel Brass	15-23-6 05536	15-23-6 05536	15-23-6 05536	15-23-6 05536	15-23-6 05536	15-23-6 05536
210B	Washer - For item 209 Steel (4 Req'd)	131831	131831	131831	131831	131831	131831
212	Stud ⅝" Steel 316 SS	0000626 0043374	0000624 0038540	0000626 0043374	0000628 0038803	0000624 0038540	0000626 0043374
213	Hex Nuts ⅝" For Item 212 Steel Brass	0002638 0005968	0002638 0005968	0002638 0005968	0002638 0005968	0002638 0005968	0002638 0005968
215	Cap Screws - For Item 209 Steel - (4 Req'd) 316 SS (4 Req'd)	Q15-160-E11 0053893	Q15-124-E11 0041952	Q15-160-E11 0053893	Q15-388-E11 0043029	Q15-389-E11 0053893	Q15-160-E11
216	Pipe Plugs - For Item 1 Drain Galv. (2 Req'd) Brass (2 Req'd)	0006224 0008570	0006224 0008570	0006224 0008570	0006224 0008570	0006224 0008570	0006224 0008570
231	Pipe Plugs - ⅝" Cad. Plated For Items 35 & 37 (2 Req'd)	0002553	0002553	0002553	0002553	0002553	0002553
235	Vent - ⅝" Alemite (2 Req'd)	0039022	0039022	0039022	0039022	0039022	0039022
236	Pipe Plug - ¼" (2 Req'd) For Item 300	0002009	0002009	0002009	0002009	0002009	0002009
239	Cap Screws For Items 41 & 43 (4 Req'd)	0000457	0000457	0000457	0000457	0000474	-
245	Cap Screws ¼" x 1" Steel For Items 35 & 37 (8 Req'd)	0000353	0000353	0000353	0000353	0000353	0000353
246	Dowel Pin - ½" x 1" For Item 41 & 43 (2 Req'd)	0006206	0006206	0006206	0006206	0006206	0006206
247	Dowel Pin - ⅜" x ¾" For Item 1 (2 Req'd)	0006204	0006204	0006204	0006204	0006204	0006204
248	Air Cock - ¼" Brass	0005650	0005650	0005650	0005650	0005650	0005650
251	Seal Gland (2 Req'd) Cast Iron #8 Bronze	0045766 0045768	0045766 0045768	0045766 0045768	0045766 0045768	0045766 0045768	0045766 0045768
* 259	Seal Gasket - Vellutex (2 Req'd)	0019565	0019565	0019565	0019565	0019565	0019565
263	Pipe Plug - ⅝" Socket Head SS (2 Req'd)	0049464	0049464	0049464	0049464	0049464	0049464
296	Set Screws - SS (12 Req'd) For Impeller Wear Rings	0065282	0065281	0065282	0065282	0065282	0065282

* Recommended spare parts



Repair Parts

Item No.	Name and Description	6 x 4 x 17 Part No.	8 x 6 x 12 Part No.	8 x 6 x 14½ Part No.	8 x 6 x 17 Part No.	10 x 8 x 12 Part No.	10 x 8 x 14½ Part No.
299	Nipple Red. Brass (2 req'd)	0104431	0104431	0104431	0104431	0104431	0104431
300	Tee - ¼" Galv. (2 Req'd)	0007029	0007029	0007029	0007029	0007029	0007029
301	Nipple - ¼" x 5 Galv. (2 Req'd)	0000928	0000928	0000928	0000928	0000928	0000928
302	St. Elbow - ¼" Galv. (2 Req'd)	0001807	0001807	0001807	0001807	0001807	0001807
* 303	Bearing Cover Gasket (2 Req'd)	0055356	0055356	0055356	0055356	0055356	0055356
304	Pipe Plug (2 Req'd)						
	Cad. Plated	0002009	0002009	0002009	0002009	0002009	0002009
	Brass	0000019	0000019	0000019	0000019	0000019	0000019
305	Forsheda Ring	0105293	0105293	0105293	0105293	0105293	0105293
(1)	Complete Rotating Assembly Consists of a complete pump less the casing assembly						
	Bronze Fitted	0061224	0061226	0061228	0061230	0061232	0068753
	All Iron	0061225	0061227	0061229	0061231	0061233	0068754
<p>NOTE: (1) The assembly numbers include standard casing and impeller wearing ring where applicable, right hand carbon steel shaft, grease lubricated bearings, standard sleeves and packing. (2) When ordering Rotating Assemblies, always add parting gasket, item 73. (3) Pump Serial Number must be furnished when ordering repair parts. (4) When ordering Previous Part item 6, the following kits will be supplied consisting of Current Design Items 6, 31, 33, 40 and 47.</p>							
6	Pump Shaft - Previous Design	Shaft P/N	Kit P/N				
	Right Hand - 4140 Steel	0093546	0104962				
	Right Hand - 316 SS	0091793	0104963				
	Right Hand - 416 SS	0093547	0104964				
	Left Hand - 4140 Steel	0089864	0104965				
	Left Hand - 316 SS	0093548	0104966				
	Left Hand - 416 SS	0093549	0104967				
	Double Ended - 4140 Steel	0093550	0104968				
	Double Ended - 316 SS	0093551	0104969				
	Double Ended - 416 SS	0093552	0104970				
Parts Intrinsic to Vertical Mount Construction							
	Previous Design: Bearing Housing - C.I.						
31	Inboard	0075064	0075064	0075064	0075064	0075064	0075064
33	Outboard	0075064	0075064	0075064	0075064	0075064	0075064
35	Bearing Cover - Inboard - C.I.	0075063	0075063	0075063	0075063	0075063	0075063
127	Recirculation Line Assembly	0086856	0086856	0086856	0086856	0086856	0086856
169	Lip Seal - For Item 31 & 33 (2 req'd)	0084433	0084433	0084433	0084433	0084433	0084433
169a	Lip Seal - For Item 35	0084434	0084434	0084434	0084434	0084434	0084434
	Current Design: Same as Horizontal with Item No. 127						

* Recommended spare parts

Repair Parts

Item No.	Name and Description	8 x 6 x 20 Part No.	10 x 8 x 17 Part No.	10 x 8 x 20 Part No.	12 x 10 x 12 Part No.	12 x 10 x 14½ Part No.	12 x 10 x 17 Part No.	14 x 12 x 14½ Part No.
1	Casing Assembly Bronze Fitted and All Iron	0061174	0061182	0070159	0053025	0053027	0053029	0070152
	NOTE: Casing Assembly includes upper and lower half casing, bearing caps, parting gasket, air cock, dowel pins, cap screws, studs, and nuts plus all other hardware to make up complete casing assembly. New name plate with duplicate serial number of original pump will also be furnish if requested.							
2	Impeller - Code Cast Iron #8 Bronze	6185 0060620 0060622	8175 0059707 0059709	8185 0070068 0070070	7145 0044959 0044961	7165 0044959 0044961	7178 0058587 0058589	7565 0070072 0070074
	Impeller - Code Cast Iron #8 Bronze		8172 0059703 0059705					
6	Pump Shaft - Current Design							
	Right Hand - 4140 Steel	0104755	0104755	0104755	0104755	0104755	0104755	0104755
	Right Hand - 316 SS	0104756	0104756	0104756	0104756	0104756	0104756	0104756
	Right Hand - 416 SS	0104757	0104757	0104757	0104757	0104757	0104757	0104757
	Left Hand - 4140 Steel	0104758	0104758	0104758	0104758	0104758	0104758	0104758
	Left Hand - 316 SS	0104759	0104759	0104759	0104759	0104759	0104759	0104759
	Left Hand - 416 SS	0104760	0104760	0104760	0104760	0104760	0104760	0104760
	Double Ended - 4140 Steel	0104752	0104752	0104752	0104752	0104752	0104752	0104752
	Double Ended - 316 SS	0104753	0104753	0104753	0104753	0104753	0104753	0104753
	Double Ended - 416 SS	0104754	0104754	0104754	0104754	0104754	0104754	0104754
(4) 6	Pump Shaft - Previous Design							
	Right Hand - 4140 Steel	0089437	0089437	0089437	0089437	0089437	0089437	0089437
	Right Hand - 316 SS	0094192	0094192	0094192	0094192	0094192	0094192	0094192
	Right Hand - 416 SS	0094193	0094193	0094193	0094193	0094193	0094193	0094193
	Left Hand - 4140 Steel	0089438	0089438	0089438	0089438	0089438	0089438	0089438
	Left Hand - 316 SS	0094194	0094194	0094194	0094194	0094194	0094194	0094194
	Left Hand - 416 SS	0094195	0094195	0094195	0094195	0094195	0094195	0094195
	Double Ended - 4140 Steel	0089436	0089436	0089436	0089436	0089436	0089436	0089436
	Double Ended - 316 SS	0094196	0094196	0094196	0094196	0094196	0094196	0094196
	Double Ended - 416 SS	0094197	0094197	0094197	0094197	0094197	0094197	0094197
* 7	Casing Wear Ring (2 Req'd) Pump without Imp. Wear Rings							
	Cast Iron	0044329						
	#5 Bronze	0044331						
	Casing Wear Ring (2 Req'd) Pump with Imp. Wear Rings							
	Cast Iron	0044390	0059695	0059695	0044489	0044489	0057222	0057222
	#5 Bronze	0044392	0059696	0059696	0044491	0044491	0057224	0057224
* 8	Impeller Wear Ring (2 Req'd) Cast Iron	0044388	0087948	0087948	0044123	0044123	0057220	0057220
	#8 Bronze	0044389	0087949	0087949	0044124	0044124	0057221	0057221
* 13	Regular Packing Rings Graphite (12 Req'd)	0041824	0041824	0041824	0041824	0041824	0041824	0041824
* 13A	Special Packing Rings with Lantern Ring: Center Ring 0058298 (12 Req'd)	0065700	0065700	0065700	0065700	0065700	0065700	0065700
	Special Packing Rings without Lantern Ring: Center Ring 0058298 (10 Req'd)	0065701	0065701	0065701	0065701	0065701	0065701	0065701

* Recommended spare parts



A Crane Co. Company

PUMPS & SYSTEMS

USA: (937) 778-8947 • Canada: (905) 457-6223 • International: (937) 615-3598

SECTION	95
PAGE	209
DATE	7/15

Repair Parts

Item No.	Name and Description	8 x 6 x 20 Part No.	10 x 8 x 17 Part No.	10 x 8 x 20 Part No.	12 x 10 x 12 Part No.	12 x 10 x 14½ Part No.	12 x 10 x 17 Part No.	14 x 12 x 14½ Part No.
* 14 R	Shaft Sleeve - R.H. - Packed Box #660 Bronze 440 C SS 416 SS 316 SS	0060897 0049998 0060898 0060900	0060897 0049998 0060898 0060900	0060897 0049998 0060898 0060900	0060897 0049998 0060898 0060900	0060897 0049998 0060898 0060900	0060897 0049998 0060898 0060900	0060897 0049998 0060898 0060900
* 14 L	Shaft Sleeve - L.H. - Packed Box #660 Bronze 440 C SS 416 SS 316 SS	0060902 0049999 0060903 0060905	0060902 0049999 0060903 0060905	0060902 0049999 0060903 0060905	0060902 0049999 0060903 0060905	0060902 0049999 0060903 0060905	0060902 0049999 0060903 0060905	0060902 0049999 0060903 0060905
* 14 R	Shaft Sleeve - R.H. - Type 21 Seal #660 Bronze 416 SS 316 SS	0061050 0061052 0061051	0061050 0061052 0061051	0061050 0061052 0061051	0061050 0061052 0061051	0061050 0061052 0061051	0061050 0061052 0061051	0061050 0061052 0061051
* 14 L	Shaft Sleeve - L.H. - Type 21 Seal #660 Bronze 416 SS 316 SS	0061046 0061048 0061047	0061046 0061048 0061047	0061046 0061048 0061047	0061046 0061048 0061047	0061046 0061048 0061047	0061046 0061048 0061047	0061046 0061048 0061047
* 16 17	Ball Bearing - Inboard Packing Gland Assy. (2 Req'd) Steel 316 SS	0005262 0044125 0044129	0005262 0044125 0044129	0005262 0044125 0044129	0005262 0044125 0044129	0005262 0044125 0044129	0005262 0044125 0044129	0005262 0044125 0044129
* 18	Ball Bearing - Outboard	0039989	0039989	0039989	0039989	0039989	0039989	0039989
22	Bearing Lock Nut Grease Lubricated	0006033	0006033	0006033	0006033	0006033	0006033	0006033
22	Bearing Lock Nut (2 Req'd) Oil Lubricated	0055353	0055353	0055353	0055353	0055353	0055353	0055353
29	Lantern Ring Half (4 Req'd)	0101627	0101627	0101627	0101627	0101627	0101627	0101627
31 33	Bearing Housing - Current Design Inboard - C.I. Outboard - C.I.	0104774 0104774	0104774 0104774	0104774 0104774	0104774 0104774	0104774 0104774	0104774 0104774	0104774 0104774
31 33	Bearing Housing - Previous Design Inboard - C.I. Outboard - C.I.	0044479 0044479	0044479 0044479	0044479 0044479	0044479 0044479	0044479 0044479	0044479 0044479	0044479 0044479
32	Impeller Key - ¾" Sq. x 4¼" Steel	0039983	0039983	0039983	0039983	0039983	0039983	0039983
35 37	Bearing Cover - Grease Lube Inboard - C.I. Outboard - C.I.	0044485 0044485	0044485 0044485	0044485 0044485	0044485 0044485	0044485 0044485	0044485 0044485	0044485 0044485
35 37	Bearing Cover - Oil Lube Inboard - C.I. Outboard - C.I.	0055365 0055365	0055365 0055365	0055365 0055365	0055365 0055365	0055365 0055365	0055365 0055365	0055365 0055365
38	Shaft Sleeve Gasket (2 Req'd)	0077412	0077412	0077412	0077412	0077412	0077412	0077412
40	Deflector - Current Design Neoprene (2 Req'd)	0000714	0000714	0000714	0000714	0000714	0000714	0000714
40	Deflector - Previous Design Inboard - C.I. Inboard - #8 Bronze	0044472 0044474	0044472 0044474	0044472 0044474	0044472 0044474	0044472 0044474	0044472 0044474	0044472 0044474
41 & 43	Bearing Cap - C.I. (2 Req'd) #8 Bronze (2 Req'd) NOTE: 14 Shims are required to fit bearing caps.	0066191 0066192 0071917	0066191 0066192 0071917	0066191 0066192 0071917	0066191 0066192 0071917	0066191 0066192 0071917	0066191 0066192 0071917	0066191 0066192 0071917
46	Coupling Key - ½" Sq. x 3¼" Steel	0039984	0039984	0039984	0039984	0039984	0039984	0039984
47	Lip Seal - Current Design (2 Req'd)	0104863	0104863	0104863	0104863	0104863	0104863	0104863

* Recommended spare parts

Repair Parts

Item No.	Name and Description	8 x 6 x 20 Part No.	10 x 8 x 17 Part No.	10 x 8 x 20 Part No.	12 x 10 x 12 Part No.	12 x 10 x 14½ Part No.	12 x 10 x 17 Part No.	14 x 12 x 14½ Part No.
47	Deflector - Previous Design Outboard - C.I.	0044470	0044470	0044470	0044470	0044470	0044470	0044470
60	Outboard - #8 Bronze Oil Ring - Steel (2 Req'd)	0044471 0055349	0044471 0055349	0044471 0055349	0044471 0055349	0044471 0055349	0044471 0055349	0044471 0055349
* 65 & 80	Seal - Single Type 21 (2 Req'd) Brz. Fitted & All Brz. - BF1C1 All Iron - BF171	0030892 0030893	0030892 0030893	0030892 0030893	0030892 0030893	0030892 0030893	0030892 0030893	0030892 0030893
68	Shaft Collar - Steel	0055345	0055345	0055345	0055345	0055345	0055345	0055345
69	Bearing Lock Washer - Steel	0007147	0007147	0007147	0007147	0007147	0007147	0007147
* 73	Parting Gasket - B10 Velcar	0058753	0053287	0070141	0044882	0044963	0044820	0066223
123	Bearing End Cover - Tin Plate	0045799	0045799	0045799	0045799	0045799	0045799	0045799
125	Oiler - ¼" Trico E52	0075699	0075699	0075699	0075699	0075699	0075699	0075699
207	Grease Fitting - ½" (2 Req'd)	0003131	0003131	0003131	0003131	0003131	0003131	0003131
208	Pipe Plug - ¼" For item 1 Cad Plated (6 Req'd) Brass (6 Req'd)	0002009 0000019	0002009 0000019	0002009 0000019	0002009 0000019	0002009 0000019	0002009 0000019	0002009 0000019
208A	Grease Fitting - ¼" (2 Req'd) For Item 13A when needed	0002640	0002640	0002640	0002640	0002640	0002640	0002640
209	Swing Bolts - SS (4 Req'd)	0044139	0044139	0044139	0044139	0044139	0044139	0044139
210	Hex Nuts ½" For Item 209 Steel (4 Req'd) Brass (4 Req'd)	15-6-6 0005967	15-6-6 0005967	15-6-6 0005967	15-6-6 0005967	15-6-6 0005967	15-6-6 0005967	15-6-6 0005967
210B	Washer - For item 209 Steel (4 Req'd)	131832	131832	131832	131832	131832	131832	131832
212	Stud ¾" x 2¼" Steel 316 SS	0000646 0043028	0000646 0043028	0000646 0043028	0000646 0043028	0000646 0043028	0000646 0043028	0000646 0043028
213	Hex Nuts ¾" For Item 212 Steel Brass	0002710 0005969	0002710 0005969	0002710 0005969	0002710 0005969	0002710 0005969	0002710 0005969	0002710 0005969
215	Cap Screws - For Item 209 Steel - (4 Req'd) 316 SS (4 Req'd)	Q15-388-E11 0043029	Q15-388-E11 0043029	Q15-22-E11 0043029	Q15-90-E11 0043029	Q15-90-E11 0043029	Q15-90-E11 0043029	Q15-90-E11 0053893
216	Pipe Plugs - For Item 1 Drain Galv. (2 Req'd) Brass (2 Req'd)	0006224 0008570	0006224 0008570	0006224 0008570	0000017 0006239	0000017 0006239	0000017 0006239	0000017 0006239
231	Pipe Plugs - ½" Cad. Plated For Items 35 & 37 (2 Req'd)	0002553	0002553	0002553	0002553	0002553	0002553	0002553
235	Vent - ½" Alemite (2 Req'd)	0039022	0039022	0039022	0039022	0039022	0039022	0039022
236	Pipe Plug - ¼" (2 Req'd) For Item 300	0002009	0002009	0002009	0002009	0002009	0002009	0002009
239	Cap Screws ¾" x 2¼" Steel For Items 41 & 43 (4 Req'd)	0000474	0000474	0000474	0000474	0000474	0000474	0000474
245	Cap Screws 5/16" x 1" Steel For Items 35 & 37 (8 Req'd)	0000371	0000371	0000371	0000371	0000371	0000371	0000371
246	Dowel Pin - ½" x 1" Steel For Item 1 (2 Req'd)	0006206	0006206	0006206	0006206	0006206	0006206	0006206
247	Dowel Pin - ¾" x ¾" Steel For Item 41 & 43 (2 Req'd)	0006204	0006204	0006204	0006204	0006204	0006204	0006204
248	Air Cock - ¼" Brass w/ pipe bushing 0003048 Galv. or 0104464 Brass	0005650	0005650	0005650	0005650	0005650	0005650	0005650
251	Seal Gland (2 Req'd) Cast Iron #8 Bronze	0045770 0045772	0045770 0045772	0045770 0045772	0045770 0045772	0045770 0045772	0045770 0045772	0045770 0045772
* 259	Seal Gasket - Vellutex (2 Req'd)	0046387	0046387	0046387	0046387	0046387	0046387	0046387
263	Pipe Plug - ½" Socket Head SS (2 Req'd)	0049464	0049464	0049464	0049464	0049464	0049464	0049464
296	Set Screws - SS (12 Req'd) For Impeller Wear Rings	0065282	0065282	0065282	0065282	0065282	0065282	0065282

* Recommended spare parts

Repair Parts

Item No.	Name and Description	8 x 6 x 20 Part No.	10 x 8 x 17 Part No.	10 x 8 x 20 Part No.	12 x 10 x 12 Part No.	12 x 10 x 14½ Part No.	12 x 10 x 17 Part No.	14 x 12 x 14½ Part No.
299	Nipple Red. Brass (2 req'd)	0104431	0104431	0104431	0104431	0104431	0104431	0104431
300	Tee - ¼" Galv. (2 Req'd)	0007029	0007029	0007029	0007029	0007029	0007029	0007029
301	Nipple - ¼" x 6 Galv. (2 Req'd)	0000932	0000932	0000932	0000932	0000932	0000932	0000932
302	St. Elbow - ¼" Galv. (2 Req'd)	0001807	0001807	0001807	0001807	0001807	0001807	0001807
* 303	Bearing Cover Gasket (2 Req'd)	0044140	0044140	0044140	0044140	0044140	0044140	0044140
304	Pipe Plug (2 Req'd)							
	Cad. Plated	0002009	0002009	0002009	0002009	0002009	0002009	0002009
	Brass	0000019	0000019	0000019	0000019	0000019	0000019	0000019
305	Forsheda Ring	0105294	0105294	0105294	0105294	0105294	0105294	0105294
(1)	Complete Rotating Assembly Consists of a complete pump less the casing assembly							
	Bronze Fitted	0061234	0061236	0070164	0061238	0061240	0061242	0070157
	All Iron	0061235	0061237	0070165	0061239	0061241	0061243	0070158
<p>NOTE: (1) The assembly numbers include standard casing and impeller wearing ring where applicable, right hand carbon steel shaft, grease lubricated bearings, standard sleeves and packing. (2) When ordering Rotating Assemblies, always add parting gasket, item 73. (3) Pump Serial Number must be furnished when ordering repair parts. (4) When ordering Previous Part item 6, the following kits will be supplied consisting of Current Design Items 6, 31, 33, 40 and 47.</p>								
6	Pump Shaft - Previous Design	Shaft P/N	Kit P/N					
	Right Hand - 4140 Steel	0089437	0104971					
	Right Hand - 316 SS	0094192	0104972					
	Right Hand - 416 SS	0094193	0104973					
	Left Hand - 4140 Steel	0089438	0104974					
	Left Hand - 316 SS	0094194	0104975					
	Left Hand - 416 SS	0094195	0104976					
	Double Ended - 4140 Steel	0089436	0104977					
	Double Ended - 316 SS	0094196	0104978					
	Double Ended - 416 SS	0094197	0104979					
Parts Intrinsic to Vertical Mount Construction								
	Previous Design:							
	Bearing Housing - C.I.							
31	Inboard	0083704	0083704	0083704	0083704	0083704	0083704	0083704
33	Outboard	0083704	0083704	0083704	0083704	0083704	0083704	0083704
35	Bearing Cover - Inboard - C.I.	0083702	0083702	0083702	0083702	0083702	0083702	0083702
127	Recirculation Line Assembly	0086856	0086856	0086856	0086856	0086856	0086856	0086856
169	Lip Seal - For Item 31 & 33 (2 req'd)	0083692	0083692	0083692	0083692	0083692	0083692	0083692
169a	Lip Seal - For Item 35	0083693	0083693	0083693	0083693	0083693	0083693	0083693
	Current Design:							
	Same as Horizontal with Item No. 127							

* Recommended spare parts

Repair Parts

Item No.	Name and Description	14 x 12 x 14½ Part No.
1	Casing Assembly Bronze Fitted and All Iron	0084991
	NOTE: Casing Assembly includes upper and lower half casing, bearing caps, parting gasket, air cock, dowel pins, cap screws, studs, and nuts plus all other hardware to make up complete casing assembly. New name plate with duplicate serial number of original pump will also be furnish if requested.	
2	Impeller - Code	7566
	Cast Iron	0089269
	#8 Bronze	0089271
6	Pump Shaft - Current Design	
	Right Hand - 4140 Steel	0081363
	Right Hand - 316 SS	0094498
	Right Hand - 416 SS	0094497
	Left Hand - 4140 Steel	0092157
	Left Hand - 316 SS	0094500
	Left Hand - 416 SS	0094499
	Double Ended - 4140 Steel	0085096
	Double Ended - 316 SS	0094502
	Double Ended - 416 SS	0094501
* 7	Casing Wear Ring (2 Req'd) Pump with Imp. Wear Rings Cast Iron	0081369
	#5 Bronze	0081367
* 8	Impeller Wear Ring (2 Req'd) Cast Iron	0100456
		0100457
* 13	Regular Packing Rings Graphite (12 Req'd)	0041824
* 13A	Special Packing Rings with Lantern Ring: Center Ring 0058296 (12 Req'd)	0065700
	Special Packing Rings without Lantern Ring: Center Ring 0058298 (16 Req'd)	0065701
* 14 R	Shaft Sleeve - R.H. - Packed Box #660 Bronze 440 C SS 416 SS 316 SS	0081392
		0081390
		0081391
		0081389
* 14 L	Shaft Sleeve - L.H. - Packed Box #660 Bronze 440 C SS 416 SS 316 SS	0081387
		0081385
		0081386
		0081384

Item No.	Name and Description	14 x 12 x 14½ Part No.
* 14 R	Shaft Sleeve - R.H. - Type 21 Seal #660 Bronze 416 SS 316 SS	0094538
		0094539
		0094540
* 14 L	Shaft Sleeve - L.H. - Type 21 Seal #660 Bronze 416 SS 316 SS	0094541
		0094542
		0094543
* 16	Ball Bearing - Inboard	0005262
17	Packing Gland Assy. (2 Req'd) Steel	0044125
		0044129
	316 SS	0039989
* 18	Ball Bearing - Outboard	0005262
22	Bearing Lock Nut Grease Lubricated	0006033
		0055353
	Bearing Lock Nut (2 Req'd) Oil Lubricated	
29	Lantern Ring Half (4 Req'd)	0101627
31	Bearing Housing - Current Design Inboard - C.I.	0104774
		0104774
33	Outboard - C.I. Bearing Housing - Previous Design Inboard - C.I.	0081371
		0081371
	Outboard - C.I.	
32	Impeller Key - 3/8" Sq. x 7 1/2" Steel	0084990
35	Bearing Cover - Grease Lube Inboard - C.I.	0044485
		0044485
37	Outboard - C.I. Bearing Cover - Oil Lube Inboard - C.I.	0055365
		0055365
	Outboard - C.I.	
38	Shaft Sleeve Gasket (2 Req'd)	0077412
40	Deflector - Current Design Neoprene (2 Req'd) Deflector - Current Design Inboard - C.I.	0000714
	Inboard - #8 Bronze	
41 & 43	Bearing Cap - C.I. (2 Req'd) #8 Bronze (2 Req'd) NOTE: 14 Shimms are required to fit bearing caps.	0066191
		0066192
		0071917
46	Coupling Key - 1/2" Sq. x 3 1/4" Steel	0039984
47	Lip Seal - Current Design (2 Req'd)	0104863

* Recommended spare parts

Repair Parts

Item No.	Name and Description	14 x 12 x 14½ Part No.
47 60	Deflector - Previous Design Oil Ring - Steel (2 Req'd)	0039984 0055349
* 65 & 80	Seal - Single Type 21 (2 Req'd) Brz. Fitted & All Brz. - BF1C1 All Iron - BF171	0030892 0030893
68	Shaft Collar - Steel	0055345
69	Bearing Lock Washer - Steel	0007147
* 73	Parting Gasket - B10 Velcar	0099336
123	Bearing End Cover - Tin Plate	0045799
125	Oiler - ¼" Trico E52	0075699
207	Grease Fitting - ¼" (2 Req'd)	0003131
208	Pipe Plug - ¼" For item 1 Cad Plated (6 Req'd) Brass (6 Req'd)	0002009 0000019
208A	Grease Fitting - ¼" (2 Req'd) For Item 13A when needed	0002640
209	Swing Bolts - SS (4 Req'd)	0044139
210	Hex Nuts ½" For Item 209 Steel (4 Req'd)	15-6-6
	Brass (4 Req'd)	0005967
210B	Washer - For item 209 Steel (4 Req'd)	131832
212	Stud ¾" x 2¾" Steel 316 SS	0000646 0043028
213	Hex Nuts ¾" For Item 212 Steel Brass	0002710 0005969
215	Cap Screws - For Item 209 Steel - (4 Req'd) 316 SS (4 Req'd)	Q15-388-E11 0043029
216	Pipe Plugs - For Item 1 Drain Galv. (2 Req'd) Brass (2 Req'd)	0000017 0006239
231	Pipe Plugs - ¼" Cad. Plated For Items 35 & 37 (2 Req'd)	0002553
235	Vent - ¼" Alemite (2 Req'd)	0039022
236	Pipe Plug - ¼" (2 Req'd) For Item 300	0002009
239	Cap Screws ¾" x 2¼" Steel For Items 41 & 43 (4 Req'd)	0000474
245	Cap Screws 5/16 x 1" Steel For Items 35 & 37 (8 Req'd)	0000371

Item No.	Name and Description	14 x 12 x 14½ Part No.
246	Dowel Pin - ½" x 1" Steel For Item 1 (2 Req'd)	0006206
247	Dowel Pin - ¾" x ¾" Steel For Item 41 & 43 (2 Req'd)	0006204
248	Air Cock - ¼" Brass w/ pipe bushing 0003048 Galv. or 0104464 Brass	0005650
251	Seal Gland (2 Req'd) Cast Iron #8 Bronze	0045770 0045772
* 259	Seal Gasket - Vellutex (2 Req'd)	0046387
263	Pipe Plug - ½" Socket Head SS (2 Req'd)	0049464
296	Set Screws - SS (12 Req'd) For Impeller Wear Rings	0065282
299	Nipple Red. Brass (2 req'd)	0104431
300	Tee - ¼" Galv. (2 Req'd)	0007029
301	Nipple - ¼" x 6 Galv. (2 Req'd)	0000932
302	St. Elbow - ¼" Galv. (2 Req'd)	0001807
* 303	Bearing Cover Gasket (2 Req'd)	0044140
304	Pipe Plug (2 Req'd) Cad. Plated Brass	0002009 0000019
305 (1)	Forsheda Ring Complete Rotating Assembly Consists of a complete pump less the casing assembly Bronze Fitted All Iron	0100411 0100410

NOTE: (1) The assembly numbers include standard casing and impeller wearing ring where applicable, right hand carbon steel shaft, grease lubricated bearings, standard sleeves and packing.
(2) When ordering Rotating Assemblies, always add parting gasket, item 73.
(3) Pump Serial Number must be furnished when ordering repair parts.

* Recommended spare parts