

ITEM No.	DESCRIPTION
1	Casing
2	Impeller
6	Shaft
11	Packing Box Cover
13	Packing
14	Shaft Sleeve
16	Bearing (inboard)
17	Gland, Split
18	Bearing (outboard)
19	Frame
22	Nut, Bearing Lock
29	Lantern Ring
33	Bearing Housing - Outboard
35	Bearing Cover - Inboard
37	Bearing Cover - Outboard
38	Shaft gasket
40	Deflector
46	Coupling Key

ITEM No.	DESCRIPTION
47	Bearing Cover Seal - Inboard
49	Bearing Cover Seal-Outboard
51	Oil Slinger
69	Lockwasher, Bearing
73	Casing Gasket
77	Lubricator
195	Set Screw
203	Name Plate
204	Adjusting Locknut
206	Split Gland Clip
208	Pipe Plug
210	Hex Nut
212	Cap screw
213	Cap Screw
214	Drive screw
232	O-ring
235	Breather
236	Pipe Plug

ITEM No.	DESCRIPTION
237	Pipe Plug
238	Pipe Plug (not shown)
239	Stud
249	Hex Nut
274	Frame Foot
275	Lifting Ring
277	Cap screw
278	Caution Label
279	Shaft Sleeve Key
281	Gland Stud
286	Jack Screw (Bearing Cover)
292	O-ring (Bearing Cover)
293	Bearing Nameplate (Not Shown)
332	Cap Screw

Pump Assembly - 3060 Series

Oil Lubricated Construction
Bulletin 3060

DEMING®

www.cranepumps.com

Chemical & Process ANSI Pumps

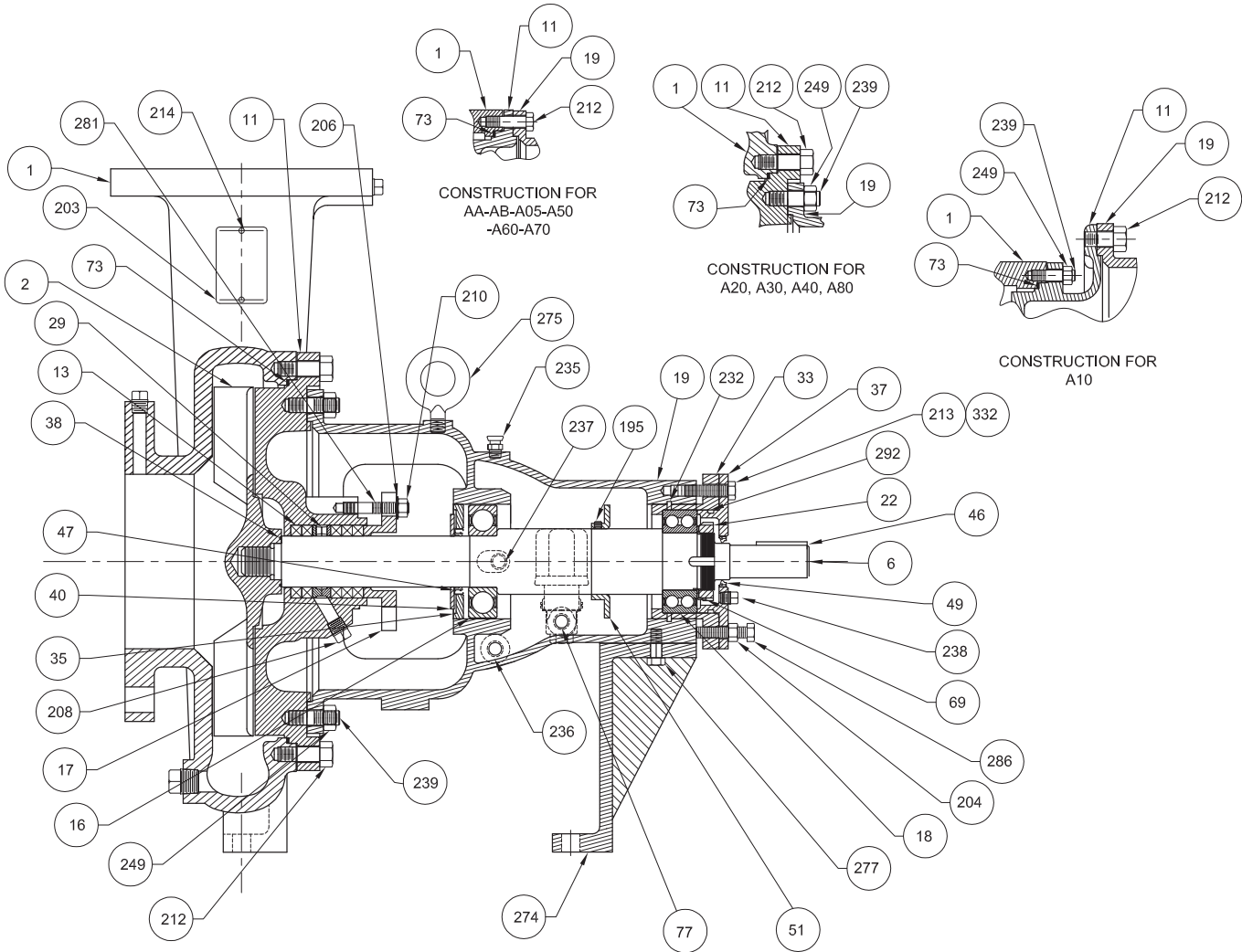

ITEM No.	DESCRIPTION
1	Casing
2	Impeller
6	Shaft
11	Packing Box Cover
13	Packing
16	Bearing (inboard)
17	Gland, Split
18	Bearing (outboard)
19	Frame
22	Nut, Bearing Lock
29	Lantern Ring
33	Bearing Housing - Outboard
35	Bearing Cover - Inboard
37	Bearing Cover - Outboard
38	Shaft gasket
40	Deflector
46	Coupling Key

ITEM No.	DESCRIPTION
47	Bearing Cover Seal - Inboard
49	Bearing Cover Seal-Outboard
51	Oil Slinger
69	Lockwasher, Bearing
73	Casing Gasket
77	Lubricator
195	Set Screw
203	Name Plate
204	Adjusting Locknut
206	Split Gland Clip
208	Pipe Plug
210	Hex Nut
212	Cap screw
213	Cap Screw
214	Drive screw
232	O-ring
235	Breather

ITEM No.	DESCRIPTION
236	Pipe Plug
237	Pipe Plug
238	Pipe Plug (not shown)
239	Stud
249	Hex Nut
274	Frame Foot
275	Lifting Ring
277	Cap screw
278	Caution Label
281	Gland Stud
286	Jack Screw (Bearing Cover)
292	O-ring (Bearing Cover)
293	Bearing Nameplate (Not Shown)
332	Cap Screw

SECTION 36
PAGE 8
DATE 7/07

CRANE®

A Crane Co. Company

PUMPS & SYSTEMS

USA: (937) 778-8947 • Canada: (905) 457-6223 • International: (937) 615-3598

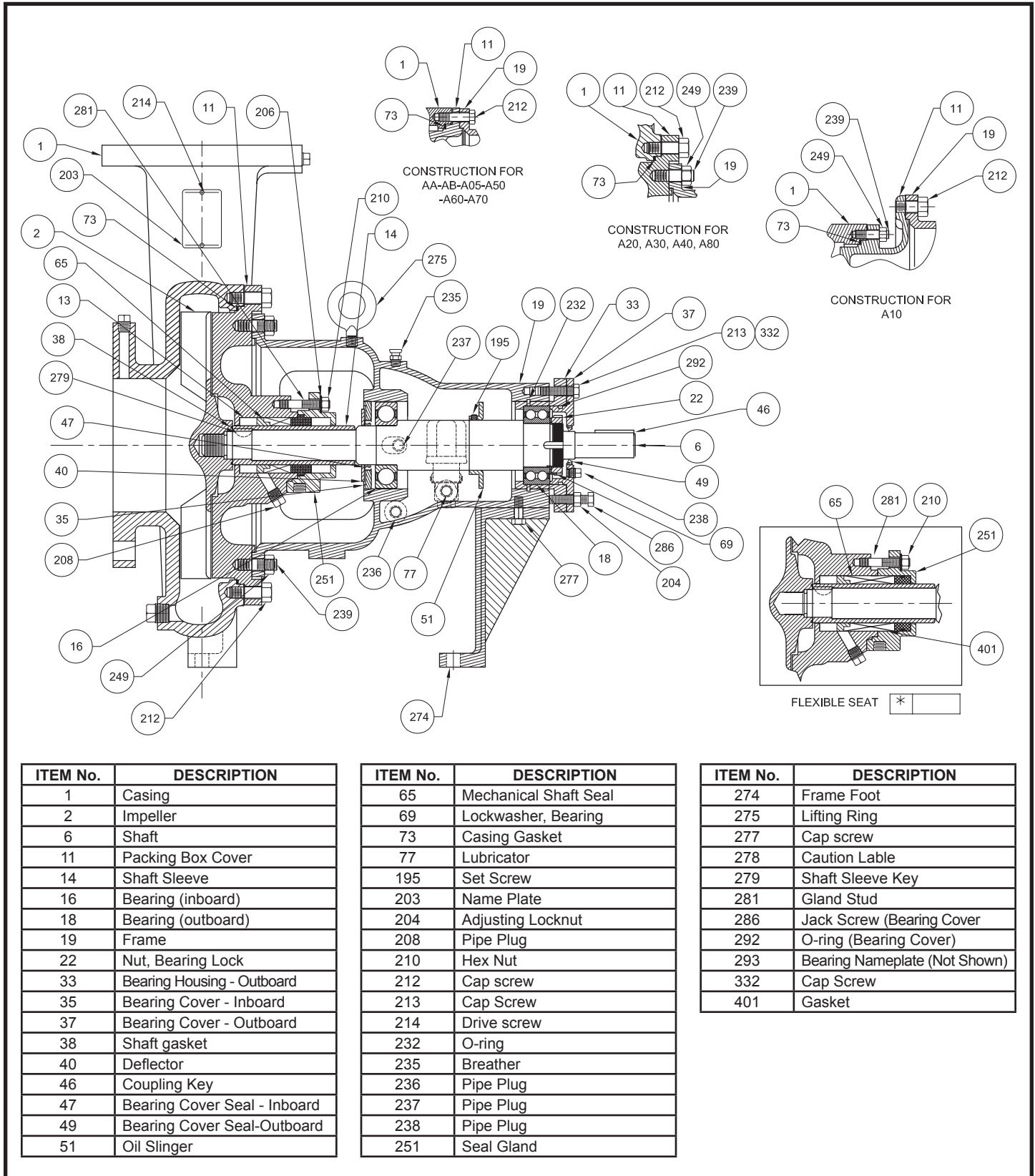

ITEM No.	DESCRIPTION
1	Casing
2	Impeller
6	Shaft
11	Packing Box Cover
14	Shaft Sleeve
16	Bearing (inboard)
18	Bearing (outboard)
19	Frame
22	Nut, Bearing Lock
33	Bearing Housing - Outboard
35	Bearing Cover - Inboard
37	Bearing Cover - Outboard
38	Shaft gasket
40	Deflector
46	Coupling Key
47	Bearing Cover Seal - Inboard
49	Bearing Cover Seal-Outboard
51	Oil Slinger

ITEM No.	DESCRIPTION
65	Mechanical Shaft Seal
69	Lockwasher, Bearing
73	Casing Gasket
77	Lubricator
195	Set Screw
203	Name Plate
204	Adjusting Locknut
208	Pipe Plug
210	Hex Nut
212	Cap screw
213	Cap Screw
214	Drive screw
232	O-ring
235	Breather
236	Pipe Plug
237	Pipe Plug
238	Pipe Plug
251	Seal Gland

ITEM No.	DESCRIPTION
274	Frame Foot
275	Lifting Ring
277	Cap screw
278	Caution Label
279	Shaft Sleeve Key
281	Gland Stud
286	Jack Screw (Bearing Cover)
292	O-ring (Bearing Cover)
293	Bearing Nameplate (Not Shown)
332	Cap Screw
401	Gasket

Pump Assembly - 3060 Series

Water Jacketed - Oil Lubricated Construction
Bulletin 3060

DEMING®

www.cranepumps.com

Chemical & Process ANSI Pumps

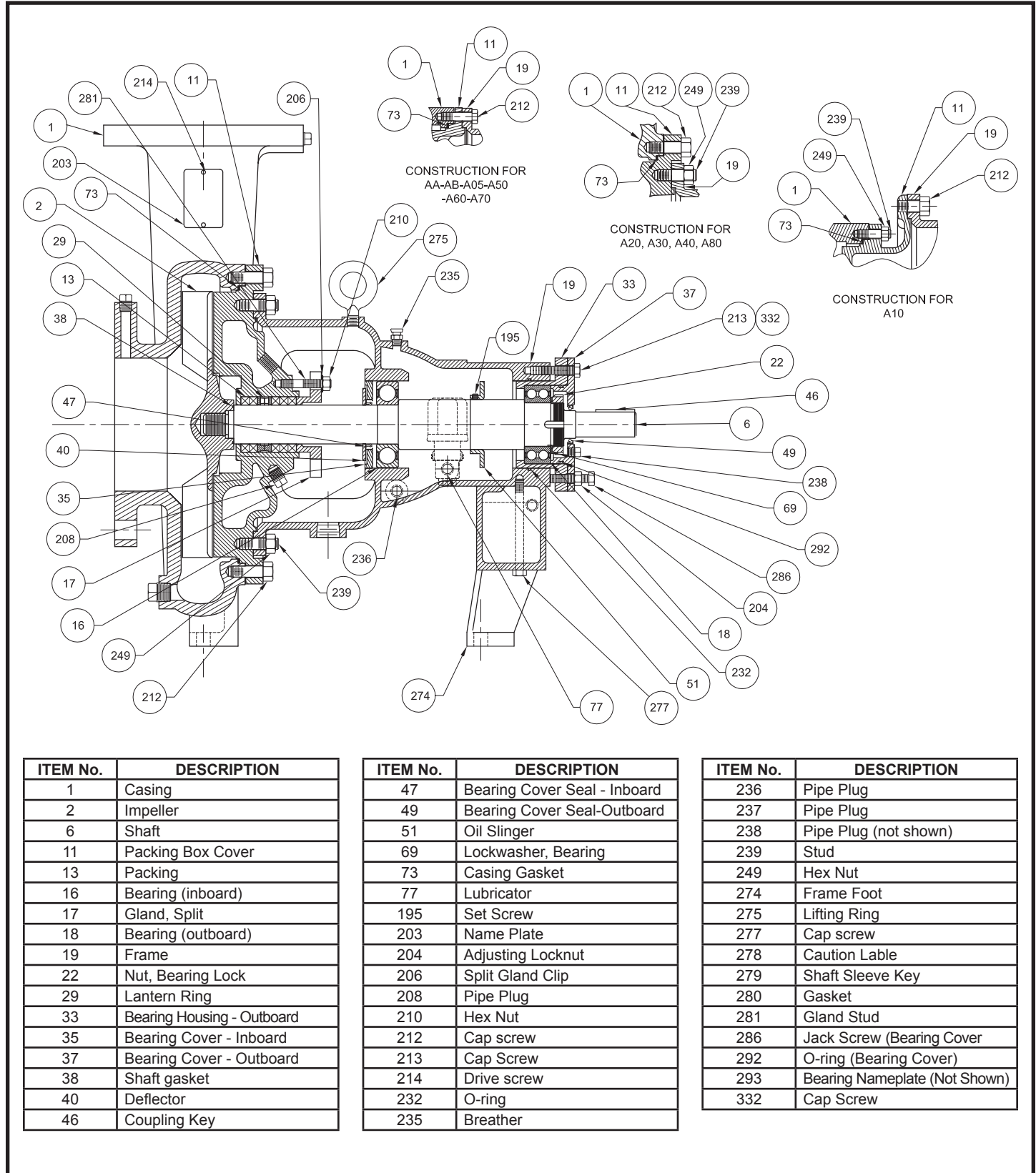

ITEM No.	DESCRIPTION
1	Casing
2	Impeller
6	Shaft
11	Packing Box Cover
13	Packing
16	Bearing (inboard)
17	Gland, Split
18	Bearing (outboard)
19	Frame
22	Nut, Bearing Lock
29	Lantern Ring
33	Bearing Housing - Outboard
35	Bearing Cover - Inboard
37	Bearing Cover - Outboard
38	Shaft gasket
40	Deflector
46	Coupling Key

ITEM No.	DESCRIPTION
47	Bearing Cover Seal - Inboard
49	Bearing Cover Seal-Outboard
51	Oil Slinger
69	Lockwasher, Bearing
73	Casing Gasket
77	Lubricator
195	Set Screw
203	Name Plate
204	Adjusting Locknut
206	Split Gland Clip
208	Pipe Plug
210	Hex Nut
212	Cap screw
213	Cap Screw
214	Drive screw
232	O-ring
235	Breather

ITEM No.	DESCRIPTION
236	Pipe Plug
237	Pipe Plug
238	Pipe Plug (not shown)
239	Stud
249	Hex Nut
274	Frame Foot
275	Lifting Ring
277	Cap screw
278	Caution Label
279	Shaft Sleeve Key
280	Gasket
281	Gland Stud
286	Jack Screw (Bearing Cover)
292	O-ring (Bearing Cover)
293	Bearing Nameplate (Not Shown)
332	Cap Screw

SECTION 36
PAGE 10
DATE 7/07

CRANE
A Crane Co. Company

PUMPS & SYSTEMS

USA: (937) 778-8947 • Canada: (905) 457-6223 • International: (937) 615-3598

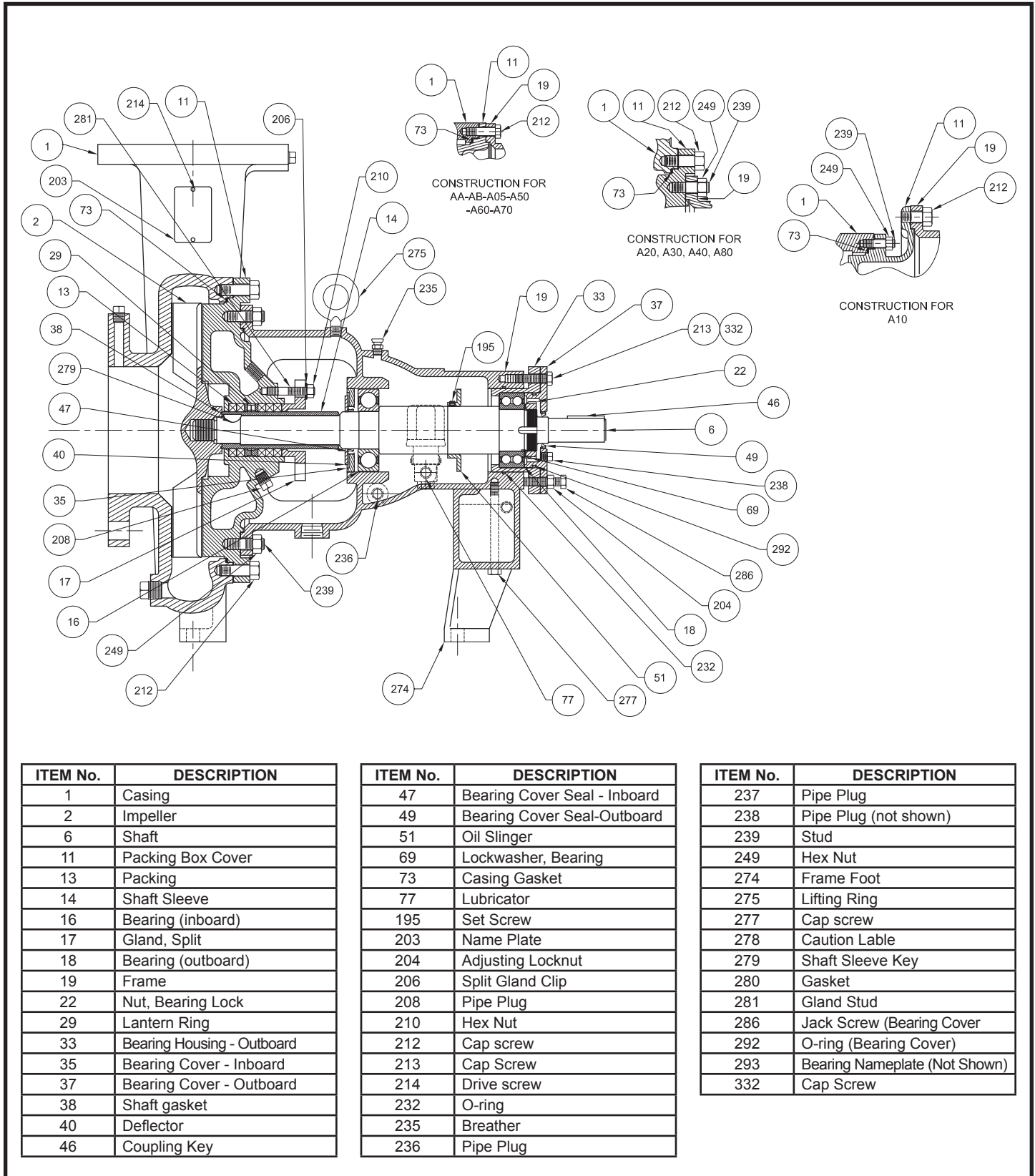

Pump Assembly - 3060 Series

Grease Lubricated Construction
Bulletin 3060

DEMING®

www.cranepumps.com

Chemical & Process ANSI Pumps

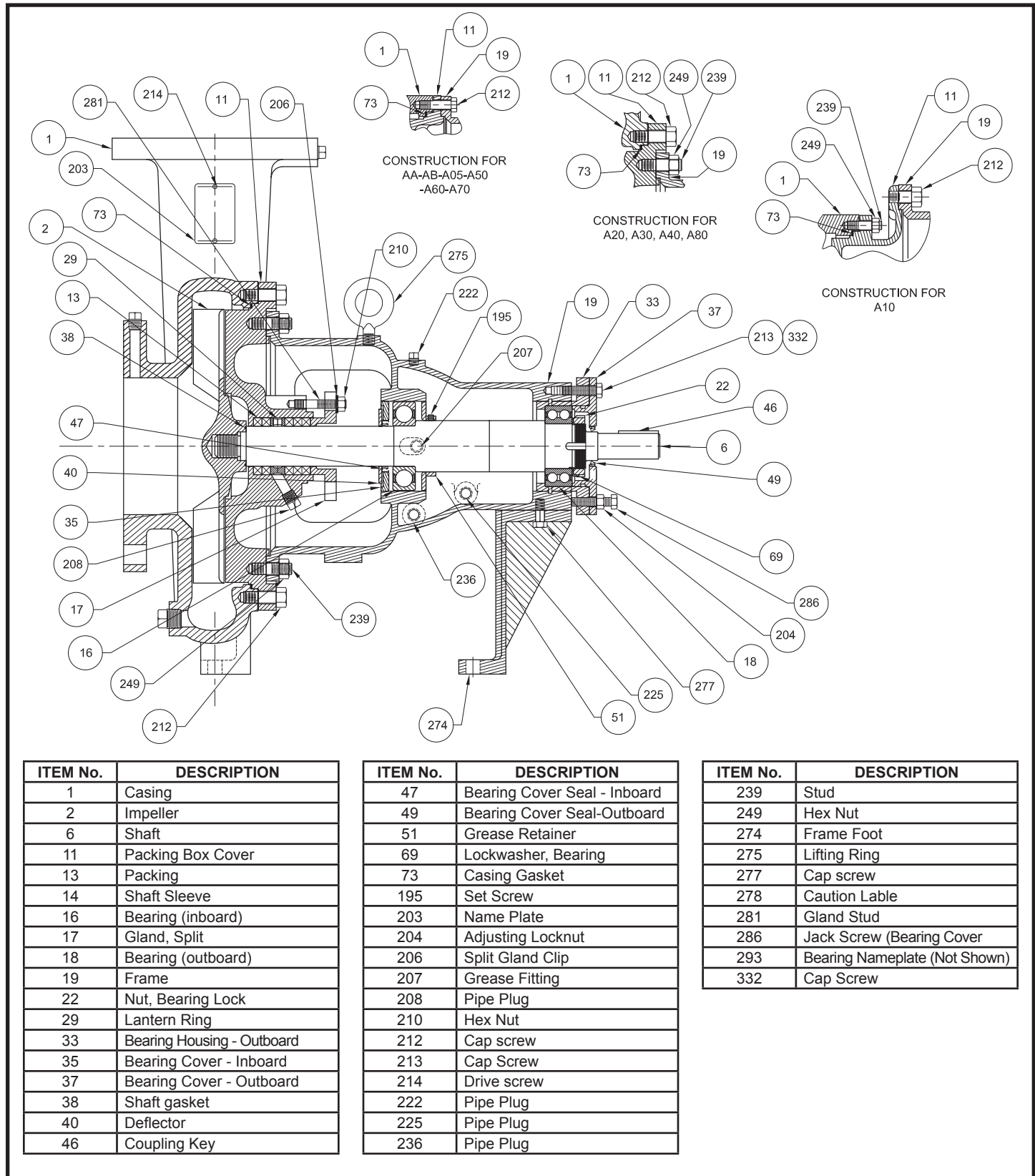

ITEM No.	DESCRIPTION
1	Casing
2	Impeller
6	Shaft
11	Packing Box Cover
13	Packing
14	Shaft Sleeve
16	Bearing (inboard)
17	Gland, Split
18	Bearing (outboard)
19	Frame
22	Nut, Bearing Lock
29	Lantern Ring
33	Bearing Housing - Outboard
35	Bearing Cover - Inboard
37	Bearing Cover - Outboard
38	Shaft gasket
40	Deflector
46	Coupling Key

ITEM No.	DESCRIPTION
47	Bearing Cover Seal - Inboard
49	Bearing Cover Seal-Outboard
51	Grease Retainer
69	Lockwasher, Bearing
73	Casing Gasket
195	Set Screw
203	Name Plate
204	Adjusting Locknut
206	Split Gland Clip
207	Grease Fitting
208	Pipe Plug
210	Hex Nut
212	Cap screw
213	Cap Screw
214	Drive screw
222	Pipe Plug
225	Pipe Plug
236	Pipe Plug

ITEM No.	DESCRIPTION
239	Stud
249	Hex Nut
274	Frame Foot
275	Lifting Ring
277	Cap screw
278	Caution Label
281	Gland Stud
286	Jack Screw (Bearing Cover)
293	Bearing Nameplate (Not Shown)
332	Cap Screw

SECTION 36
PAGE 12
DATE 7/07

CRANE
A Crane Co. Company

PUMPS & SYSTEMS

USA: (937) 778-8947 • Canada: (905) 457-6223 • International: (937) 615-3598

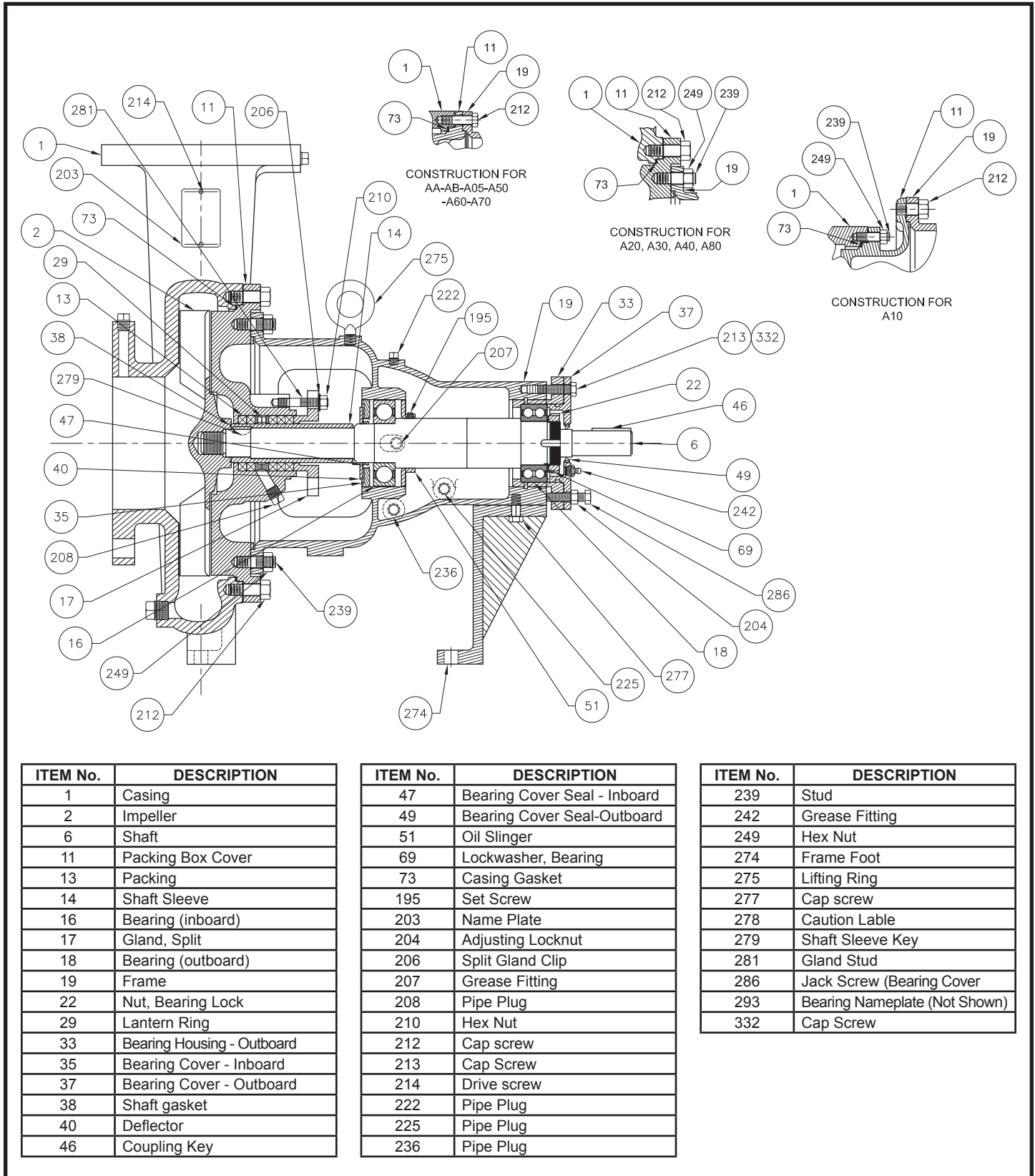

ITEM No.	DESCRIPTION
1	Casing
2	Impeller
6	Shaft
11	Packing Box Cover
13	Packing
14	Shaft Sleeve
16	Bearing (inboard)
17	Gland, Split
18	Bearing (outboard)
19	Frame
22	Nut, Bearing Lock
29	Lantern Ring
33	Bearing Housing - Outboard
35	Bearing Cover - Inboard
37	Bearing Cover - Outboard
38	Shaft gasket
40	Deflector
46	Coupling Key

ITEM No.	DESCRIPTION
47	Bearing Cover Seal - Inboard
49	Bearing Cover Seal-Outboard
51	Oil Slinger
69	Lockwasher, Bearing
73	Casing Gasket
195	Set Screw
203	Name Plate
204	Adjusting Locknut
206	Split Gland Clip
207	Grease Fitting
208	Pipe Plug
210	Hex Nut
212	Cap screw
213	Cap Screw
214	Drive screw
222	Pipe Plug
225	Pipe Plug
236	Pipe Plug

ITEM No.	DESCRIPTION
239	Stud
242	Grease Fitting
249	Hex Nut
274	Frame Foot
275	Lifting Ring
277	Cap screw
278	Caution Label
279	Shaft Sleeve Key
281	Gland Stud
286	Jack Screw (Bearing Cover)
293	Bearing Nameplate (Not Shown)
332	Cap Screw

Pump Assembly - 3060 Series

Oil Lubricated Construction with Shaft Sleeve,
Jacketed Packing Box, Cooling Frame - Bulletin 3060

DEMING®

www.cranepumps.com

Chemical & Process ANSI Pumps

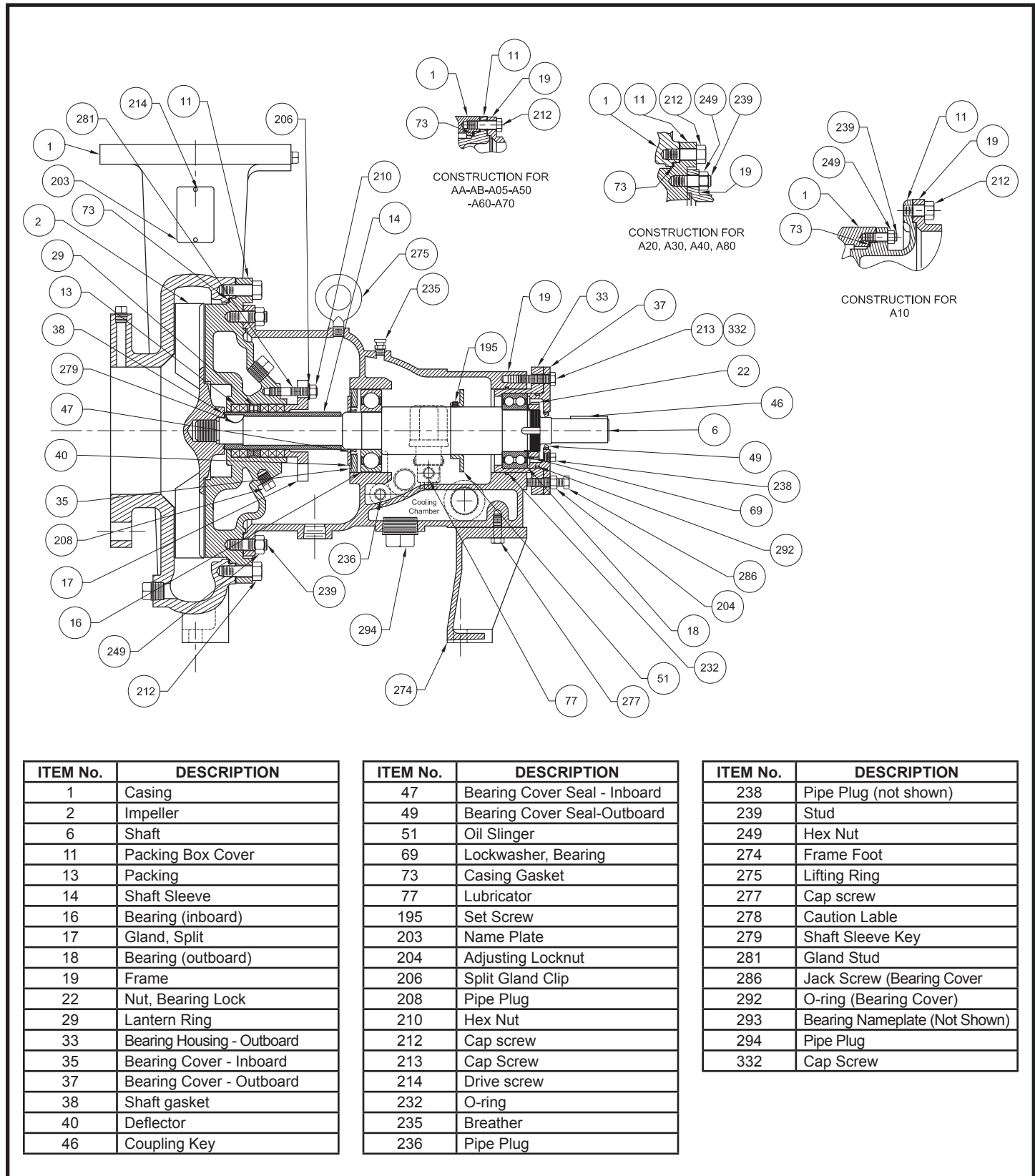

ITEM No.	DESCRIPTION
1	Casing
2	Impeller
6	Shaft
11	Packing Box Cover
13	Packing
14	Shaft Sleeve
16	Bearing (inboard)
17	Gland, Split
18	Bearing (outboard)
19	Frame
22	Nut, Bearing Lock
29	Lantern Ring
33	Bearing Housing - Outboard
35	Bearing Cover - Inboard
37	Bearing Cover - Outboard
38	Shaft gasket
40	Deflector
46	Coupling Key

ITEM No.	DESCRIPTION
47	Bearing Cover Seal - Inboard
49	Bearing Cover Seal-Outboard
51	Oil Slinger
69	Lockwasher, Bearing
73	Casing Gasket
77	Lubricator
195	Set Screw
203	Name Plate
204	Adjusting Locknut
206	Split Gland Clip
208	Pipe Plug
210	Hex Nut
212	Cap screw
213	Cap Screw
214	Drive screw
232	O-ring
235	Breather
236	Pipe Plug

ITEM No.	DESCRIPTION
238	Pipe Plug (not shown)
239	Stud
249	Hex Nut
274	Frame Foot
275	Lifting Ring
277	Cap screw
278	Caution Label
279	Shaft Sleeve Key
281	Gland Stud
286	Jack Screw (Bearing Cover)
292	O-ring (Bearing Cover)
293	Bearing Nameplate (Not Shown)
294	Pipe Plug
332	Cap Screw

SECTION 36
PAGE 14
DATE 7/07

CRANE
A Crane Co. Company

PUMPS & SYSTEMS

USA: (937) 778-8947 • Canada: (905) 457-6223 • International: (937) 615-3598

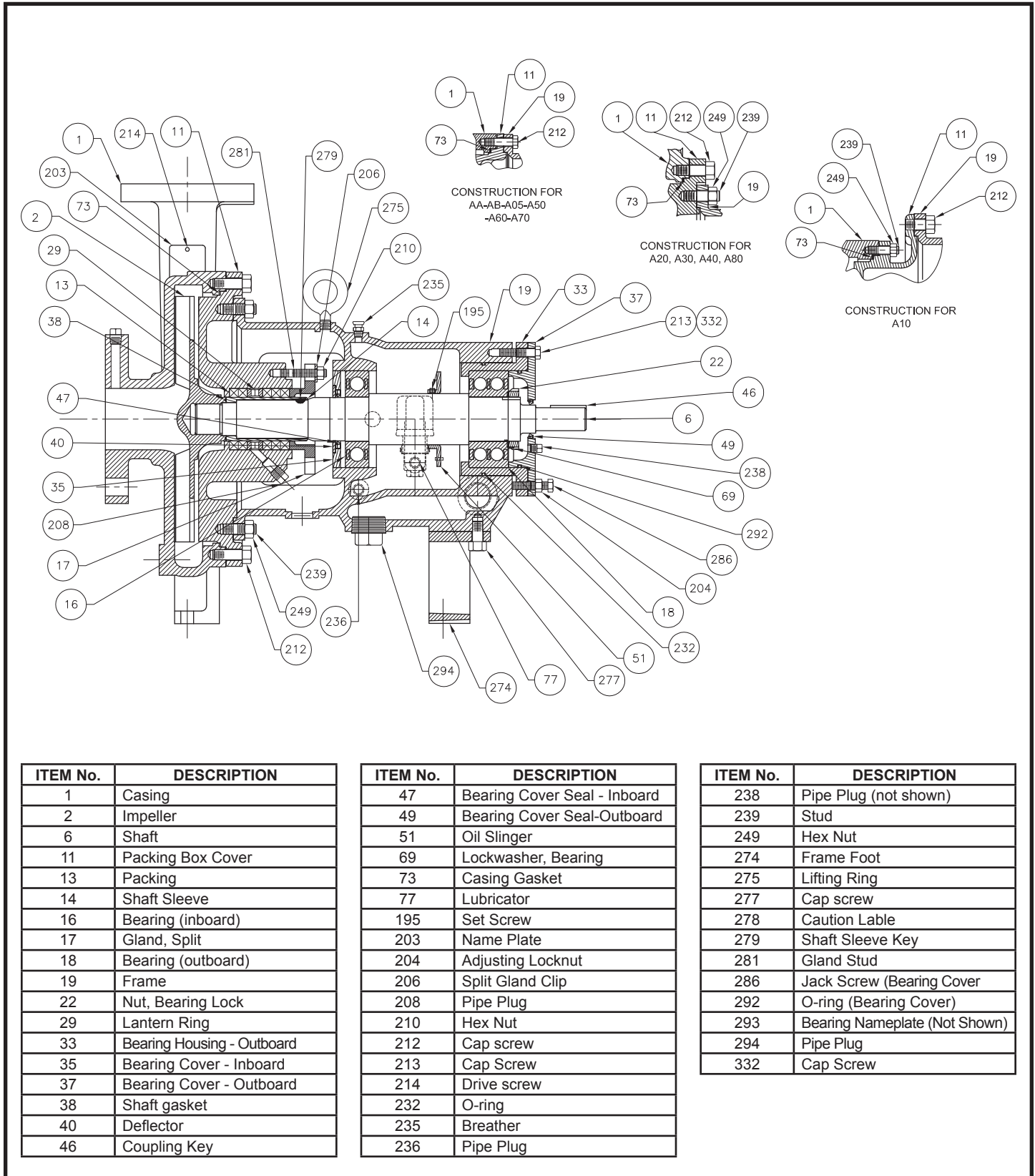

ITEM No.	DESCRIPTION
1	Casing
2	Impeller
6	Shaft
11	Packing Box Cover
13	Packing
14	Shaft Sleeve
16	Bearing (inboard)
17	Gland, Split
18	Bearing (outboard)
19	Frame
22	Nut, Bearing Lock
29	Lantern Ring
33	Bearing Housing - Outboard
35	Bearing Cover - Inboard
37	Bearing Cover - Outboard
38	Shaft gasket
40	Deflector
46	Coupling Key

ITEM No.	DESCRIPTION
47	Bearing Cover Seal - Inboard
49	Bearing Cover Seal-Outboard
51	Oil Slinger
69	Lockwasher, Bearing
73	Casing Gasket
77	Lubricator
195	Set Screw
203	Name Plate
204	Adjusting Locknut
206	Split Gland Clip
208	Pipe Plug
210	Hex Nut
212	Cap screw
213	Cap Screw
214	Drive screw
232	O-ring
235	Breather
236	Pipe Plug

ITEM No.	DESCRIPTION
238	Pipe Plug (not shown)
239	Stud
249	Hex Nut
274	Frame Foot
275	Lifting Ring
277	Cap screw
278	Caution Label
279	Shaft Sleeve Key
281	Gland Stud
286	Jack Screw (Bearing Cover)
292	O-ring (Bearing Cover)
293	Bearing Nameplate (Not Shown)
294	Pipe Plug
332	Cap Screw