

Centrifugals - Self-Priming

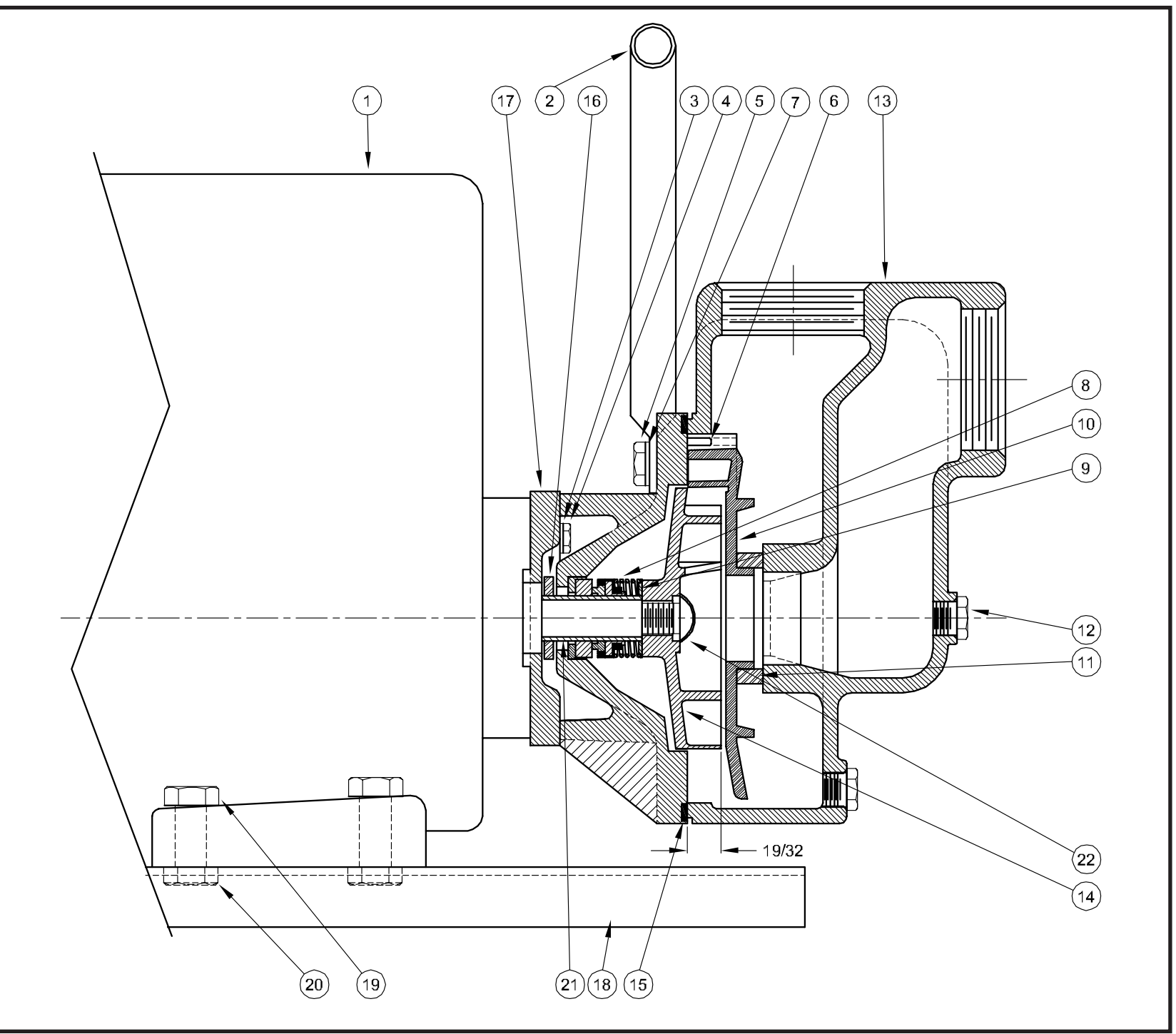

SECTION CSPP
PAGE 68
DATE 2/05



PUMPS & SYSTEMS
USA: (937) 778-8947 • Canada: (905) 457-6223 • International: (937) 615-3598

SYMBOL NUMBER	PART NUMBER	QTY	DESCRIPTION
16	08324	1	Slinger Washer
17	20688	1	Adapter
18	20689	1	Base
19	01606	4	Cap Screw, 5/16-18 x 1¼
20	02709	4	Hex Nut, 5/16-18
21	20691	1	Shaft Sleeve
22	20759	1	Expansion Plug
Not Shown	20692	1	Strainer

(*) **NOTE:** Due to a design change, the impeller and diffuser **must** be ordered as a set for all pumps with Serial Number prior to 851629.

SYMBOL NUMBER	PART NUMBER	QTY	DESCRIPTION
1	20693B5	1	Engine - B&S 80232
2	20690	1	Handle
3	09311	4	Lock Washer 5/16"
4	03104	4	Cap Screw 5/16-24 x 1" Lg
5	04235	4	Cap Screw 3/8-16 x 1¼" Lg
6	23042	2	Pin
7	20056	4	Lock Washer (used on two bottom screws)
8	08991	1	Mechanical Seal
9	20698	A/R	Shim .005"
	20699	A/R	Shim .010"
	20700	A/R	Shim .032"
* 10	20405-3	1	Diffuser
11	04231	1	Suction Sleeve
12	04236	2	Pipe Plug 1/4"
13	20295	1	Case
* 14	20408-2	1	Impeller
15	08507	1	Gasket

CRANE®

PUMPS & SYSTEMS