

## ZC2/ZCH2 PUMPS

1 $\frac{1}{2}$ x1 $\frac{1}{2}$ , 2x2, 3x2, 4x3L, 4x3C, 5x4

### AMPCO PUMPS COMPANY PARTS BREAKDOWN

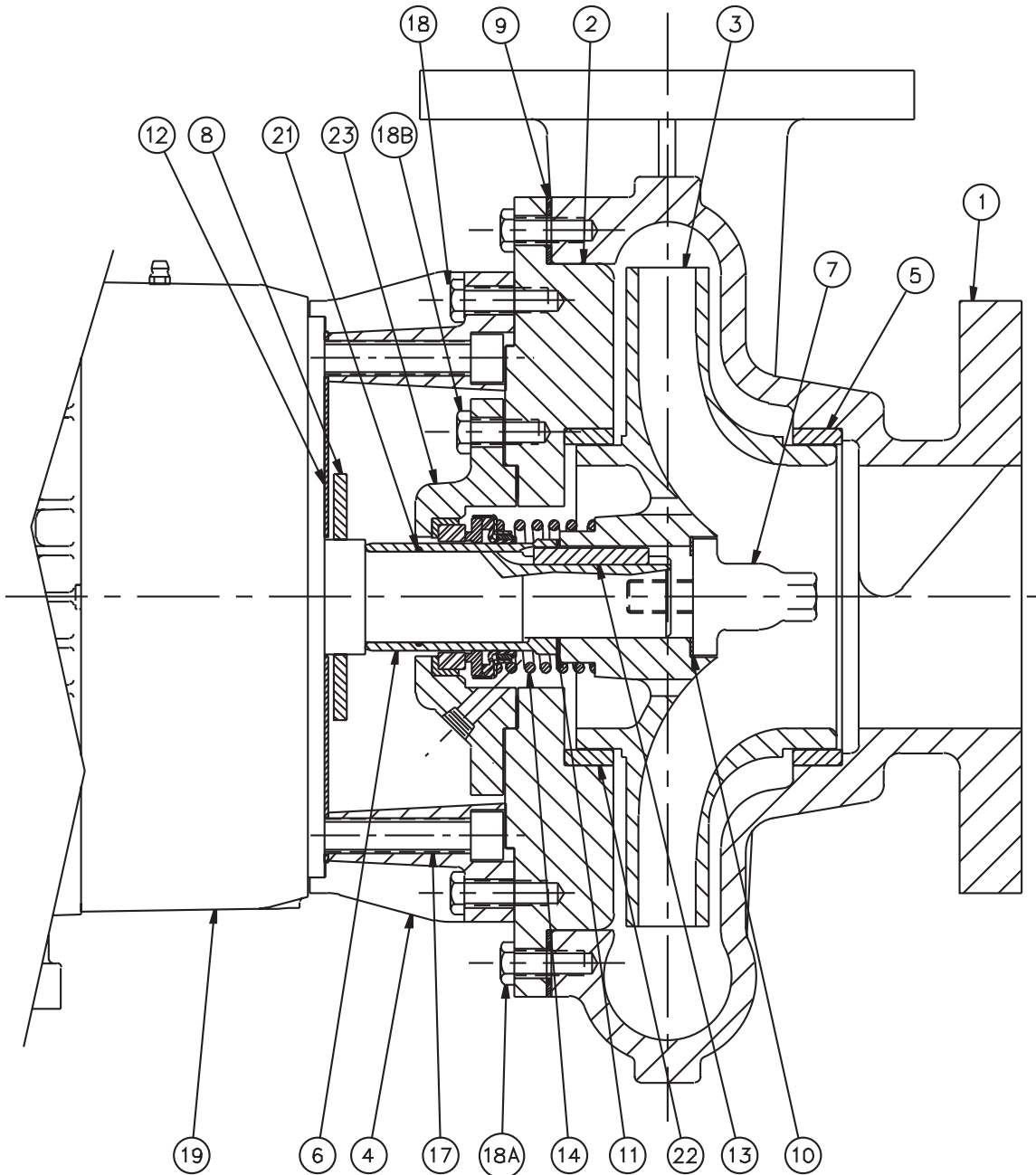

DETAIL NO.	REQ. NO.	PART NAME
24	1	STUFFING BOX GASKET
23	1	STUFFING BOX
22 <sup>3</sup>	1	WEAR RING (COVER)
21 <sup>2</sup>	1	O-RING (SHAFT/SLEEVE)
20 <sup>1</sup>	2	PIPE PLUG (OPTIONAL)
19	1	MOTOR
18B	4	CAP SCREW (COVER/STUFFING BOX)
18A	X <sup>4</sup>	CAP SCREW (CASING/COVER)
18	8	CAP SCREW (COVER/ADAPTER)
17	4	CAP SCREW (MOTOR/ADAPTER)
16 <sup>1</sup>	2	DRIVE SCREW
15 <sup>1</sup>	1	NAME PLATE
14	1	MECHANICAL SEAL
13	1	IMPELLER KEY
12	1	SPLASH PLATE
11	1	GASKET (SLEEVE/IMPELLER)
10	1	GASKET or O-RING (IMPELLER SCREW)
9	1	GASKET (CASING/COVER)
8	1	SLINGER
7	1	IMPELLER SCREW
6	1	SHAFT SLEEVE
5	1	WEAR RING (SUCTION)
4	1	ADAPTER
3	1	IMPELLER
2	1	COVER
1	1	CASING

<sup>1</sup>NOT SHOWN

<sup>2</sup>ZCH2 ONLY

<sup>3</sup>NOT ON 1 $\frac{1}{2}$ x1 $\frac{1}{2}$

<sup>4</sup>8-1 $\frac{1}{2}$ x1 $\frac{1}{2}$ , 2x2 12-3x2, 4x3L, 4x3C, 5x4

NOTE: Please be sure to always include pump type, size, and serial number with any reference to above numbers and names.